



WYATT ROAD, LONDON, N5
£1,000,000 FREEHOLD

A SPACIOUS, THREE BEDROOM FAMILY HOME IN NEED OF MODERNISATION IN HIGHBURY, N5.

Highbury | 0207 989 7000 | highbury@winkworth.co.uk



winkworth.co.uk

See things differently



DESCRIPTION:

An unmodernised, three-bedroom family home positioned on a beautiful tree lined street in Highbury, N5. Set across the ground and first floors, the property offers any buyer huge potential to extend, STPP and create a truly stunning, one of a kind forever home. Accommodation currently comprises of a spacious double reception room on the ground floor, with the rear of the property including a sizeable kitchen. Double doors in the kitchen open out into a private, east facing garden stretching 35ft. The first floor occupies three good sized double bedrooms, the master spans the full width of the front of the house, while a contemporary family bathroom is positioned in the middle. The property is completed with a downstairs wc and useful storage throughout.

Wyatt Road is located a short distance from Highbury Barn and the highly renowned local amenities, including Godfreys butchers, La Fromagerie, Da Mario's Deli, Bournes Fishmongers and Wine Rack Vintners all of which are hugely popular with locals as well as drawing those from further afield. The green spaces of Clissold Park are moments away as is the highly sought after Stoke Newington Church Street.

Upper Street is within easy reach and transport links are some of the best around with Arsenal station providing the Piccadilly line and Finsbury Park offering overground services (including the Thameslink network serving the City and Gatwick Airport) alongside direct links to Moorgate as well as underground services on the Victoria line. Numerous bus routes offer effortless transport to the City and West End whilst international links are facilitated from St Pancras.

Winkworth



Winkworth

Wyatt Road, N5
Approx. Gross Internal Floor Area 1071 sq. ft / 99.54 sq. m

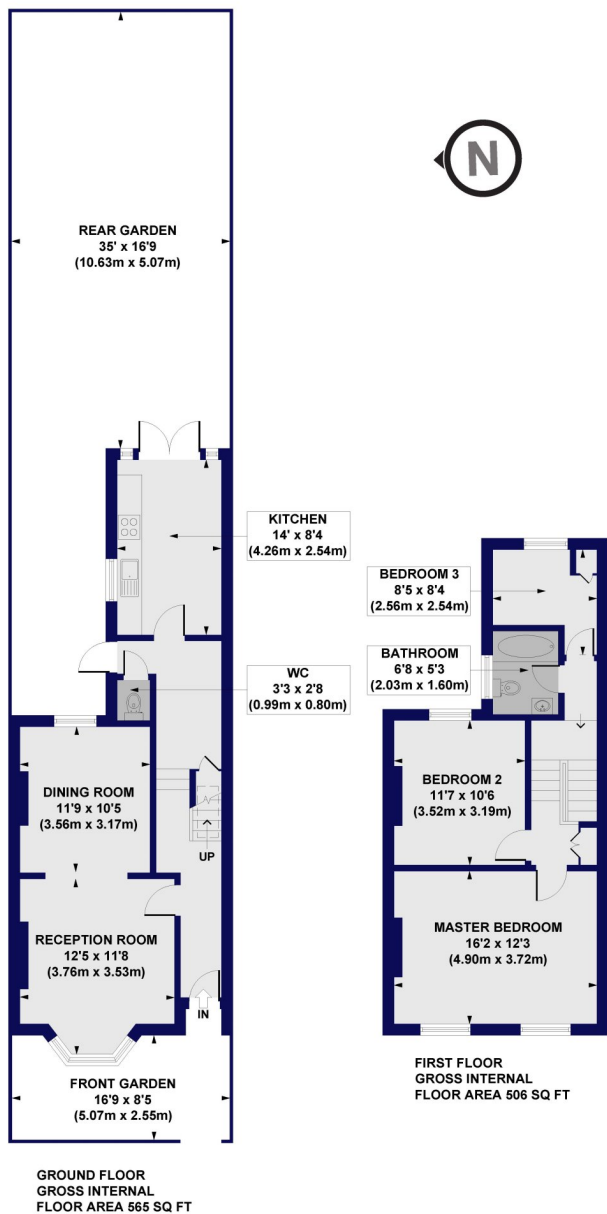

All measurements of walls, doors, windows, fittings and appliances, including their size and location, are shown as standard sizes and do not constitute any warranty or representation by the seller, their agent or CP Creative. Any intending purchaser must satisfy himself by inspection or otherwise as to the correctness of the information contained in these plans. This plan is for illustrative purposes only and should be used as such by any prospective purchasers.

Winkworth

This floorplan is for illustration purposes only and is not to scale. The position and size of doors, windows, appliances and other features are approximate.

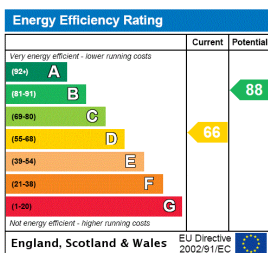

Highbury | 0207 989 7000 | highbury@winkworth.co.uk



winkworth.co.uk

See things differently

Winkworth wishes to inform prospective buyers and tenants that these particulars are a guide and act as information only. All our details are given in good faith and believed to be correct at the time of printing but they don't form part of an offer or contract. No Winkworth employee has authority to make or give any representation or warranty in relation to this property. All fixtures and fittings, whether fitted or not are deemed removable by the vendor unless stated otherwise and room sizes are measured between internal wall surfaces, including furnishings.