



WOLFSON COURT, WHETSTONE, LONDON, N20
£365,000 LEASEHOLD

A BRIGHT & SPACIOUS TWO BEDROOM, TWO BATHROOM, PENTHOUSE SET IN A MODERN GATED DEVELOPMENT.

Finchley | 020 8349 3388 | finchley@winkworth.co.uk

Winkworth

for every step...

winkworth.co.uk



Winkworth

DESCRIPTION:

We are pleased to offer this two bedroom penthouse, set within a modern gated development, within easy access to local amenities and recreational parkland, such as Oak Hill Park. This spacious flat boasts a bright and airy interior, comprising of open plan living room/kitchen, two double bedrooms and two bathrooms, (one en-suite). Further benefits include an onsite gymnasium, residents' underground parking, communal gardens and being offered on a chain free basis. An internal viewing is highly recommended!

AT A GLANCE

- Set in a gated development
- Spacious penthouse
- Two double bedrooms
- En-suite to primary bedroom
- Open plan living
- Residents' parking
- Communal grounds & gymnasium
- Offered chain free



Winkworth



Winkworth



Wolfson Court, N20

Approx. Gross Internal Floor Area 831 sq. ft / 77.28 sq. m

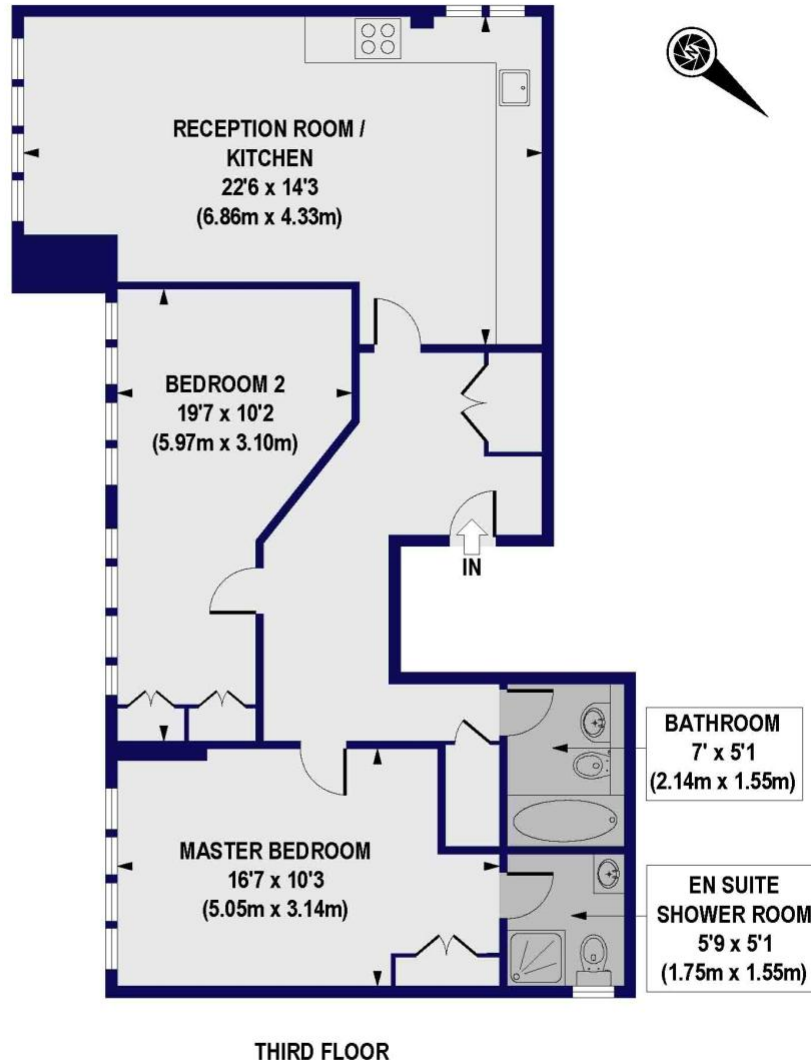

All measurements of walls, doors, windows, fittings and appliances, including their size and location, are shown as standard sizes and do not constitute any warranty or representation by the seller, their agent or CP Creative. Any intending purchaser must satisfy himself by inspection or otherwise as to the correctness of the information contained in these plans.

Winkworth

This floorplan is for illustration purposes only and is not to scale. The position and size of doors, windows, appliances and other features are approximate.

Tenure: Leasehold

Term: 136 year and 10 months

Service Charge: £2520 per annum

Ground Rent: £ 275 Annually (subject to increase)

Council Tax Band: E

Where no figures are shown, we have been unable to ascertain the information. All figures that are shown were correct at the time of printing.

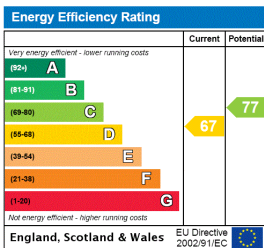

Finchley | 020 8349 3388 | finchley@winkworth.co.uk

Winkworth

for every step...

winkworth.co.uk

Winkworth wishes to inform prospective buyers and tenants that these particulars are a guide and act as information only. All our details are given in good faith and believed to be correct at the time of printing but they don't form part of an offer or contract. No Winkworth employee has authority to make or give any representation or warranty in relation to this property. All fixtures and fittings, whether fitted or not are deemed removable by the vendor unless stated otherwise and room sizes are measured between internal wall surfaces, including furnishings.