



Wimborne Road, Southend on Sea

£180,000 *Leasehold*

2  1  1 

This spacious first-floor apartment boasts two bedrooms and its own garden. The property features a kitchen/breakfast room. The property is situated in a popular area.

KEY FEATURES

- First Floor Flat
- Two Bedrooms
- Spacious Lounge
- Good Size Kitchen/Breakfast Room
- Bathroom
- Own Rear Garden



Leigh On Sea

01702 470625 | leighonsea@winkworth.co.uk

Winkworth

for every step...



With easy access to Southend High Street with its vast array of shops, restaurants and transport links with two mainline railway stations to London City, this apartment provides the perfect balance of convenience and comfort.

Don't miss out on the opportunity to make this spacious apartment your new home. Contact us today to arrange a viewing and experience all that this property has to offer.





ROOM DESCRIPTIONS

MATERIAL INFO

Tenure: Leasehold

Term: 148 years

Service Charge: £tba per annum

Ground Rent: £ tba Annually (subject to increase)

Council Tax Band: B

EPC rating: C

FIRST FLOOR

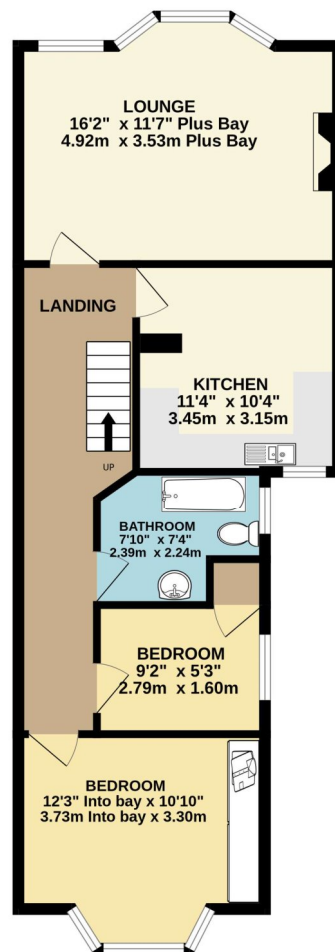

Whilst every attempt has been made to ensure the accuracy of the floorplan contained here, measurements of doors, windows, rooms and any other items are approximate and no responsibility is taken for any error, omission or mis-statement. This plan is for illustrative purposes only and should be used as such by any prospective purchaser. The services, systems and appliances shown have not been tested and no guarantee as to their operability or efficiency can be given.
Made with Metropix ©2026

Score	Energy rating	Current	Potential
92+	A		
81-91	B		
69-80	C	69 C	78 C
55-68	D		
39-54	E		
21-38	F		
1-20	G		

For more information, scan the QR code or visit the link below

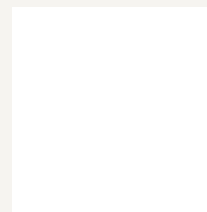

<https://www.winkworth.co.uk/sale/property/LOS250102>

Where no figures are shown, we have been unable to ascertain the information. All figures that are shown were correct at the time of printing.

Leigh On Sea

01702 470625 | leighonsea@winkworth.co.uk

Winkworth

for every step...

Winkworth wishes to inform prospective buyers and tenants that these particulars are a guide and act as information only. All our details are given in good faith and believed to be correct at the time of printing but they don't form part of an offer or contract. No Winkworth employee has authority to make or give any representation or warranty in relation to this property. All fixtures and fittings, whether fitted or not are deemed removable by the vendor unless stated otherwise and room sizes are measured between internal wall surfaces, including furnishings.