



SUTTON SQUARE, URSWICK ROAD, HACKNEY, E9
OIEO £700,000 LEASEHOLD

**A BEAUTIFUL HOUSE WITH PRIVATE AND
 COMMUNAL GARDENS IN EXCLUSIVE
 COMMUNITY!**

Hackney | 020 8986 4216 | hackney@winkworth.co.uk

Winkworth

winkworth.co.uk

See things differently



DESCRIPTION:

A DELIGHTFUL, BEAUTIFULLY presented two bedroom MODERN TOWN HOUSE forming part of this AWARD WINNING GARDEN SQUARE DEVELOPMENT in the heart of a popular CONSERVATION AREA!

Located within a sought after and secluded spot moments away from St John's Churchyard & The National Trust's Sutton House yet refreshingly close to the vast array of Cafes, Bars, restaurants and Boutiques that Hackney has to offer. The property itself is tastefully decorated, arranged over two floors and comprises a fitted kitchen with wooden worktops and separate dining room, a bright & spacious reception room which leads out onto a large private and secluded patio garden – Perfect for entertaining! The upper floor plays host to the modern fitted bathroom and two double bedrooms.

There are a number of unique factors which add to the property's allure; an ornamental pond and surrounding communal garden providing a relaxing safe place to play with the children or read a book right on your doorstep! Additionally the property looks onto the grounds of St John of Hackney Church, is in the catchment area of outstanding (OFSTED rated) nursery and primary schools and offers off street parking. Shopping and transport facilities are a stone's throw away providing swift access to the city.

Note from the owner:

"Sutton square has been our home since 2007. Our house and garden are a little oasis in the middle of Hackney. Sutton square is a lovely community and we have a beautiful communal garden and pond. On weekends we're spoiled for choice with lots of parks, dozens of local brunch spots, restaurants and cafes on our doorstep. And only a few minutes' walk to the nearest station."

Winkworth

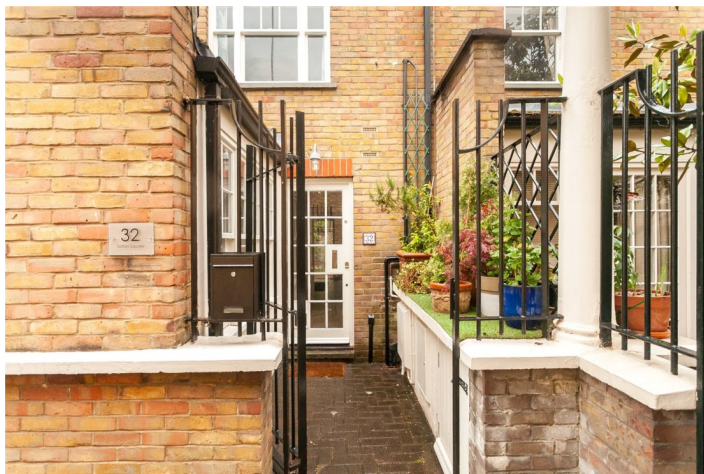

Winkworth

Sutton Square, Urswick Road, E9

Approx. Gross Internal Area 725 Sq Ft - 67.35 Sq M

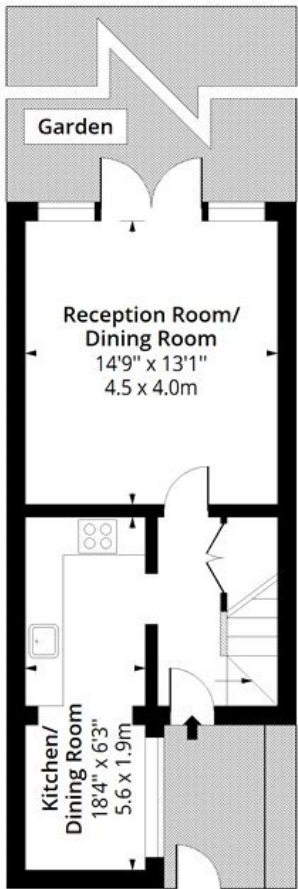

Ground Floor

Floor Area 385 Sq Ft - 35.77 Sq M



First Floor

Floor Area 340 Sq Ft - 31.59 Sq M

Floor plan is for illustrative purposes only and is not to scale. Every attempt has been made to ensure the accuracy of the floor plan shown, however all measurements, fixtures, fittings and data shown are an approximate interpretation for illustrative purposes only.

lpaplus.com

This floorplan is for illustration purposes only and is not to scale. The position and size of doors, windows, appliances and other features are approximate.

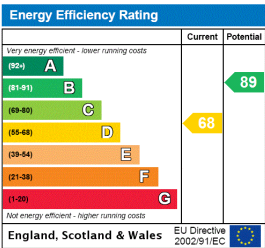

Hackney | 020 8986 4216 | hackney@winkworth.co.uk



winkworth.co.uk

See things differently

Winkworth wishes to inform prospective buyers and tenants that these particulars are a guide and act as information only. All our details are given in good faith and believed to be correct at the time of printing but they don't form part of an offer or contract. No Winkworth employee has authority to make or give any representation or warranty in relation to this property. All fixtures and fittings, whether fitted or not are deemed removable by the vendor unless stated otherwise and room sizes are measured between internal wall surfaces, including furnishings.