

NIMROD ROAD, SW16  
£285,000 LEASEHOLD

## GENEROUSLY PROPORTIONED ONE BEDROOM SECOND FLOOR FLAT

Tooting | 020 8767 5221 | [tooting@winkworth.co.uk](mailto:tooting@winkworth.co.uk)

**Winkworth**

for every step...

[winkworth.co.uk](http://winkworth.co.uk)





## **DESCRIPTION:**

A bright and spacious one-bedroom flat located in a secure residential block. This second floor property features a double bedroom, a well-appointed kitchen, a bathroom, and a large living room. It benefits from double glazing and offers ample storage throughout.

Nimrod Road in Furzedown, SW16, is a vibrant residential street with a variety of homes, ideal for families and professionals. The area boasts green spaces like Tooting Bec Common and Figges Marsh, perfect for outdoor activities, along with local shops, cafes, and restaurants that enhance the community feel. Excellent transport links via Tooting Broadway, Tooting Bec and Streatham Common stations, as well as nearby bus routes, make it highly convenient. Nimrod Road offers a desirable blend of city living and suburban charm.

Wandsworth Council Tax Band: B

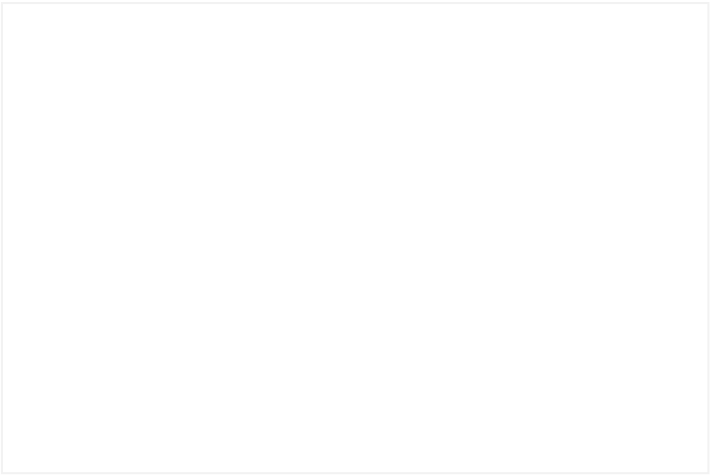
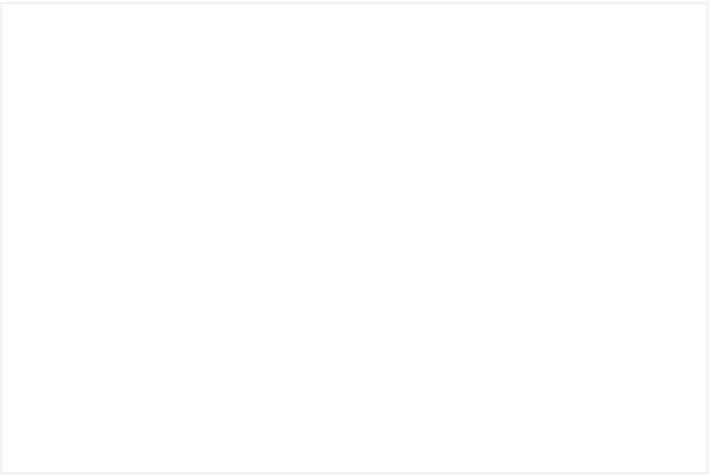



# Nimrod Road, London, SW16

Approx. Gross Internal Floor Area 480 sq. ft / 44.61 sq. m

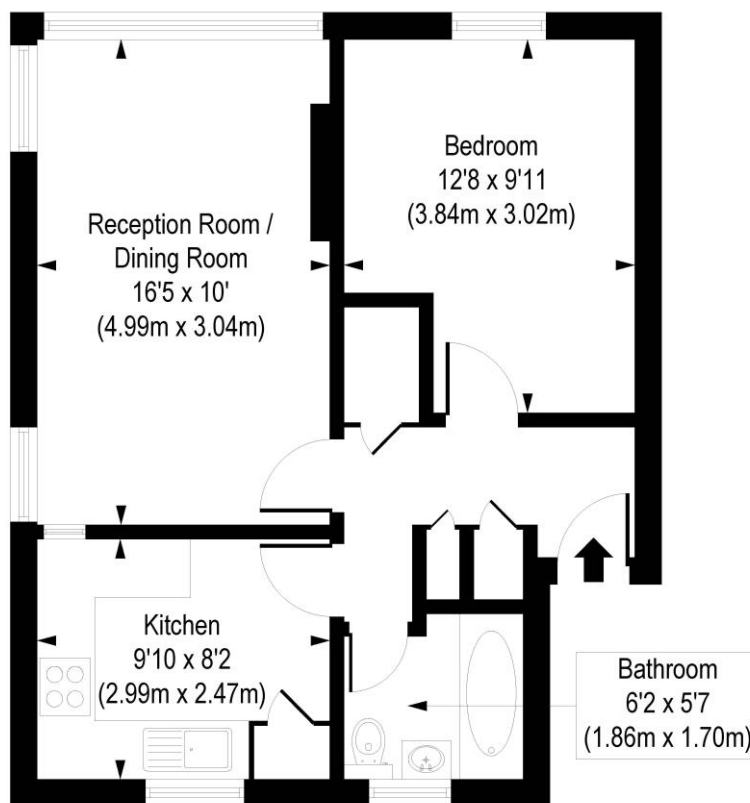

Second Floor

COMPLIANT WITH RICS CODE OF MEASURING PRACTICE. Floorplan is for illustrative purposes only and is not to scale. Every attempt has been made to ensure the accuracy of the floorplan shown, however all measurements, fixtures, fittings and data shown are an approximate interpretation for illustrative purposes only. Liability for errors, omissions or mis-statement through negligence or otherwise is hereby excluded.

This floorplan is for illustration purposes only and is not to scale. The position and size of doors, windows, appliances and other features are approximate.

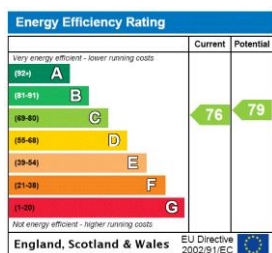

Tooting | 020 8767 5221 | tooting@winkworth.co.uk

**Winkworth**

for every step...

[winkworth.co.uk](http://winkworth.co.uk)

Winkworth wishes to inform prospective buyers and tenants that these particulars are a guide and act as information only. All our details are given in good faith and believed to be correct at the time of printing but they don't form part of an offer or contract. No Winkworth employee has authority to make or give any representation or warranty in relation to this property. All fixtures and fittings, whether fitted or not are deemed removable by the vendor unless stated otherwise and room sizes are measured between internal wall surfaces, including furnishings.