



SIR WALTER RALEIGH COURT, GREENWICH, LONDON, SE10
£460,000 LEASEHOLD

A WELL-PRESENTED THREE BEDROOM, 3RD FLOOR, APARTMENT THAT MEASURES CIRCA 947 SQ FT, AND IS PERFECTLY LOCATED JUST MOMENTS FROM THE RIVER WALK AND TOWN CENTRE. EWS1 COMPLIANT!

Greenwich | 02030533033 | greenwich@winkworth.co.uk



DESCRIPTION:

A well-presented three bedroom, 3rd floor, apartment that measures circa 947 sq ft, and is perfectly located just moments from the river walk and town centre. EWS1 compliant!

In good order throughout, the property briefly comprises a large reception room, with access onto a balcony. There are three good sized bedrooms, a family bathroom and a separate WC. The property also comes with a large 15ft fitted kitchen. Added benefits include double glazing and ample storage. The property is also vacant so therefor has no chain.

Sir Walter Raleigh Court is one of the early phases of the immensely popular River Gardens development, which is located just into east Greenwich and within a stones throw of the river. The town centre is just a short walk away, which offers a wide selection of shops and restaurant. The O2 arena, along with the Royal Park, are also close by. Your earliest viewing is highly recommended.

AT A GLANCE

- three bedroom apartment
- 3rd floor with lift
- vacant and no chain
- circa 947 sq ft
- EWS1 compliant
- balcony
- 14ft reception room
- 15ft kitchen
- moments from river walk
- close to O2





First Floor

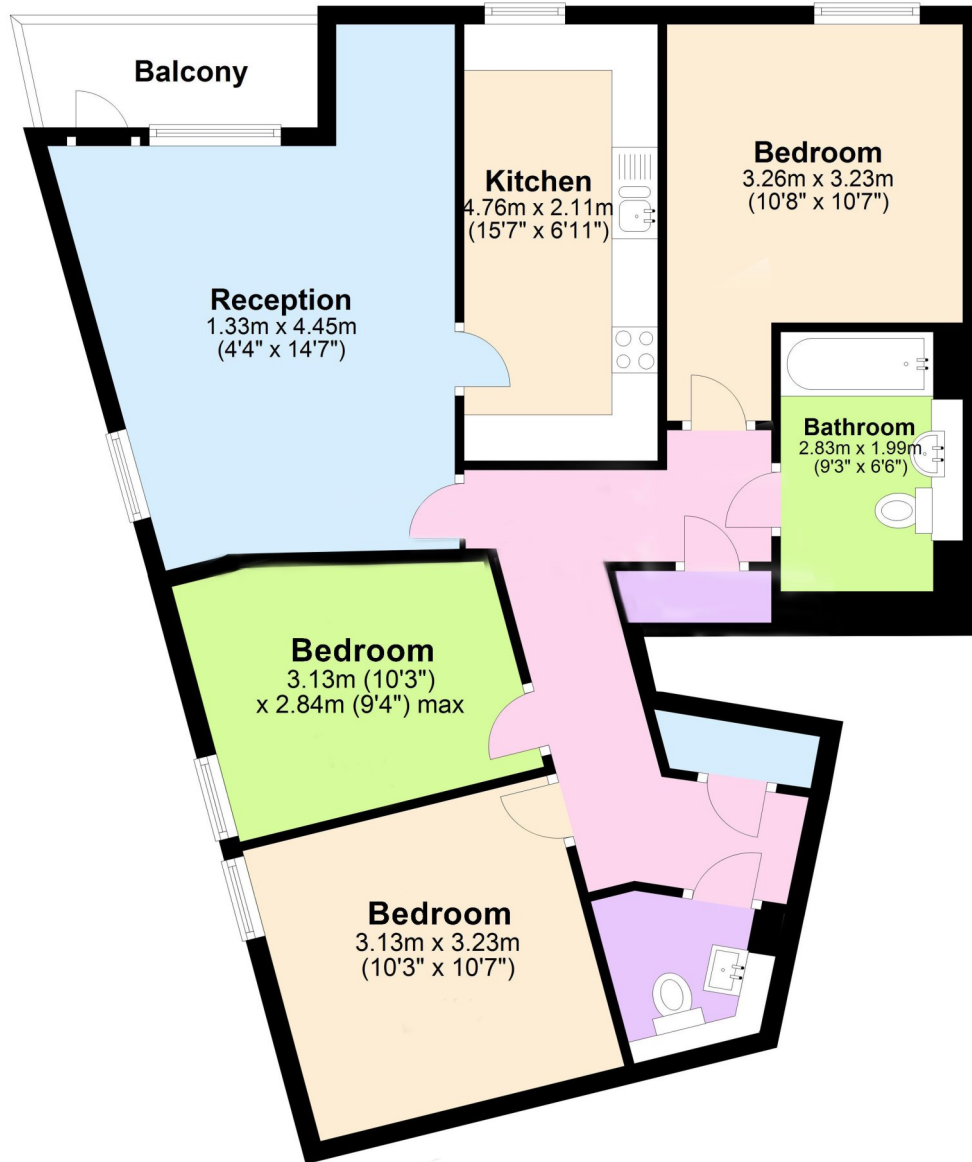

Approx : 88 sq.m. (947.2 sq.ft.)

This floorplan is for illustration purposes only and is not to scale. The position and size of doors, windows, appliances and other features are approximate.