



ELIZABETH FRY PLACE, SHOOTERS HILL, SE18 4LA
£320,000 LEASEHOLD

A SPACIOUS TWO BEDROOM, TWO BEDROOM, MODERN APARTMENT IN THIS SOUGHT AFTER DEVELOPMENT WHICH IS ENTERED VIA ELECTRONIC SECURITY GATES CLOSE TO OXLEAS WOODS WITHIN A SHORT DRIVE OR BUS JOURNEY OF BLACKHEATH STATION OR THE JUBILEE LINE AT NORTH GREENWICH.

Blackheath | 0208 8520999 | blackheath@winkworth.co.uk

Winkworth

winkworth.co.uk

See things differently



DESCRIPTION:

Found on the first floor the property is in good decorative order although with scope to enhance. The accommodation comprises a very spacious living room and a good sized kitchen with washing machine, dishwasher and fridge freezer. There is a generous master double bedroom with ensuite shower room, a second bedroom and a bathroom. The property further benefits from a recently upgraded hot water system, recently new doubled glazed windows, new electric radiators and gated off street parking. This is a great apartment and your immediate viewing is a must. Sold chain free.

Elizabeth Fry Place is a small gated development situated a 12mins bus ride to Woolwich DLR and forthcoming Crossrail and 15mins bus ride to Blackheath, Kidbrooke or Eltham train stations.

There are many parks and green open spaces to enjoy, including Hornfair Park (with the Charlton Lido, cafe, gym, tennis courts and BMX track within its bounds), Charlton House (gardens, play area and skate park), Oxleas Woods, Shrewsbury Park, Blackheath Common and Greenwich Park. Blackheath Village with its array of boutiques, shops and restaurants is 1.2 miles away.

The property is near a very handy parade of shops including a bakery, cafe, co-op, pharmacy, barbers, hairdressers/nail bar and a dry cleaners.

AT A GLANCE

- gated development
- two bedrooms
- two bathrooms
- off street parking
- first floor
- close to Oxleas Woods
- chain free





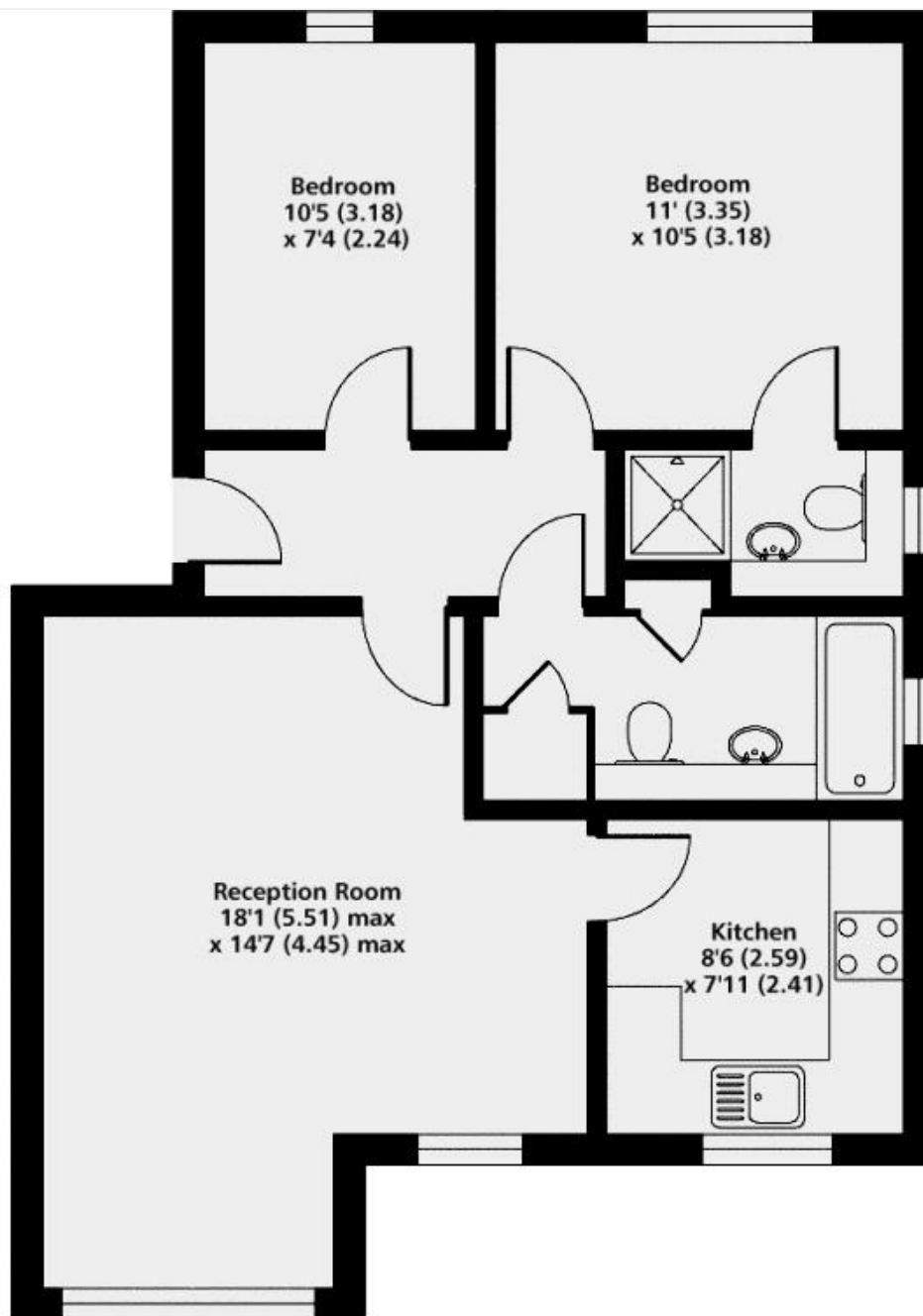

First Floor

Gross internal floor area 648 sq ft 60.2 sq metres

This floorplan is for illustration purposes only and is not to scale. The position and size of doors, windows, appliances and other features are approximate. Any lease and service charge details have been provided by the vendor. Any interest party should have these checked by a solicitor as part of the purchase process.

