



WINDSOR ROAD, NW2
£2,000 PER MONTH PART FURNISHED

WELL PRESENTED SPLIT LEVEL TWO BEDROOM APARTMENT

Kensal Rise & Queens Park | 0208 960 4947 | kensalrise@winkworth.co.uk

Winkworth

for every step...

winkworth.co.uk



DESCRIPTION:

Winkworth are delighted to offer this split level recently renovated two bedroom apartment. Comprising a bay fronted bright open plan kitchen reception will well equipped kitchen and a good size shower room with underfloor heating. The flat has two double bedrooms one on the first floor with fitted wardrobes and another on the second floor with good space for storage and two velux windows.

Additional features include hard wood flooring and under stair storage.

Offered Part Furnished / Furnished

Kitchen: Fridge, toaster, kettle, chair, x4 dining chairs, dining table, tall dresser cupboard

Hallway: Cupboard, coat stand

Downstairs bedroom: Bed, chest of drawers (inside built-in wardrobe), desk, chair

Upstairs bedroom: Bed, cupboard, wardrobe, chest of drawers, large bookshelf, full-length mirror

Council tax - Band C

Ward - Willesden Green

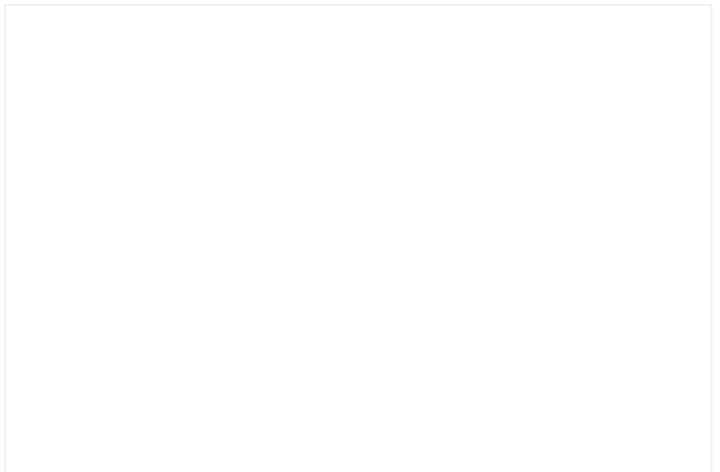
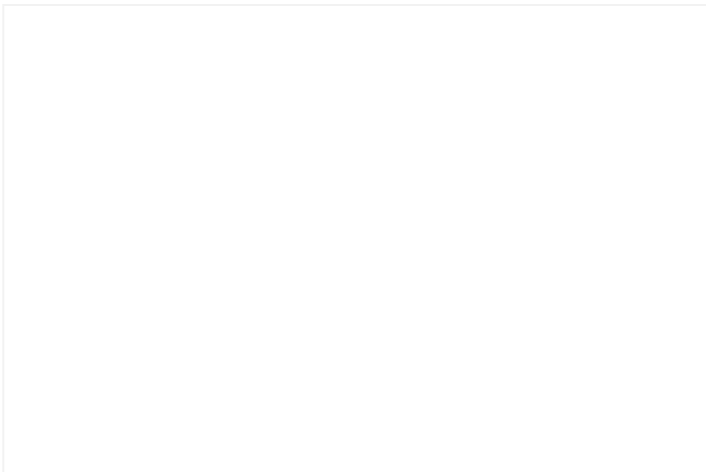

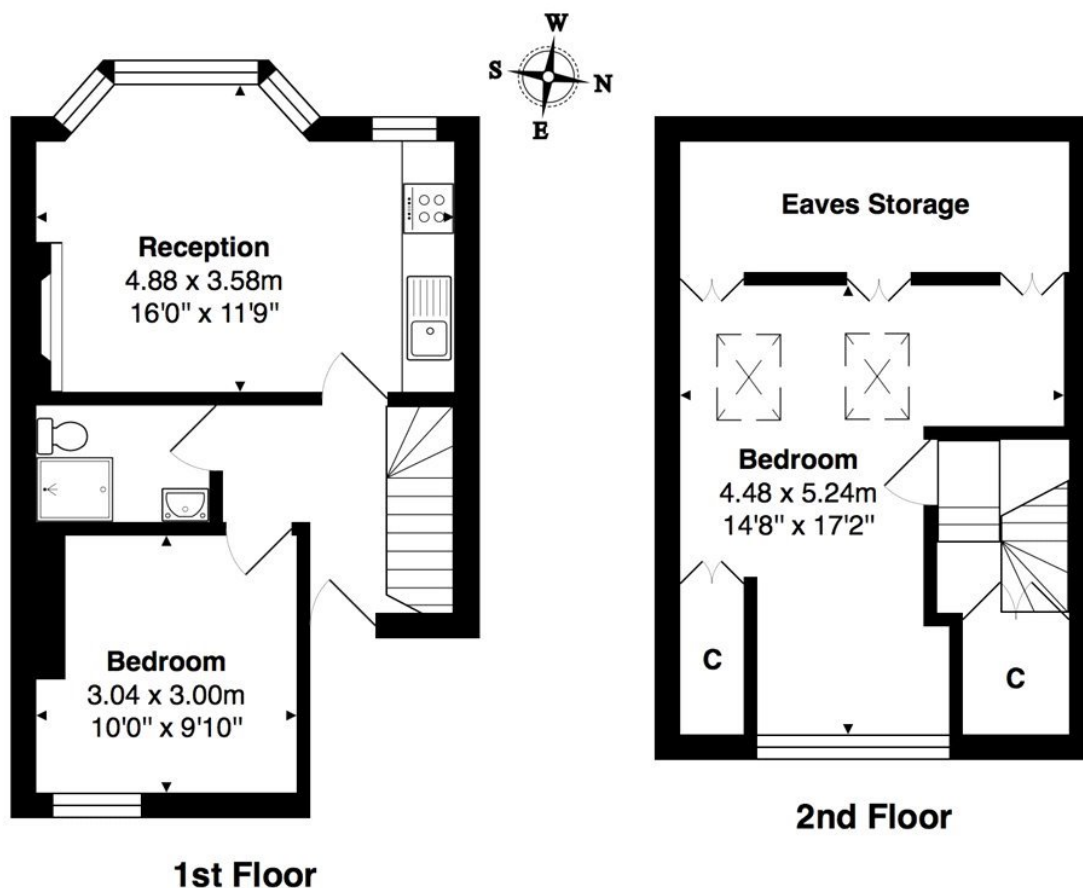

This floorplan is for illustration purposes only and is not to scale. The position and size of doors, windows, appliances and other features are approximate.

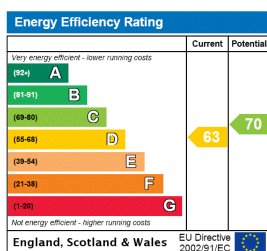

Deposit: 5 weeks rent

Holding Deposit: 1 weeks rent

Council Tax Band: C

Where no figures are shown, we have been unable to ascertain the information. All figures that are shown were correct at the time of printing.

Winkworth

for every step...

Kensal Rise & Queens Park | 0208 960 4947 | kensalrise@winkworth.co.uk

winkworth.co.uk

Winkworth wishes to inform prospective buyers and tenants that these particulars are a guide and act as information only. All our details are given in good faith and believed to be correct at the time of printing but they don't form part of an offer or contract. No Winkworth employee has authority to make or give any representation or warranty in relation to this property. All fixtures and fittings, whether fitted or not are deemed removable by the vendor unless stated otherwise and room sizes are measured between internal wall surfaces, including furnishings.