



THE GLASSWORKS, DEPTFORD, LONDON, SE8
£460,000 LEASEHOLD

A BEAUTIFULLY PRESENTED TWO BEDROOM, 6TH FLOOR, APARTMENT THAT IS PART OF THE POPULAR GLASSWORKS DEVELOPMENT NEXT TO DEPTFORD BRIDGE, MEASURING CIRCA 774 SQUARE FOOT. EWS1 COMPLIANT!

Greenwich | 02030533033 | greenwich@winkworth.co.uk

Winkworth

winkworth.co.uk

See things differently



DESCRIPTION:

A beautifully presented two bedroom, 6th floor, apartment that is part of the popular Glassworks Development next to Deptford Bridge, measuring circa 774 square foot. EWS1 compliant!

In excellent order throughout the property comprises a superb 16ft covered balcony. There is a lovely and bright 17ft kitchen lounge, two double bedrooms and two modern bathrooms. The rear bedroom has lovely views toward the city. Added benefits include a large hallway and plenty of storage. The property would make an excellent BUY TO LET investment!

The Glassworks is conveniently located just moments from Deptford Bridge DLR, but is also just a short walk to both Greenwich and Deptford town centres. This means it has access to a wide variety of shops and restaurants, and also Greenwich mainline rail and riverboat service.

AT A GLANCE

- Beautiful two bedroom apartment
- excellent condition
- Glassworks development
- circa 774 square foot
- 6th floor with lift
- large 16ft balcony
- two bathrooms
- good storage
- Moments from DLR
- close to Greenwich town centre





Fourth Floor

Approx. 71.9 sq. metres (774.3 sq. feet)

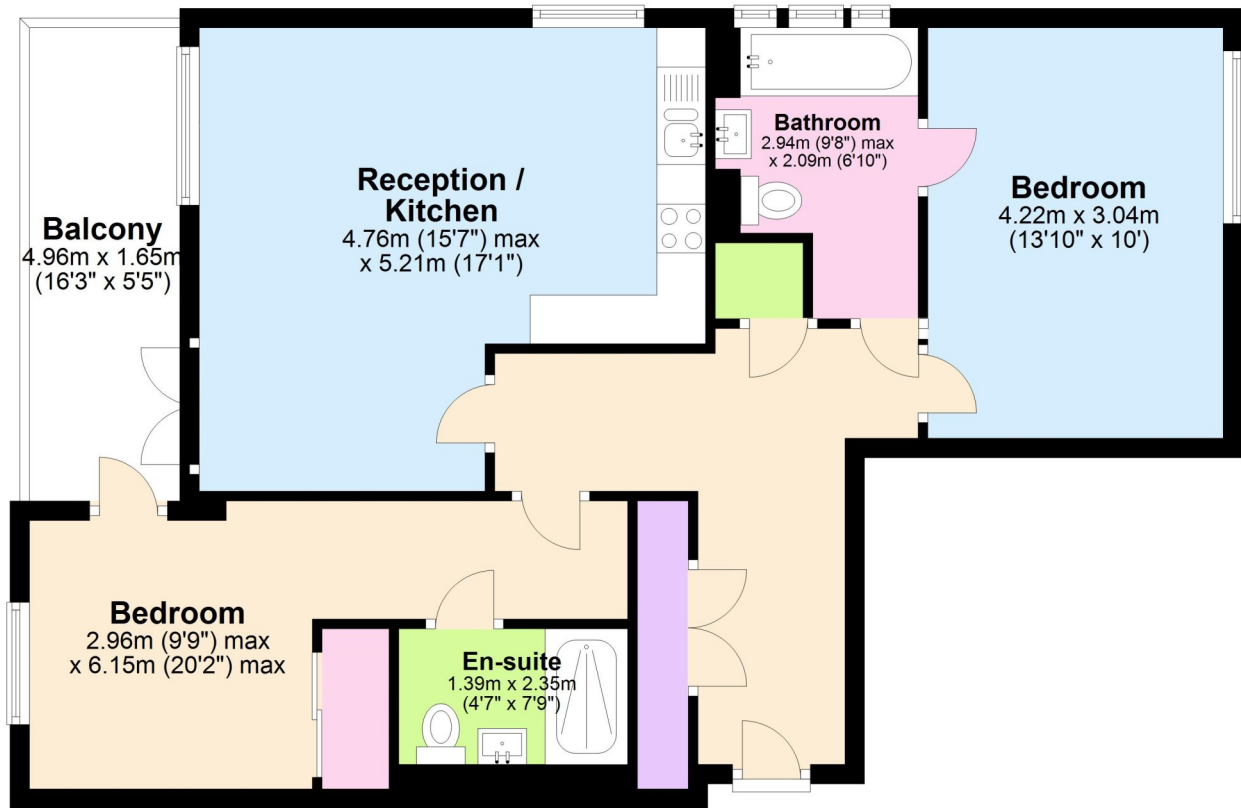

Total area: approx. 71.9 sq. metres (774.3 sq. feet)

This floorplan is for illustration purposes only and is not to scale. The position and size of doors, windows, appliances and other features are approximate.

Energy Efficiency Rating		Current	Potential
Very energy efficient - lower running costs			
(92-100)	A	87	87
(81-91)	B		
(69-80)	C		
(55-68)	D		
(39-54)	E		
(21-38)	F		
(1-20)	G		
Not energy efficient - higher running costs			
England, Scotland & Wales		EU Directive 2002/91/EC	

Greenwich | 02030533033 | greenwich@winkworth.co.uk

Winkworth

winkworth.co.uk

See things differently

Winkworth wishes to inform prospective buyers and tenants that these particulars are a guide and act as information only. All our details are given in good faith and believed to be correct at the time of printing but they don't form part of an offer or contract. No Winkworth employee has authority to make or give any representation or warranty in relation to this property. All fixtures and fittings, whether fitted or not are deemed removable by the vendor unless stated otherwise and room sizes are measured between internal wall surfaces, including furnishings.