



15 CASTLE STREET, CRANBORNE, WIMBORNE, DORSET, BH21 5PZ

PRICE GUIDE: £325,000-£350,000 FREEHOLD

CASH BUYERS ONLY – A CHARMING GRADE II LISTED 3 BEDROOM DETACHED PERIOD COTTAGE IN NEED OF COMPLETE MODERNISATION AND REFURBISHMENT, WITH DETAILED PLANNING PERMISSION TO ERECT A SUBSTANTIAL 2-STOREY EXTENSION AND A HABITABLE OUTBUILDING WITHIN THE LARGE GARDEN WHICH EXTENDS TO OVER 150FT.

SUMMARY:

The property is not habitable in its present condition, but offers great potential to create a very special home in a sought after conservation village on the fringe of the Cranborne Chase, and about 10 miles north of Wimborne.

Dating back to the 19th century, and formerly part of the Cranborne Estate, this attractive double-fronted house is of brick and cob construction, with a steep tiled roof and 2 brick chimneys. It is connected to mains electricity, water and drainage.

AT A GLANCE

- CASH BUYERS ONLY
- Derelict character property
- 150ft garden
- Planning permission for a 2-storey extension
- Central village location



DESCRIPTION:

The front door opens from the street into an entrance hallway with access under the stairs to a cellar. There is a ground floor bathroom.

The dining room has a floor-to-ceiling brick fireplace, and the living room has a tiled floor, part panelled walls and a wide inglenook fireplace (with bressummer beam and bread oven.) A step down leads to a small kitchen overlooking the rear garden, with a door to outside, and there is a utility area.

A staircase from the hall leads to the first floor landing. There are 2 double bedrooms and 1 single.

The large rear garden, which is enclosed by mixed hedges and mostly laid to grass, with an apple tree, extends to about 150ft in length, and requires landscaping.

LOCATION:

This charming conservation village has a thriving community with a GP surgery and pharmacy, a first school and nursery, a middle school, a church, a well-equipped village hall, a garden centre (with café



and gift shop), a post office/shop, a sports club and field, a children's play area, the Sheaf of Arrows, a brewery and tap room, and the popular La Fosse Restaurant. There is a limited bus service to Verwood and Ringwood.

Cranborne is situated adjacent to the famous Cranborne Chase which offers many scenic walks, about 10 miles to the north of Wimborne Minster, which provides a wide range of amenities, 4 miles to Verwood, 40 minutes' drive to Southampton, and about 18 miles from the coastal town of Poole. There is good road access to the city of Salisbury. Southampton (Airport Parkway), Poole and Salisbury have mainline rail links to London Waterloo.

COUNCIL TAX:

Band D

DIRECTIONS:

From Wimborne, proceed to Cranborne on the B3078. As you enter the village, take the first turning on the right (at the Fleur-de-Lys pub) into Castle Street. Number 15 can be found on the left hand side.



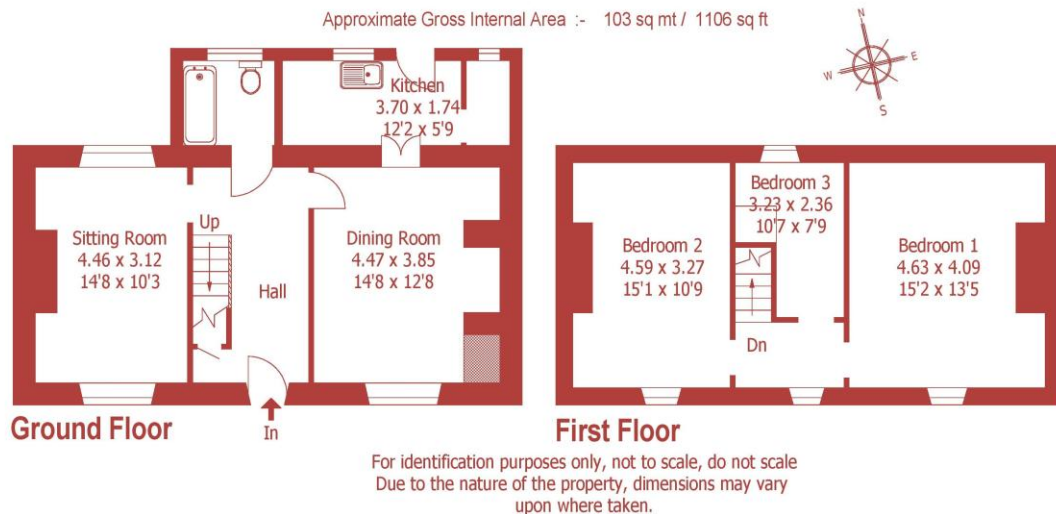

This floorplan is for illustration purposes only and is not to scale. The position and size of doors, windows, appliances and other features are approximate.

Score	Energy rating	Current	Potential
92+	A		102 A
81-91	B		
69-80	C		
55-68	D		
39-54	E	40 E	
21-38	F		
1-20	G		

DISCLAIMER: Christopher Batten wishes to inform prospective buyers that these particulars are a guide and act as information only. All our details are given in good faith and believed to be correct at the time of issue but they don't form part of an offer or contract. No employee has authority to make or give any representation or warranty in relation to this property. All fixtures and fittings, whether fitted or not are deemed removable by the vendor unless stated otherwise and room sizes are measured between internal wall surfaces, including furnishings.

Wimborne | 01202 841171 | properties@christopherbatten.com

christopherbatten.co.uk

