



Cranston Court, Bloemfontein Road, London, W12

£400,000 Leasehold

A modern one bedroom apartment with private balcony, underground parking and views over Wormholt Park.

Reception Room | Open Plan Kitchen | Bedroom | Shower Room | Balcony | 496 Sq Ft / 46 Sq M | Council Tax Band D | EPC Rating Band C

Winkworth

winkworth.co.uk

for every step...



LOCATION

Cranston Court is a popular modern development overlooking the green space of Wormholt Park. Ideally located for the array of shops, restaurants and amenities of Westfield London and those surrounding the development at TV Centre. Shepherds Bush Market (Circle, and Hammersmith & City lines) as well as Wood Lane and White City stations are the closest Underground station, with London Overground services on offer at Shepherds Bush.

DESCRIPTION

Well presented throughout, accommodation comprises entrance hall, utility room, open plan kitchen/reception room with balcony, bedroom and bathroom. The flat further benefits from a designated underground parking space.

Lease:- 215 years from 29 September 2013

Service Charge:- £2,300 p.a.

Ground Rent:- N/A





LOCAL AUTHORITY
Hammersmith & Fulham

TENURE
Leasehold 203 years 3 months.

PRICE: £400,000 Leasehold

Score	Energy rating	Current	Potential
92+	A		
81-91	B		
69-80	C	77 C	77 C
55-68	D		
39-54	E		
21-38	F		
1-20	G		

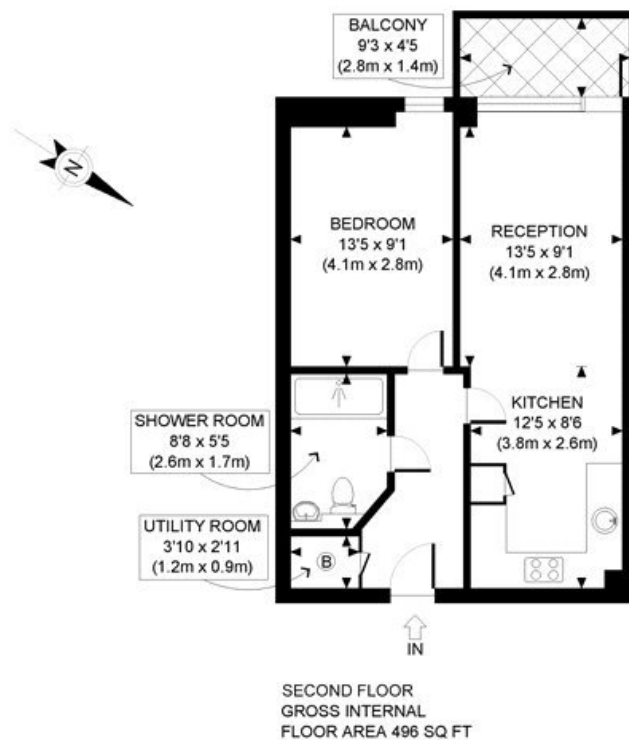

APPROX. GROSS INTERNAL FLOOR AREA: 496 SQ FT/ 46 SQM

Winkworth

CRANSTON COURT, W12

This plan is for illustrative purposes only and should be used as such by any prospective client. Whilst every attempt has been made to ensure the accuracy of the Floor Plan contained here, measurements of the doors, windows, rooms and any other items are approximate and no responsibility is taken for any errors, omissions, or misstatement. The services, systems and appliances shown have not been tested and no guarantee as to the operability or efficiency can be given.

PROPERTY PHOTO PLANS
AN ISO 9001:2015 REGISTERED BUSINESS

The displayed square footage is taken from the floor plans with measurements created using the Royal Institute of Chartered Surveyors' Code of Practice for Measuring. These measurements are approximate and included for illustrative purposes only. Winkworth does not make any representation as to the accuracy of these measurements and you should seek to verify them for yourself. Winkworth accept no liability for any loss you may suffer if you rely on these measurements.

Shepherds Bush | 020 8735 3266 | shepherdsbush@winkworth.co.uk

Winkworth

for every step...

Under the Property Misdescriptions Act 1991, these Particulars are a guide and act as information only. All details are given in good faith and are believed to be correct at time of printing. Winkworth give no representation as to their accuracy and potential purchasers or tenants must satisfy themselves by inspection or otherwise as to their correctness. No employee of Winkworth has authority to make or give any representation or warranty in relation to this property.