



Winkworth



Winkworth



Winkworth

WHITEHALL CLOSE, BOREHAMWOOD, HERTFORDSHIRE, WD6
£1,375 PER MONTH UNFURNISHED

**A LOVELY ONE BEDROOM FIRST FLOOR FLAT IS
AVAILABLE ON AN UNFURNISHED BASIS**

Borehamwood | 020 8953 8899 | borehamwood@winkworth.co.uk



DESCRIPTION:

This lovely one bedroom first floor flat is available on an unfurnished basis with immediate effect. Benefitting from a good size open plan reception with wood flooring to fitted kitchen, integrated appliances including a washer/dryer and full size dishwasher, double bedroom with fitted wardrobes and large main bathroom. With allocated parking. this great flat is situated close to both Elstree & Borehamwood Thameslink Station

ACCOMMODATION

1 Bedrooms, 1 Reception Rooms, 1 Bathrooms,
Flat/Apartment, First Floor, Off Street Parking,
Unfurnished



Approximate Gross Internal Area
43.1 sq m / 464 sq ft

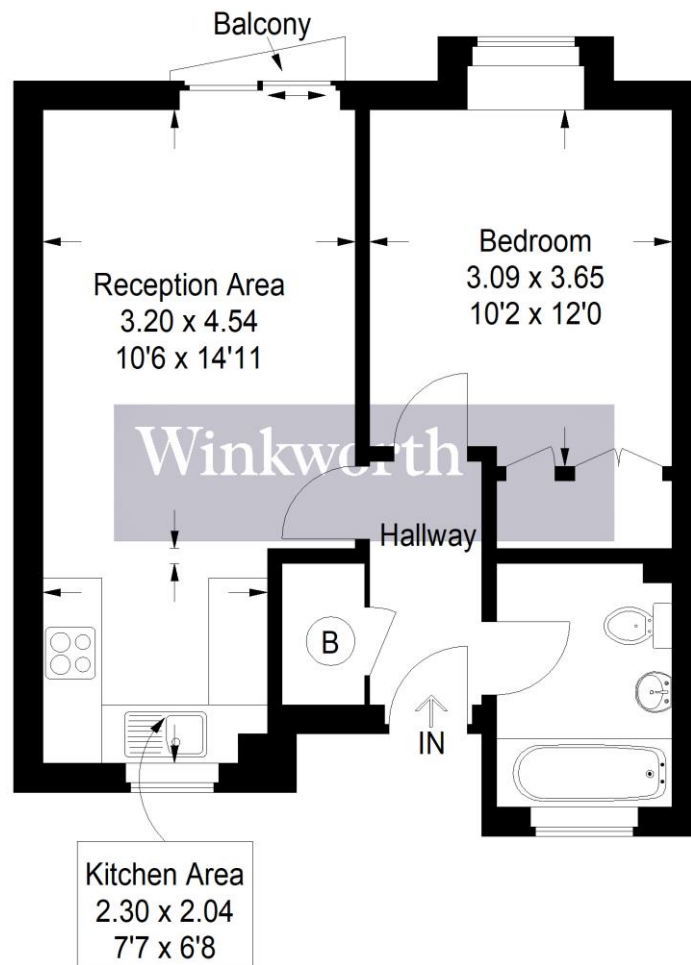

Illustration for identification purposes only, measurements are approximate,
not to scale. Winkworth © 2018 (ID506070)

This floorplan is for illustration purposes only and is not to scale. The position and size of doors, windows, appliances and other features are approximate.