



Pitt Road, Winchester, Hampshire, SO22 5SP

Winkworth

Pitt Road, Winchester, Hampshire, SO22 5SP

Superb Contemporary Home with Off Street Parking

A beautifully presented, two-bedroom, end of terrace home in this exclusive development, built by Bovis Homes in 2016. The property has been finished to a high specification throughout and is set back from the road in a peaceful location.

The spacious entrance hall, which has a generous understairs storage space and smart WC, leads to the open plan kitchen/dining room. The kitchen itself is well-appointed and bright with modern sleek units providing a good amount of cupboard space. Integrated appliances including oven, grill and hob and there is space for further freestanding appliances. The dining area has plenty of room for a table and chairs and additionally has the advantage of built-in storage. It leads through to the lovely, light sitting room with double patio doors opening onto the rear garden.

Stairs rise to the first floor where there are two double bedrooms. The principal bedroom is a very generous size, complete with built-in wardrobes, and the second bedroom is another good-sized double. There is a useful airing cupboard on the landing and a stylish, modern bathroom with bath and shower over.

To the front of the house lies a small and neat front garden and parking for one car, with a further shared space and visitor parking within Winchester Village. To the rear there is a low maintenance garden with garden shed, patio area and the rest laid to lawn. A gate provides rear access.

The property is situated in a great location with a number of easily accessible bus links, including the Park and Ride. The development includes a children's play park just a stone's throw away.





Pitt Road, Winchester, Hampshire, SO22 5SP

Pitt Road

Approximate Gross Internal Area
Total = 769 Sq Ft / 71.40 Sq M

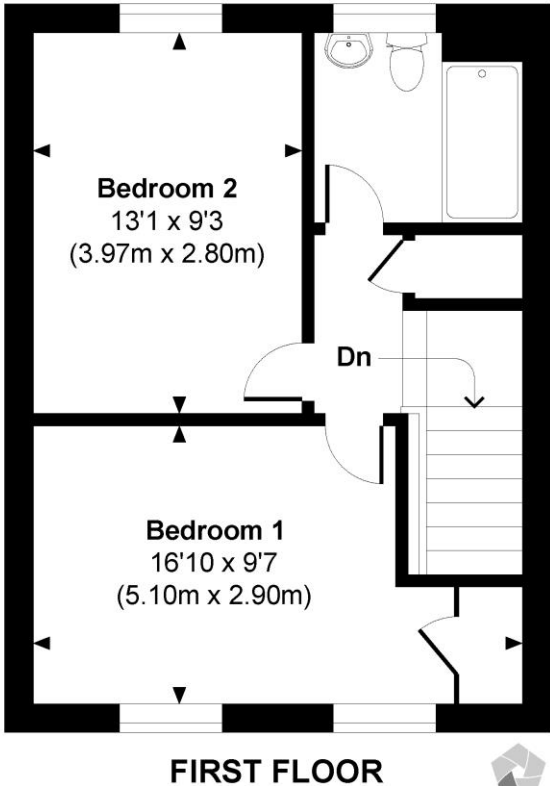
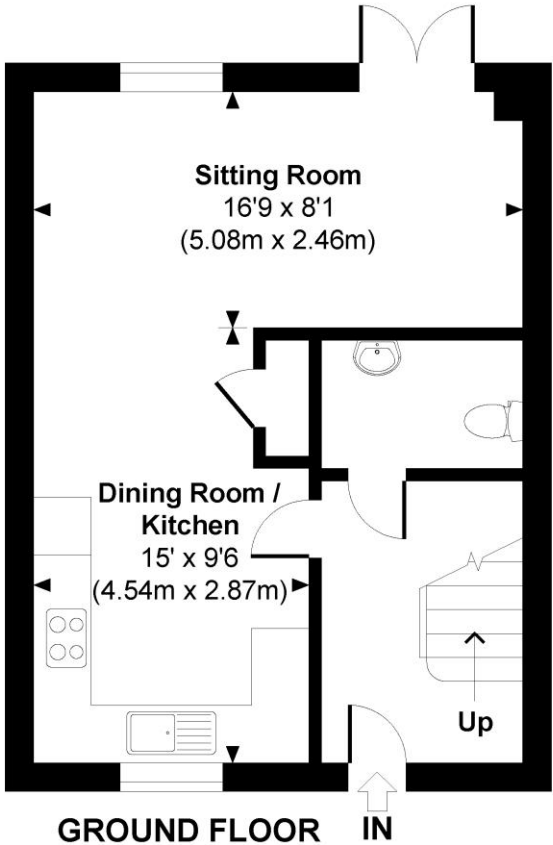

© www.propertyfocus.co | Professional Property Photography & Floorplans

This plan is for illustrative purposes only and is not to scale. If specified, the Gross Internal Area (GIA), dimensions, North point orientation and the size and placement of features are approximate and should not be relied on as a statement of fact. No guarantee is given for the GIA and no responsibility is taken for any error, omission or misrepresentation.

Directions

From our office in Southgate Street, turn left at the traffic lights onto the High Street. Proceed straight over the mini roundabout into Romsey Road and continue straight over next mini roundabout. Turn right into Pitt Road and follow the road as it bends to the left and then turns to the right. Continue along Pitt Road and turn right after house number 35. The property can be found at the end of the row of three houses on the right-hand side.

Location

The property is superbly positioned for easy access to the mainline railway station (links to London Waterloo in approximately 60 minutes), and city with its high street shops, boutiques, library, coffee shops, public houses, restaurants, theatre, cinema, museums and, of course, the city's historic cathedral. The Park & Ride to the city centre and mainline rail station is just down the road. The house is situated in the catchment for good local schools, including Kings' School. The M3 motorway, A33 and A34 are also easily accessible from this location.

Tenure: Freehold

Services

Mains gas, electricity, water and drainage

Winchester City Council

Council tax band: D

EPC rating: B

Viewings

Strictly by appointment with Winkworth Winchester Office

Winkworth.co.uk/winchester

Winkworth Winchester

2 Black Swan Buildings, Southgate Street, Winchester, SO23 9DT
01962 866 777 | winchester@winkworth.co.uk

Winkworth Country House Department

13 Charles II Street, St James's, London, SW1Y 4QU
020 7870 4878 | countryhouse@winkworth.co.uk



See things differently