



QUAKER COURT, BANNER STREET, CLERKENWELL, LONDON, EC1Y
£675,000 LEASEHOLD

**A SPACIOUS AND BRIGHT THREE BEDROOM MAISONETTE IN
QUAKER COURT TWO MINUTES FROM OLD STREET
ROUNDBABOUT.**

173 Year Lease | Service Charge: £2,023 | Ground Rent: £10

Clerkenwell | 020 7405 1288 | clerkenwell@winkworth.co.uk

Winkworth

for every step...

winkworth.co.uk



DESCRIPTION:

On the lower level the property comprises of a spacious living room leading out onto a spacious and sunny private south facing patio garden and a fully fitted separate kitchen; on the upper floor there are two double bedrooms, a single bedroom, and a family bathroom with plenty of storage throughout. Banner street is ideally located within a short walk of the City, Old street, Hoxton and Farringdon. The popular Whitecross Street food market is also close by and the West end is easily accessible via the many bus routes passing by.



Winkworth

for every step...



Winkworth

for every step...

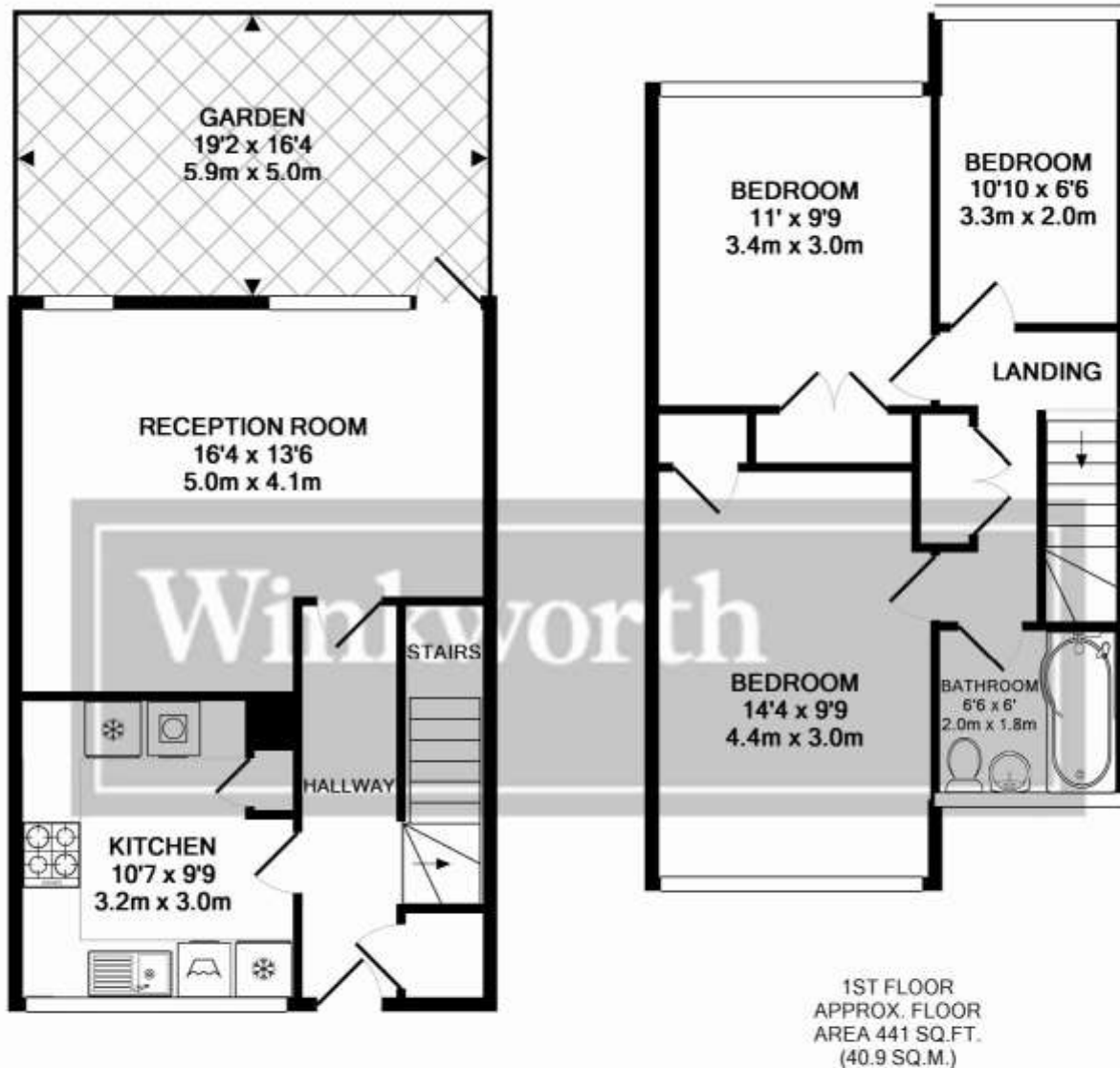

QUAKER COURT, BANNER STREET, LONDON, EC1Y
TOTAL APPROX. FLOOR AREA 830 SQ.FT. (77.1 SQ.M.)

Whilst every attempt has been made to ensure the accuracy of the floor plan contained here, measurements of doors, windows, rooms and any other items are approximate and no responsibility is taken for any error, omission, or mis-statement. This plan is for illustrative purposes only and should be used as such by any prospective purchaser. The services, systems and appliances shown have not been tested and no guarantee as to their operability or efficiency can be given.
Made with Metropix ©2015

This floorplan is for illustration purposes only and is not to scale. The position and size of doors, windows, appliances and other features are approximate.

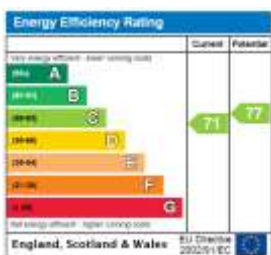

Tenure: Leasehold
Term: Expires - 04/03/2197
Service Charge: £2,023 per annum
Ground Rent: £10
Council Tax Band: TBC

Where no figures are shown, we have been unable to ascertain the information. All figures that are shown were correct at the time of printing.



for every step...

Clerkenwell | 020 7405 1288 | clerkenwell@winkworth.co.uk

winkworth.co.uk

Winkworth wishes to inform prospective buyers and tenants that these particulars are a guide and act as information only. All our details are given in good faith and believed to be correct at the time of printing but they don't form part of an offer or contract. No Winkworth employee has authority to make or give any representation or warranty in relation to this property. All fixtures and fittings, whether fitted or not are deemed removable by the vendor unless stated otherwise and room sizes are measured between internal wall surfaces, including furnishings.