



MANOR WAY, HERTFORDSHIRE, WD6

£275,000 LEASEHOLD

A CHAIN FREE TWO BEDROOM DUPLEX APARTMENT WITH BALCONY

Borehamwood | 020 8953 8899 | borehamwood@winkworth.co.uk



DESCRIPTION:

Located a stone's throw away from Manor way shops and Ripon Park, on the South side of Borehamwood is this bright and spacious two bedroom duplex apartment with a Westerly facing balcony. Property also has the benefit of a garage and private section of garden.

Bus routes including the 292 run nearby and amongst other locations, provide access to Elstree and Borehamwood Thameslink station and Edgware Northern Line station.

Offered for sale "Chain Free" the property would be an ideal purchase

AT A GLANCE

- 2 Bedrooms
- Entrance Hall
- Kitchen
- Reception Room
- Bathroom





Approximate Gross Internal Area = 66.6 sq m / 717 sq ft
(Excluding Store)

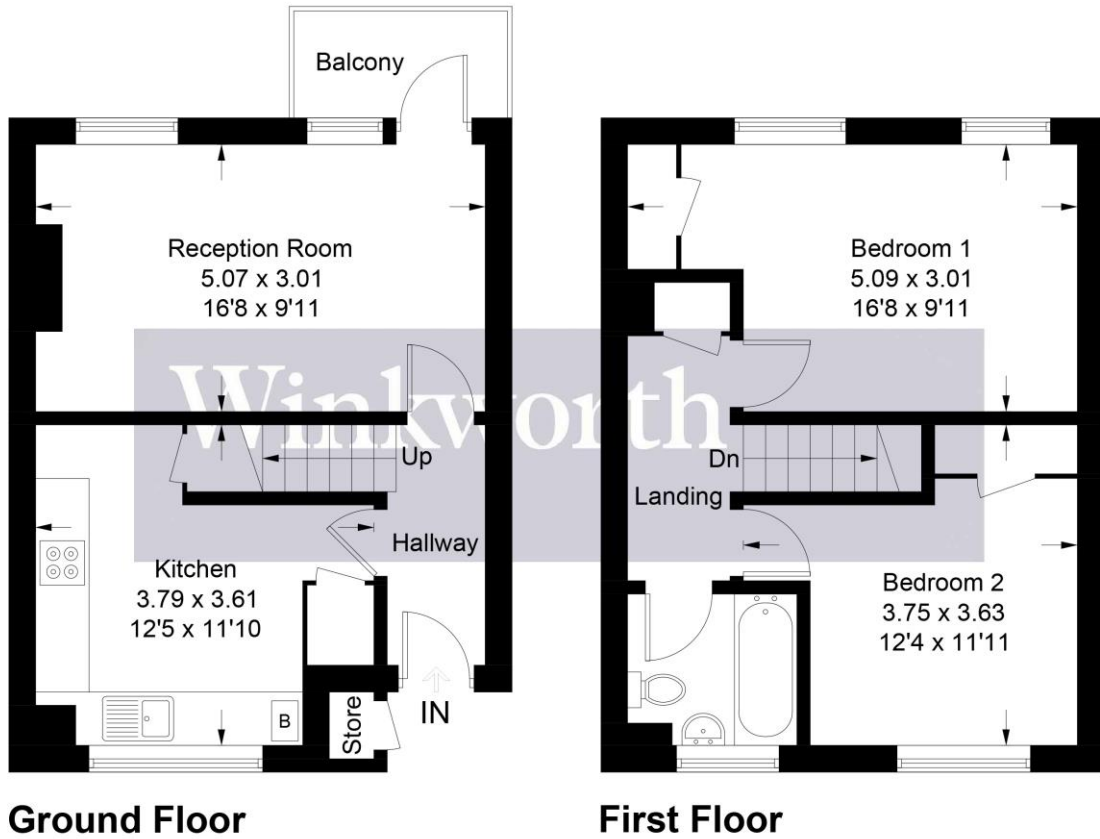
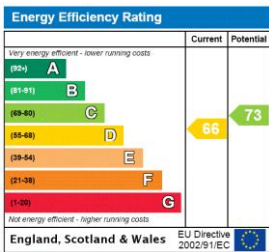

Illustration for identification purposes only, measurements are approximate, not to scale. Winkworth © 2024 (ID1066133)

This floorplan is for illustration purposes only and is not to scale. The position and size of doors, windows, appliances and other features are approximate.



Tenure: Leasehold
Term: Expires - 24/12/2147
Service Charge: £0 per annum
Ground Rent: £ 0 Annually (subject to increase)
Council Tax Band: B

Where no figures are shown, we have been unable to ascertain the information. All figures that are shown were correct at the time of printing.