



FLAT 4, WALDRAM PARK ROAD, LONDON, UNITED KINGDOM, SE23
£375,000 LEASEHOLD

STUNNING ONE BEDROOM APARTMENT

Forest Hill | | foresthill@winkworth.co.uk



DESCRIPTION:

Stylish one-bedroom apartment in the centre of Forest Hill. Stunning open plan kitchen/ reception with south facing private balcony, off-street parking and a long lease.





Waldram Park Road, London, SE23

Approximate Area = 584 sq ft / 54.2 sq m

For identification only - Not to scale

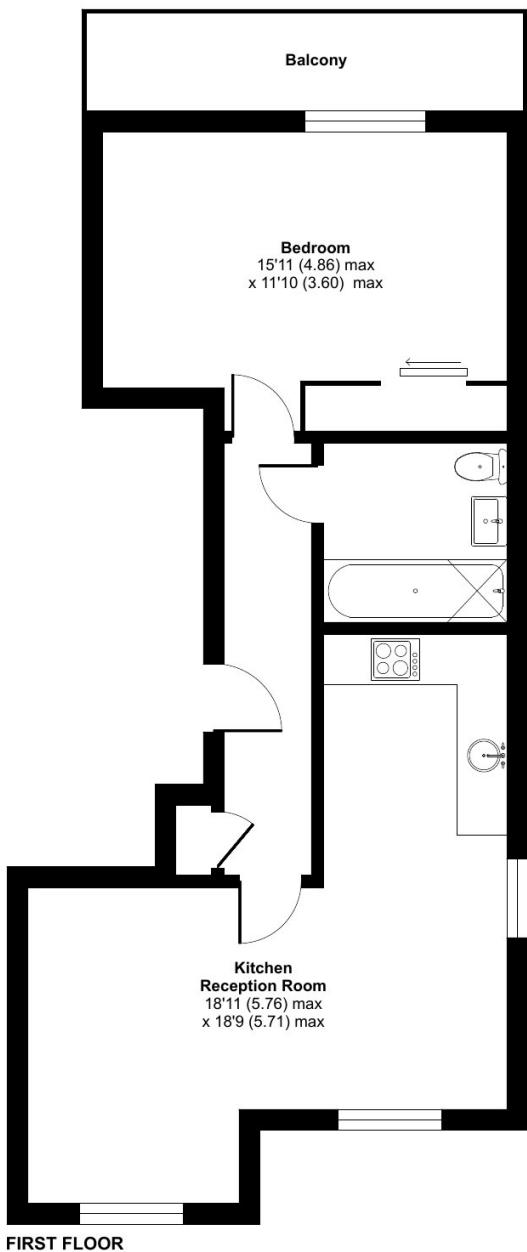

Floor plan produced in accordance with RICS Property Measurement Standards incorporating International Property Measurement Standards (IPMS2 Residential). © nlc/ecom 2025. Produced for Winkworth Forest Hill and New Cross. REF: 1296156

This floorplan is for illustration purposes only and is not to scale. The position and size of doors, windows, appliances and other features are approximate.

Score	Energy rating	Current	Potential
92+	A		
81-91	B		
69-80	C	80 C	80 C
55-68	D		
39-54	E		
21-38	F		
1-20	G		

Tenure: Leasehold

Term: 114 year and 0 months

Service Charge: £2564 per annum

Ground Rent: £275 Annually (subject to increase)

Where no figures are shown, we have been unable to ascertain the information. All figures that are shown were correct at the time of printing.