



**SILVESTER ROAD, EAST DULWICH, SE22  
OFFERS OVER £500,000 LEASEHOLD**

**A LARGE SPLIT-LEVEL FLAT, SITUATED ON A  
PRIME CENTRAL ROAD IN SE22.**

Dulwich | 020 8299 2722 | [dulwich@winkworth.co.uk](mailto:dulwich@winkworth.co.uk)

**Winkworth**

[winkworth.co.uk](http://winkworth.co.uk)

See things differently



## DESCRIPTION:

A large split level flat, situated on a prime central road in SE22. This large, bright and spacious flat is situated on Silvester Road known for being a lovely, family tree lined road a stone's throw from the hustle and bustle of Lordship. The property comprises two large double bedrooms with high ceilings, a large reception with sash windows and a separate full fitted, modern kitchen. The property is located amongst some of the most sought-after roads in the area, allowing easy access to Lordship Lane for its fantastic array of shops, bars and restaurants. Moments away from Dulwich Park, Peckham Rye Park and Goose Green and also within easy access to direct trains to London Bridge from East Dulwich station or the overground at Denmark Hill.

## AT A GLANCE

- Two Double Bedrooms
- Victorian Conversion
- Large Reception Room
- Kitchen-Diner
- Modern Bathroom
- Central Location



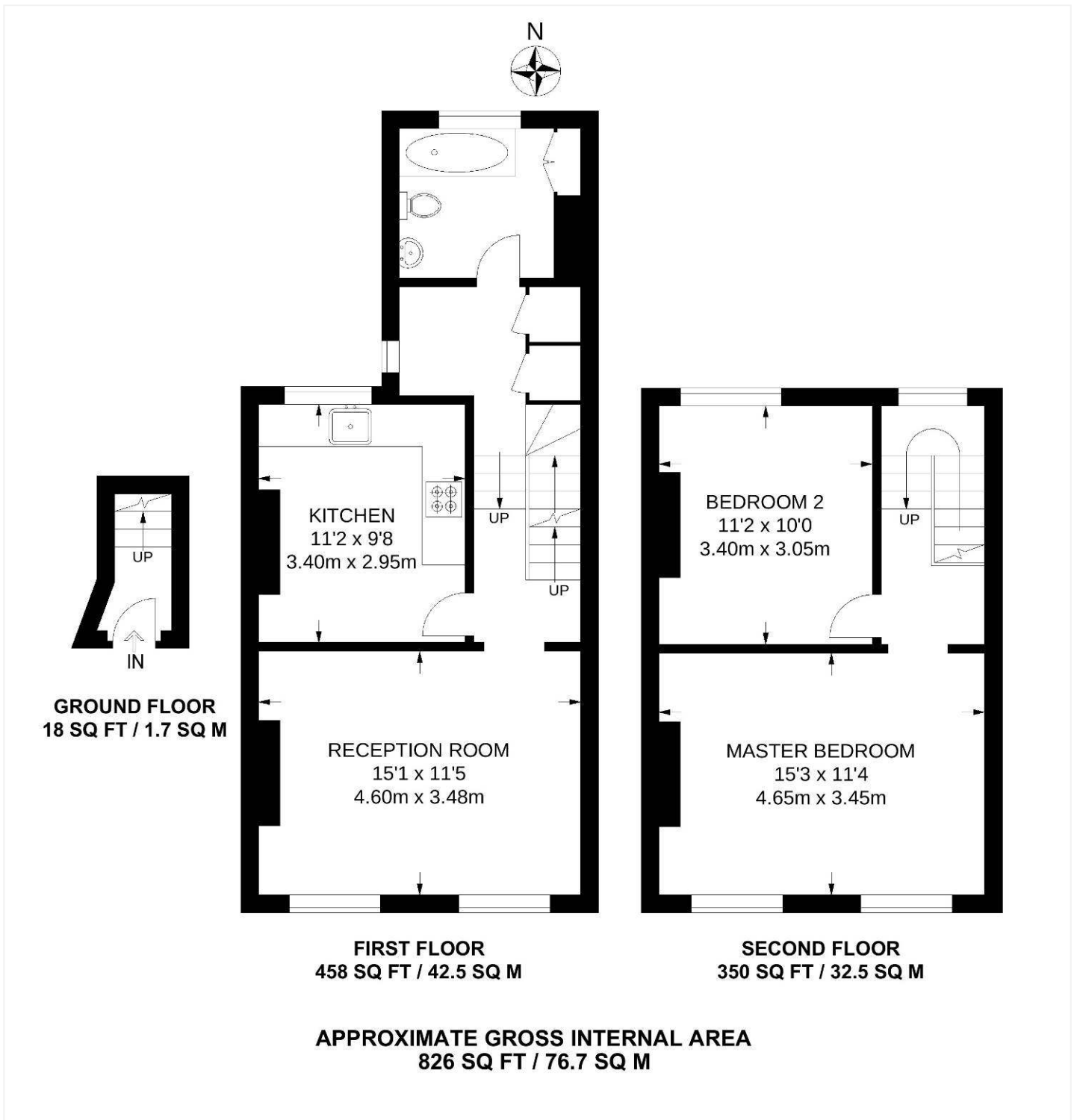

This floorplan is for illustration purposes only and is not to scale. The position and size of doors, windows, appliances and other features are approximate.

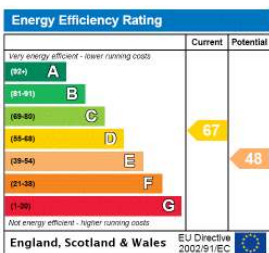

Dulwich | 020 8299 2722 | dulwich@winkworth.co.uk



winkworth.co.uk

See things differently

Winkworth wishes to inform prospective buyers and tenants that these particulars are a guide and act as information only. All our details are given in good faith and believed to be correct at the time of printing but they don't form part of an offer or contract. No Winkworth employee has authority to make or give any representation or warranty in relation to this property. All fixtures and fittings, whether fitted or not are deemed removable by the vendor unless stated otherwise and room sizes are measured between internal wall surfaces, including furnishings.