

**PENNINGTON DRIVE, N21**  
**£260,000 LEASEHOLD**

**A SPACIOUS TWO-BEDROOM APARTMENT LOCATED IN THE POPULAR HIGHLANDS VILLAGE, REQUIRING MODERNISATION THROUGHOUT.**

Palmers Green | 020 8920 9900 | [palmersgreen@winkworth.co.uk](mailto:palmersgreen@winkworth.co.uk)

**Winkworth**

for every step...

*[winkworth.co.uk](http://winkworth.co.uk)*





## DESCRIPTION:

A two-bedroom apartment requiring modernisation and offered for sale chain-free. The property is situated on the first floor of a Victorian conversion in the popular Highlands Village, within easy reach of the highly regarded Eversley and Grange Park Primary Schools, as well as Highlands Secondary School. There is also a Sainsbury's superstore, pharmacy, nursery, and a bus service to Oakwood tube station (Piccadilly Line) nearby. The property would be ideal for an investor or a first-time buyer looking for a home they can personalise. Offered for sale with no onward chain, new 125-year lease on completion, and no ground rent premium.

**Tenure:** Leasehold

**Term:** New 125-year lease granted on completion

**Service Charge:** £1378.95 per annum

**Ground Rent:** £0

**Council Tax:** London Borough of Enfield – Band C





**Asbury Court, Pennington Drive, N21**  
 Approx. Gross Internal Floor Area 534 sq. ft / 49.57 sq. m

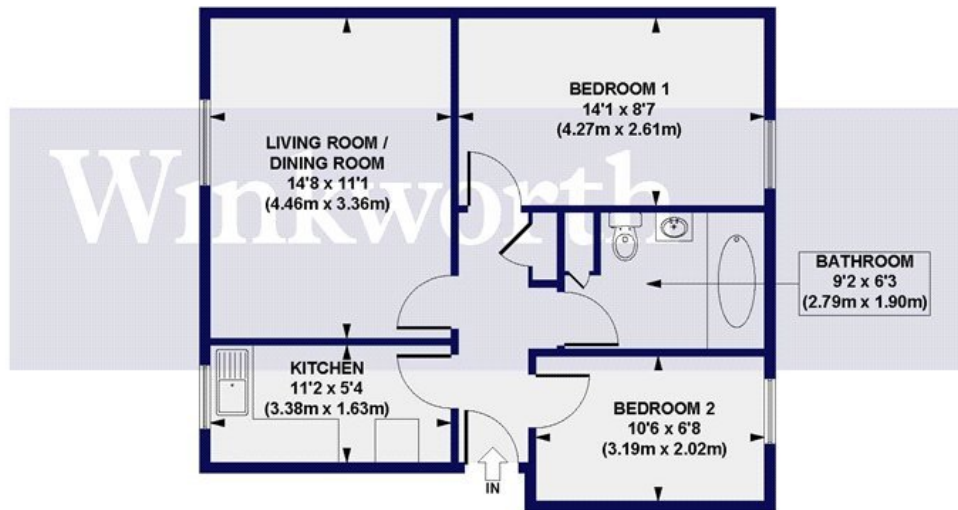

FIRST FLOOR

All measurements of walls, doors, windows, fittings and appliances, including their size and location, are shown as standard sizes and do not constitute any warranty or representation by the seller, their agent or CP Creative. Any intending purchaser must satisfy himself by inspection or otherwise as to the correctness of the information contained in these plans.

This floorplan is for illustration purposes only and is not to scale. The position and size of doors, windows, appliances and other features are approximate.

Score	Energy rating	Current	Potential
92+	A		
81-91	B		
69-80	C	74 C	78 C
55-68	D		
39-54	E		
21-38	F		
1-20	G		

Palmers Green | 020 8920 9900 | [palmersgreen@winkworth.co.uk](mailto:palmersgreen@winkworth.co.uk)

**Winkworth**

for every step...

[winkworth.co.uk](http://winkworth.co.uk)

Winkworth wishes to inform prospective buyers and tenants that these particulars are a guide and act as information only. All our details are given in good faith and believed to be correct at the time of printing but they don't form part of an offer or contract. No Winkworth employee has authority to make or give any representation or warranty in relation to this property. All fixtures and fittings, whether fitted or not are deemed removable by the vendor unless stated otherwise and room sizes are measured between internal wall surfaces, including furnishings.