



Arthur Court, W2

£650 per week (£2,816.66 PCM) *Furnished*



A RARE OPPORTUNITY TO RENT THIS LARGER THAN AVERAGE ONE BEDROOM APARTMENT ON THE FIRST FLOOR IN THIS POPULAR MANSION BLOCK TO THE NORTH OF QUEENSWAY



Notting Hill Lettings

0207 727 3227 | nottinghill@winkworth.co.uk

Winkworth

for every step...



A rare opportunity to rent this larger than average one bedroom apartment on the first floor in this popular mansion block to the north of Queensway nestled amongst all the restaurants and shops and fantastic transport links the area has to offer. Located to the back of the property, the property benefits from a spacious hallway leading straight on to a fantastic open plan living room with wood floors, fully fitted open plan kitchen with breakfast bar, spacious double bedroom with good storage and bathroom with shower over bath.

The property further benefits from heating in a hot water included in the rent and is offered on a furnished or part furnished basis.

Arthur court is an exceptionally convenient location with a vast array of shops and restaurants on and around Queensway seconds away, a short walk from Queensway, Bayswater and Royal Oak Tube Stations and within walking distance of Paddington Railway and the Heathrow Express too.

Utilities:

Electricity – Mains

Water – Mains

Sewerage – Mains

Heating – Communal

Broadband <https://checker.ofcom.org.uk/en-gb/broadband-coverage>

Mobile Coverage <https://checker.ofcom.org.uk/en-gb/mobile-coverage>

MATERIAL INFO

Deposit: £3,250

Holding Deposit: £650

Council Tax Band: D (Westminster)





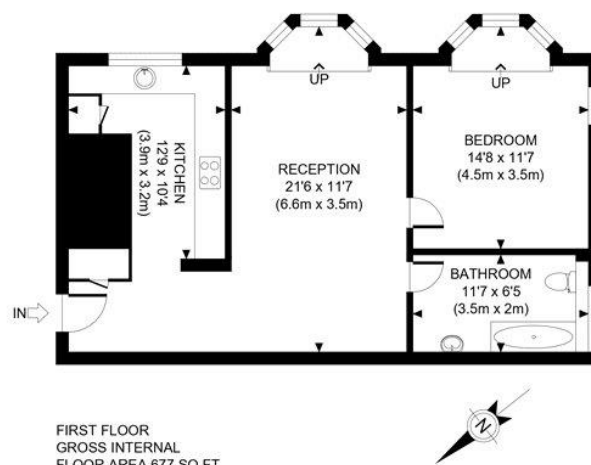

APPROX. GROSS INTERNAL FLOOR AREA: 677 SQ FT/ 63 SQM

Winkworth

This plan is for illustrative purposes only and should be used as such by any prospective client. Whilst every attempt has been made to ensure the accuracy of the Floor Plan contained here, measurements of the doors, windows, rooms and any other items are approximate and no responsibility is taken for any errors, omissions, or misstatement. The services, systems and appliances shown have not been tested and no guarantee as to the operability or efficiency can be given.

PROPERTY PHOTO PLANS COOK

Score	Energy rating	Current	Potential
92+	A		
81-91	B		
69-80	C		77 C
55-68	D	64 D	
39-54	E		
21-38	F		
1-20	G		

For more information, scan the QR code or visit the link below

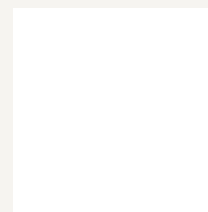

<https://www.winkworth.co.uk/rent/property/NHS250115>

Where no figures are shown, we have been unable to ascertain the information. All figures that are shown were correct at the time of printing.

Notting Hill Lettings

0207 727 3227 | nottinghill@winkworth.co.uk

Winkworth

for every step...

Winkworth wishes to inform prospective buyers and tenants that these particulars are a guide and act as information only. All our details are given in good faith and believed to be correct at the time of printing but they don't form part of an offer or contract. No Winkworth employee has authority to make or give any representation or warranty in relation to this property. All fixtures and fittings, whether fitted or not are deemed removable by the vendor unless stated otherwise and room sizes are measured between internal wall surfaces, including furnishings.