

LARIAT APARTMENTS, GREENWICH, LONDON, SE10
£550,000 - £575,000 LEASEHOLD

WE ARE PLEASED TO OFFER THIS STUNNING GROUND FLOOR MODERN APARTMENT, THAT MEASURES CIRCA 787 SQUARE FOOT AND FEATURES RIVER VIEWS AND TWO LARGE PRIVATE TERRACES. EWS1 COMPLIANT!

Greenwich | 02030533033 | greenwich@winkworth.co.uk

Winkworth

DESCRIPTION:

We are pleased to offer this stunning ground floor modern apartment, that measures circa 787 square foot and features river views and two large private terraces. EWS1 COMPLIANT!

In excellent order throughout, the property briefly comprises of a wonderful 21ft kitchen living room, which features hard wood flooring . This in turn leads onto the front private terrace, which has communal gardens beyond. There are then two large double bedrooms, with fitted wardrobes, which also lead to a larger terrace to the rear that has views of the river and quick access onto the river walkway. Along with two extremely well presented bathrooms, there is ample storage off the entrance hallway. The development offers a 24 hour concierge service and a communal gymnasium and nursery onsite.

Enderby Wharf is an incredibly popular riverside development that sits at the foot of the Peninsula. As mentioned it runs alongside the river walk and is only a short walk away from the town centre, which offers a wide array of shops and restaurants, along with mainline rail, DLR and riverboat service. The Royal Park is also close by, as is the O2 arena with Jubilee Line.

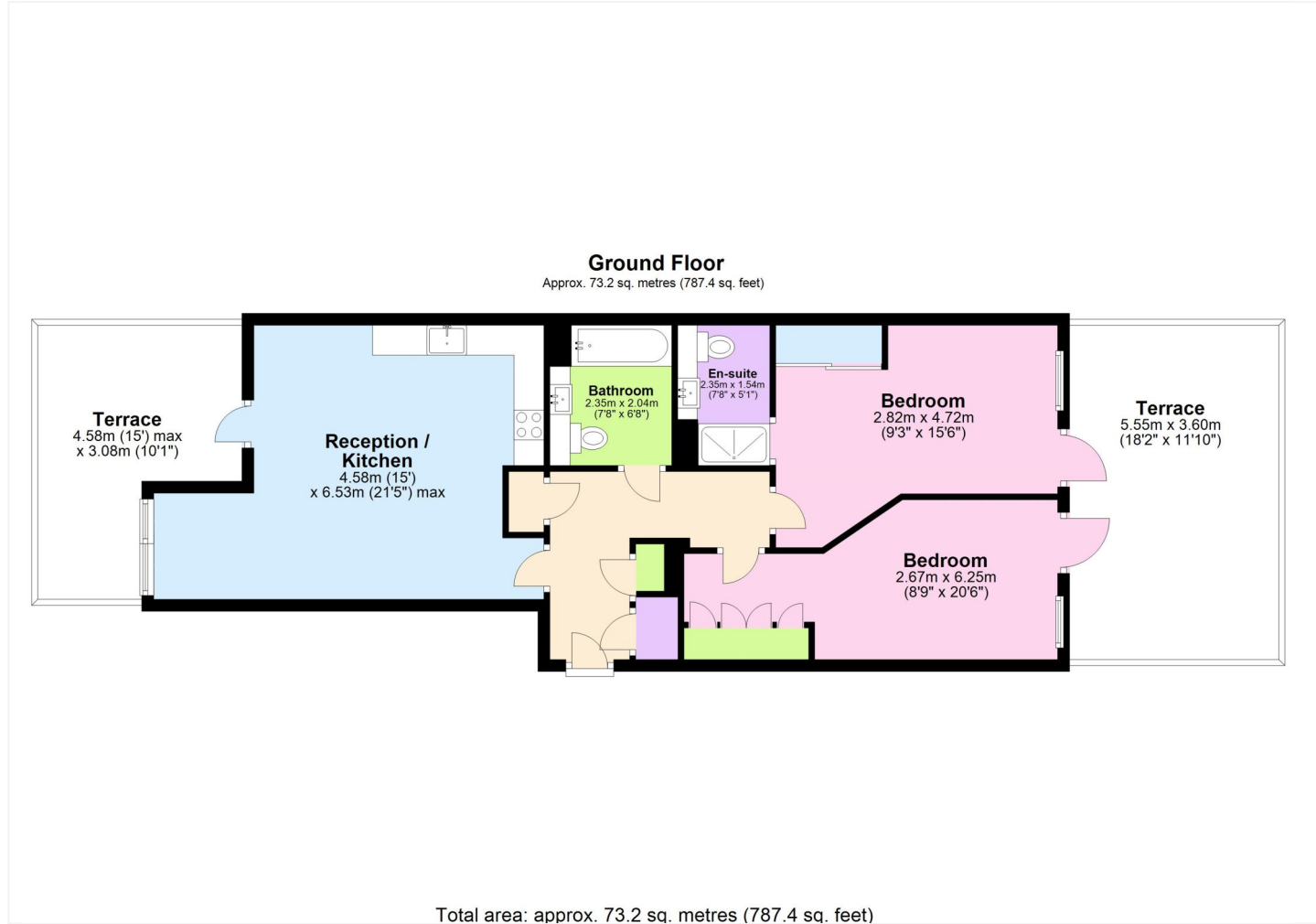

This floorplan is for illustration purposes only and is not to scale. The position and size of doors, windows, appliances and other features are approximate.

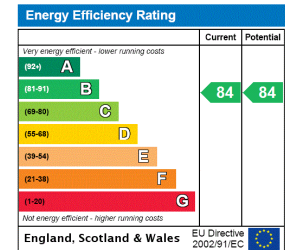

Winkworth