



Millennium Court

Lower Brook Street Basingstoke RG21 7RA

Description

This large two bedroom first floor apartment has plenty of space and a very pleasant position within walking distance of Festival Place and Basingstoke's mainline railway station.

The twin aspect living room has French doors opening out to a 'Juliet' balcony and the kitchen has a good range of appliances.

Both bedrooms are 'doubles' with the master having an en-suite bathroom with a shower.

There is gas fired central heating and an allocated parking space.



Winkworth

Accommodation

Hallway
 Living room
 Kitchen
 Two double bedrooms
 En-suite bathroom
 Shower room
 Allocated parking space
 Furnished

Under the Property Misdescriptions Act 1991, these Particulars are a guide and act as information only. All details are given in good faith and are believed to be correct at time of printing. Winkworth give no representation as to their accuracy and potential purchasers or tenants must satisfy themselves by inspection or otherwise as to their correctness. No employee of Winkworth has authority to make or give any representation or warranty in relation to this property.

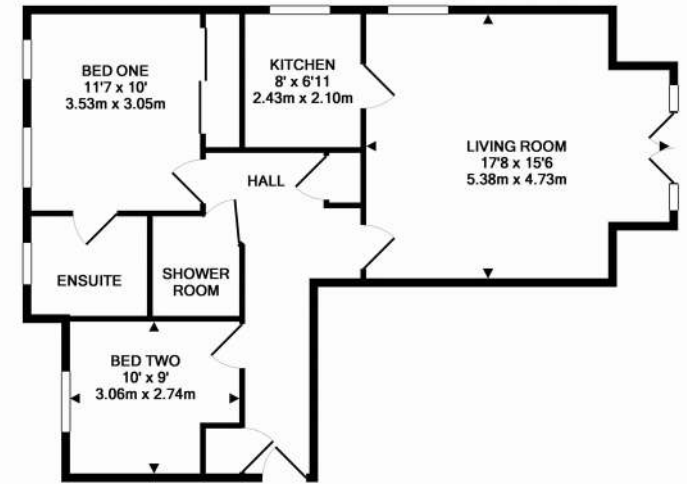
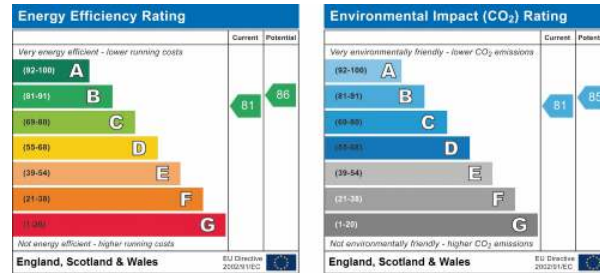

TOTAL APPROX. FLOOR AREA 710 SQ.FT. (65.9 SQ.M.)

Whilst every attempt has been made to ensure the accuracy of the floor plan contained here, measurements of doors, windows, rooms and any other items are approximate and no responsibility is taken for any error, omission, or mis-statement. This plan is for illustrative purposes only and should be used as such by any prospective purchaser. The services, systems and appliances shown have not been tested and no guarantee as to their operability or efficiency can be given.

Made with Metropix ©2018



Basingstoke Office

10B Church Street, Basingstoke, Hampshire, RG21 7QE
 01256 811730 | basingstoke@winkworth.co.uk
winkworth.co.uk/Basingstoke



See things differently.