



HOLT CLOSE, BOREHAMWOOD, HERTFORDSHIRE, WD6
£325,000 LEASEHOLD

A TWO DOUBLE BEDROOM GROUND FLOOR PURPOSE BUILT APARTMENT WITH GARAGE

Borehamwood | 020 8953 8899 | borehamwood@winkworth.co.uk



DESCRIPTION:

Offered for sale with an unexpired lease length of in excess of 188 years is this ground floor two double bedroom apartment offering well proportioned accommodation totalling in excess of 700 square feet and a garage en bloc.

Discreetly positioned in a quiet cu de sac within walking distance of both Elstree Thameslink station and Shenley Road with its plethora of shops and restaurant the property would suit first time buyers, downsizers and investors alike..

AT A GLANCE

- 2 Bedrooms
- Garage En Bloc
- Double Glazed
- 733 Square Feet
- 188 Year Lease



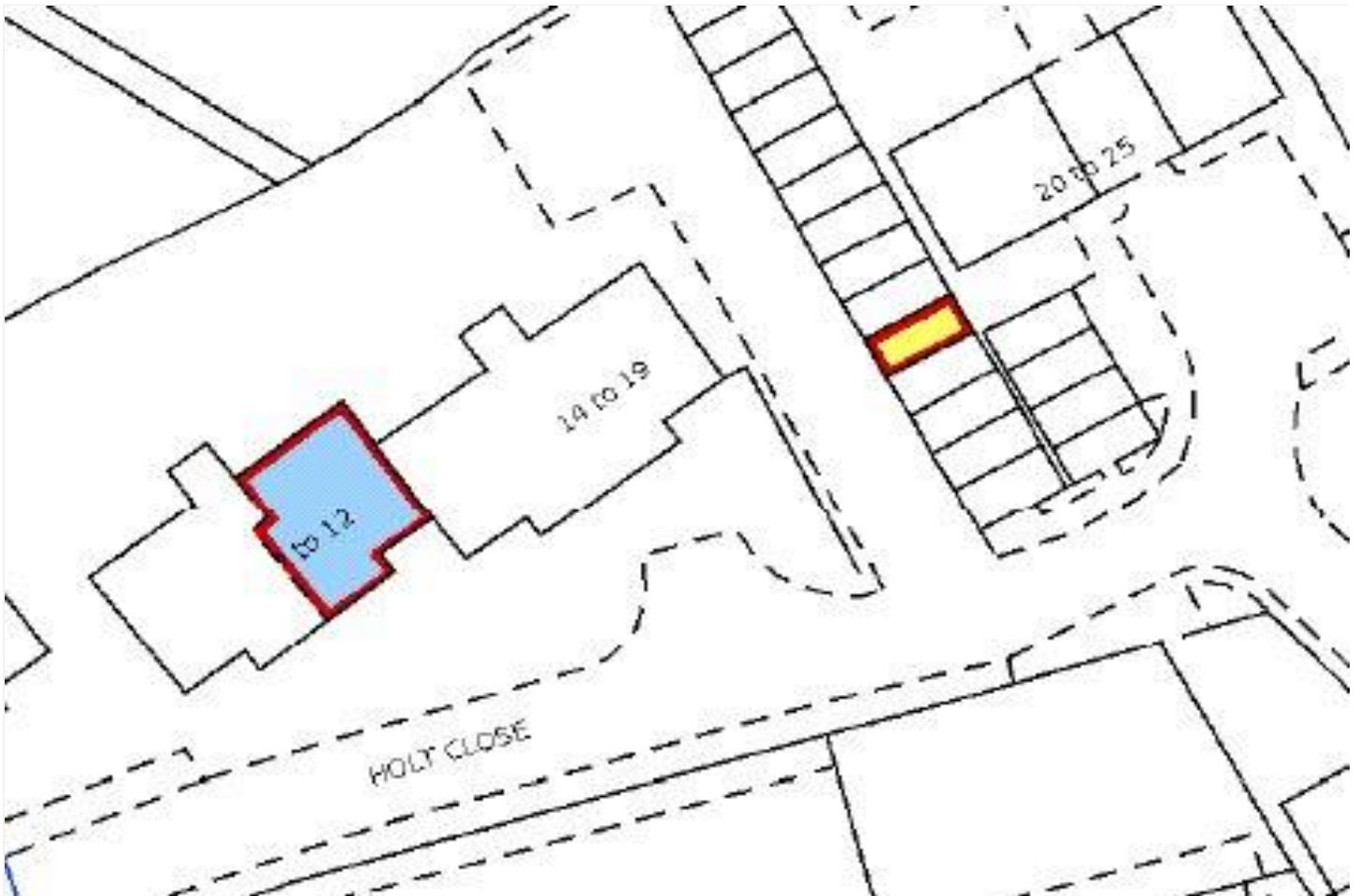

Approximate Gross Internal Area = 68.1 sq m / 733 sq ft

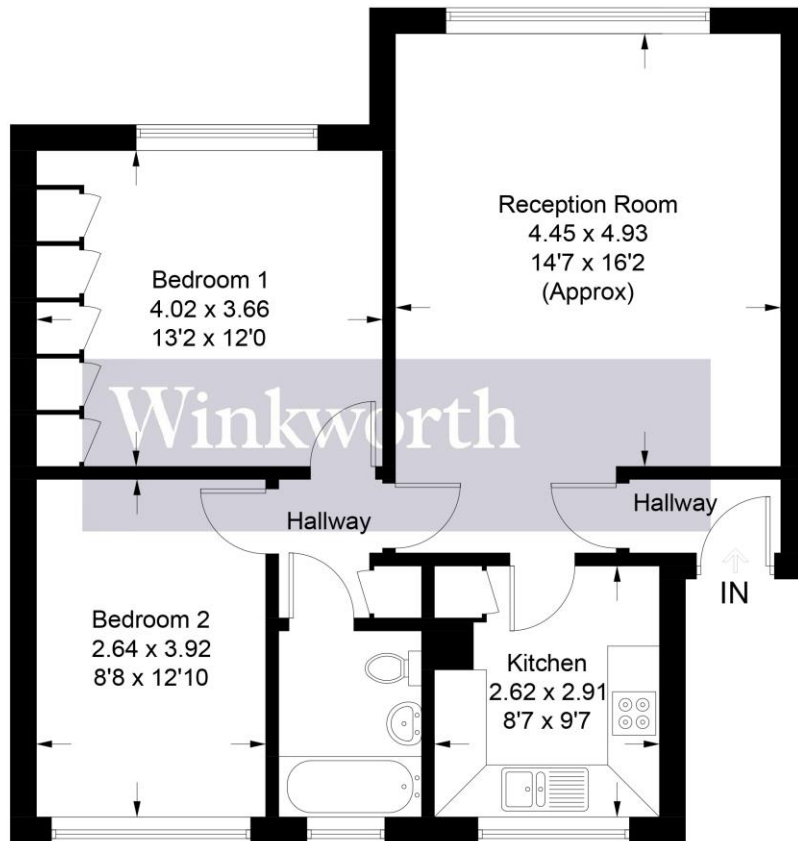

Illustration for identification purposes only, measurements are approximate, not to scale. Winkworth © 2023 (ID985065)

This floorplan is for illustration purposes only and is not to scale. The position and size of doors, windows, appliances and other features are approximate.

Tenure: Leasehold
Term: Expires - 29/09/2211
Service Charge: £0 per annum
Ground Rent: £ 0 Annually (subject to increase)
Council Tax Band: C

Where no figures are shown, we have been unable to ascertain the information. All figures that are shown were correct at the time of printing.