



DIGBY CRESCENT, LONDON, N4
£475,000 TO BE ADVISED

A STUNNING ONE BEDROOM PERIOD FLAT WITH PRIVATE TERRACE

Highbury | 0207 989 7000 | highbury@winkworth.co.uk

Winkworth

winkworth.co.uk

See things differently



DESCRIPTION:

Set on this desirable tree lined Cul-de-Sac minutes from the open spaces of Clissold Park is this impeccable one-bedroom, split level flat with private terrace. The property is located on the first floor of a grand period conversion and offers light filled and well-proportioned rooms throughout. The double bedroom is located to the front of the building and is bathed in light through two large windows. The shower room is finished in a contemporary style and benefits from oversized shower. The kitchen area has recently been refurbished and offers plenty of storage and worktop space including a breakfast bar. It has a generous living room that leads out to south-facing private decked terrace.

Digby Crescent is renowned as a neighbourly and family friendly street and is perfectly situated for the amenities of the prestigious Highbury Barn and Blackstock Road. The green open spaces of Clissold Park and the bars and restaurants of the vibrant Stoke Newington Church St are also close by. Transport Links are well serviced with Arsenal (Piccadilly Line) and Finsbury Park (Victoria and Piccadilly Line and National Rail direct to Moorgate) both of which are in easy reach whilst there are also a number of great bus links taking you into the City, West End and Angel.

Winkworth



Winkworth

Digby Crescent, N4

Approx. Gross Internal Floor Area 489 sq. ft / 45.45 sq. m

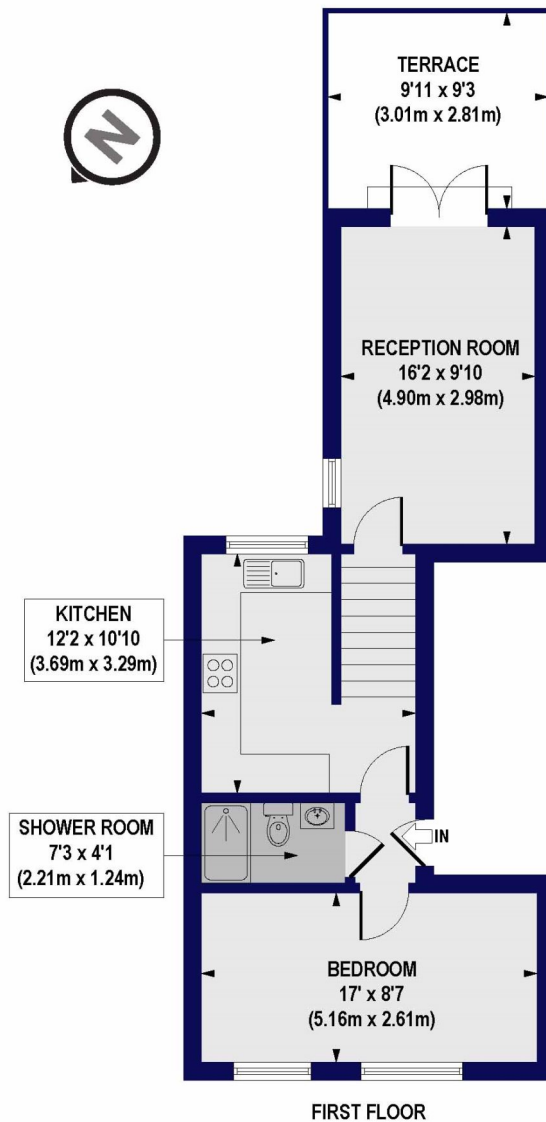

All measurements of walls, doors, windows, fittings and appliances, including their size and location, are shown as standard sizes and do not constitute any warranty or representation by the seller, their agent or CP Creative. Any intending purchaser must satisfy himself by inspection or otherwise as to the correctness of the information contained in these plans. This plan is for illustrative purposes only and should be used as such by any prospective purchasers.

Winkworth

This floorplan is for illustration purposes only and is not to scale. The position and size of doors, windows, appliances and other features are approximate.

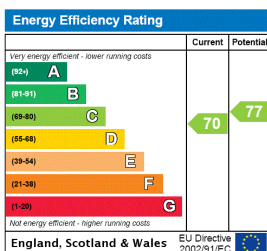

Highbury | 0207 989 7000 | highbury@winkworth.co.uk

Winkworth

winkworth.co.uk

See things differently

Winkworth wishes to inform prospective buyers and tenants that these particulars are a guide and act as information only. All our details are given in good faith and believed to be correct at the time of printing but they don't form part of an offer or contract. No Winkworth employee has authority to make or give any representation or warranty in relation to this property. All fixtures and fittings, whether fitted or not are deemed removable by the vendor unless stated otherwise and room sizes are measured between internal wall surfaces, including furnishings.