



Bullhead Road, Hertfordshire, WD6

£325,000 *Leasehold*



An Extended and Well-Presented Ground Floor Maisonette with Private Garden

KEY FEATURES

- Two Large Double Bedrooms
- Large Westerly Facing Rear Garden
- South Borehamwood
- 711 Square Feet
- 131 Year Unexpired Lease
- Gas Central Heating



Borehamwood

020 8953 8899 | borehamwood@winkworth.co.uk



Located on the South side of Borehamwood is this well presented and extended two double bedroom ground floor purpose-built garden maisonette.

Having historically been subject to a rear extension the property now provides circa 711 square feet of well-proportioned accommodation, with spacious reception room leading onto kitchen, modern bathroom, gas central heating and double glazing. The property is complimented by a large Westerly facing rear garden.

This maisonette is ideally located for a short walk to the highly regarded Monksmead primary and Yavneh Primary and Secondary Schools, plus the added benefit of being approx. 1 mile from Elstree & Borehamwood Station, which gives direct access into London.

MATERIAL INFO

Tenure: Leasehold

Term: 130 year and 9 months

Service Charge: £450 per annum

Ground Rent: £ 50 Annually (subject to increase)

Council Tax Band: C

EPC rating: C



Approximate Gross Internal Area
66.1 sq m / 711 sq ft

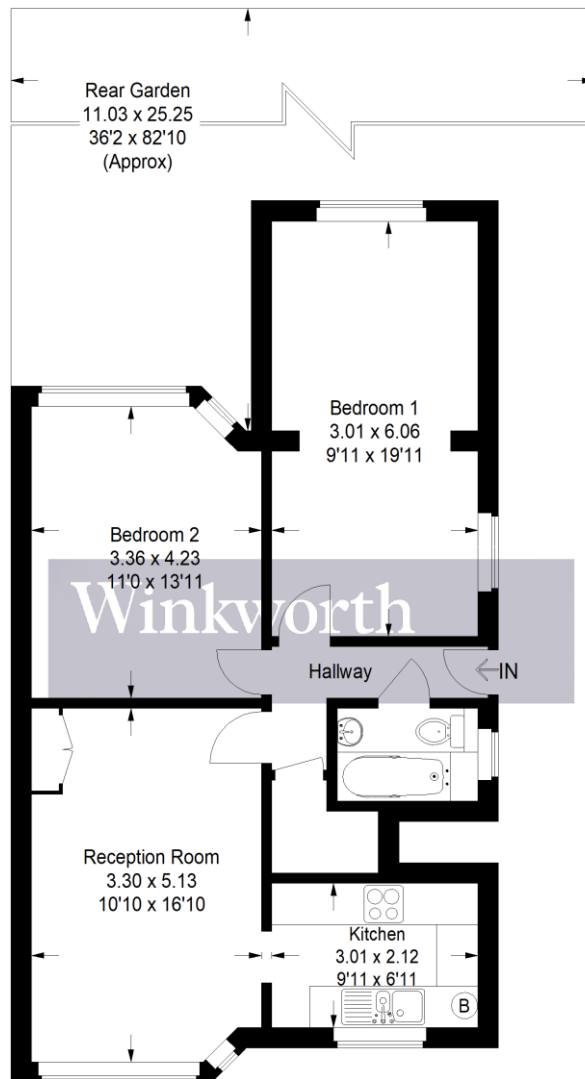
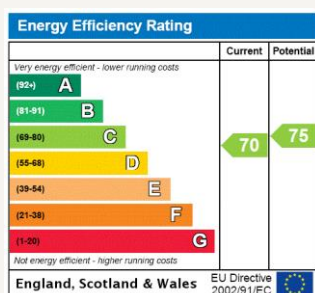

Illustration for identification purposes only, measurements are approximate, not to scale. Winkworth © 2022 (ID 852385)

For more information, scan the QR code or visit the link below



<https://www.winkworth.co.uk/sale/property/BOR220101>

Where no figures are shown, we have been unable to ascertain the information. All figures that are shown were correct at the time of printing.

Borehamwood

020 8953 8899 | borehamwood@winkworth.co.uk