



Bennett Park, SE3

£1,900 per month *Part Furnished, Unfurnished*



A stunning one bedroom, two reception room flat found on the first floor of this beautiful period property in the heart of Blackheath village. Landlord is flexible on furniture and the property is available late Dec/early Jan, your earliest viewing is advised.



Blackheath

0208 8520999 | blackheath@winkworth.co.uk

First Floor

Approx. 39.3 sq. metres (423.2 sq. feet)

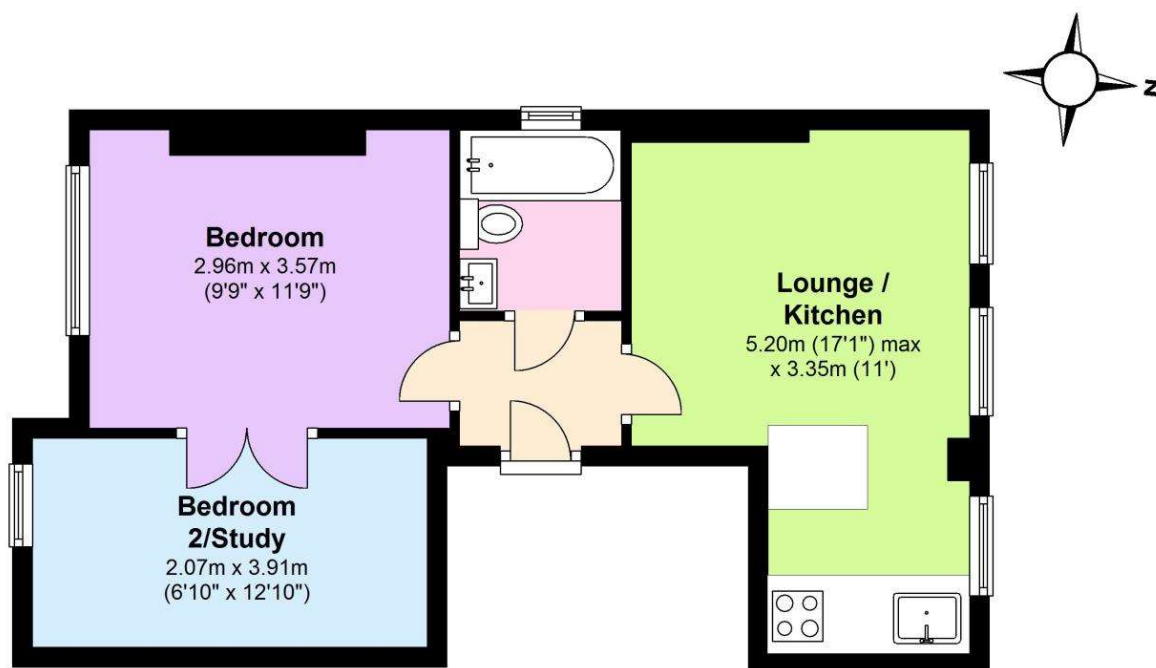

Total area: approx. 39.3 sq. metres (423.2 sq. feet)

MATERIAL INFO

For more information, scan the QR code or visit the link below

Deposit: £2,192.31

Holding Deposit:

Council Tax Band:

EPC rating: D

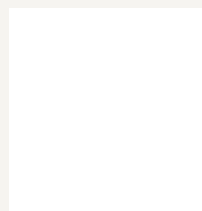

<https://www.winkworth.co.uk/rent/property/BLA250278>

Where no figures are shown, we have been unable to ascertain the information. All figures that are shown were correct at the time of printing.

Blackheath

0208 8520999 | blackheath@winkworth.co.uk