

LILLIE HOUSE, FIELDWAY CRESCENT, LONDON, N5  
**£750,000 LEASEHOLD**

## A STUNNING, THREE BEDROOM MAISONETTE WITH TWO PRIVATE GARDENS IN HIGHBURY, N5.

Highbury | 0207 989 7000 | [highbury@winkworth.co.uk](mailto:highbury@winkworth.co.uk)

**Winkworth**

*[winkworth.co.uk](http://winkworth.co.uk)*

See things differently





## DESCRIPTION:

A spacious, three double bedroom, split level maisonette positioned moments from the ever-popular Highbury Fields. Situated in this attractive purpose-built block, the property offers a wonderfully generous sized kitchen, complete with ample worktop space and cupboards, while the living and dining area leads directly out to a private, south facing garden. Upstairs are three well-proportioned bedrooms and a family bathroom with a modern, contemporary feel and separate wc. The property is offered in an excellent condition throughout and benefits from being offered to the market on a chain free basis.

Fieldway Crescent is set at the entrance to the green space of Highbury Fields with its cacophony of sporting activities and play spaces, not to mention freightliners farm as well as Islington Central Library on your doorstep. Situated a short walk away is the prestigious Highbury Barn which offers a number of renowned local amenities; including Godfrey's Butchers, Bourne's Fishmongers, La Fromagerie, and Highbury Vintners; not forgetting the ever popular Provisions, Le Pêché Mignon as well as the brand new Harvest and everything that upper street has to offer.

Transport links are a short distance away and well serviced by a selection of convenient bus routes, Highbury and Islington Station (Victoria Line and Overground), Holloway Underground Station (Piccadilly Line), as well as, and within close proximity is Drayton Park Overground Station which takes you directly to Moorgate.

**Winkworth**





Winkworth

**Lillie House, Fieldway Crescent, N5**  
**Approx. Gross Internal Floor Area 834 sq. ft / 77.48 sq. m**

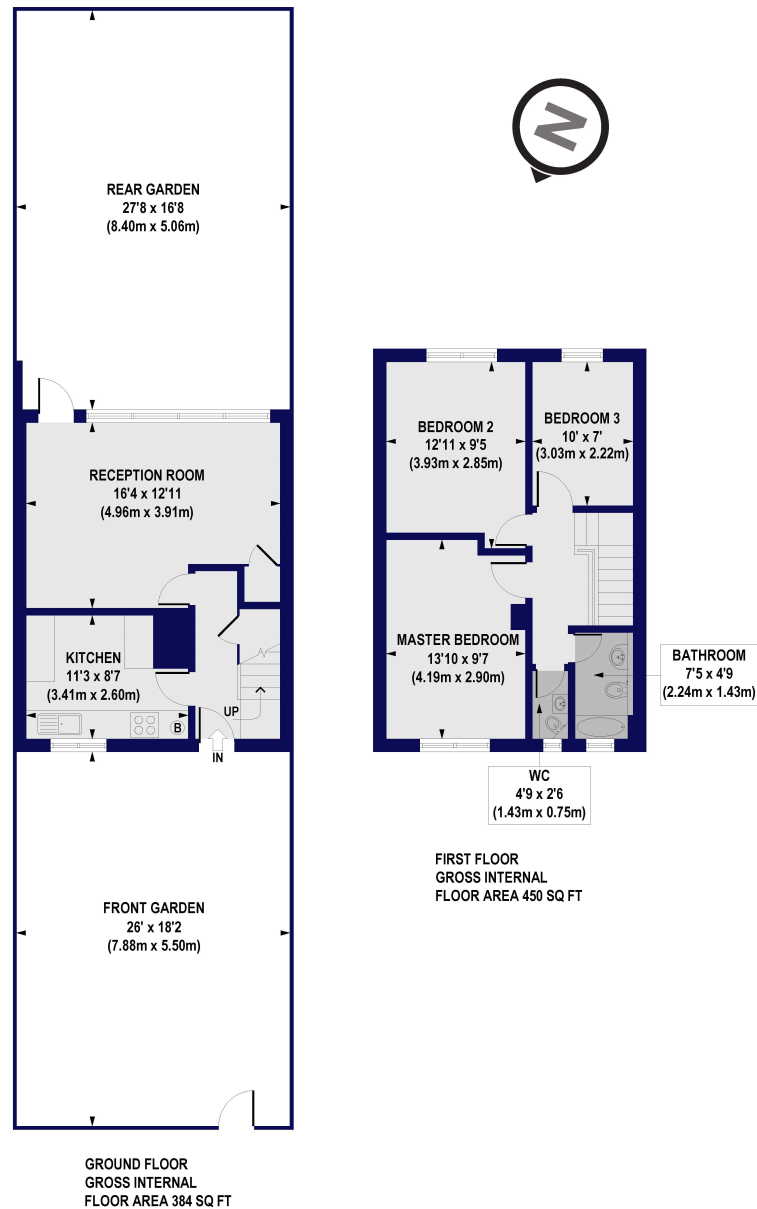

All measurements of walls, doors, windows, fittings and appliances, including their size and location, are shown as standard sizes and do not constitute any warranty or representation by the seller, their agent or CP Creative. Any intending purchaser must satisfy himself by inspection or otherwise as to the correctness of the information contained in these plans. This plan is for illustrative purposes only and should be used as such by any prospective purchasers.

**Winkworth**

This floorplan is for illustration purposes only and is not to scale. The position and size of doors, windows, appliances and other features are approximate.

Highbury | 0207 989 7000 | highbury@winkworth.co.uk

**Winkworth**

*winkworth.co.uk*

See things differently

Winkworth wishes to inform prospective buyers and tenants that these particulars are a guide and act as information only. All our details are given in good faith and believed to be correct at the time of printing but they don't form part of an offer or contract. No Winkworth employee has authority to make or give any representation or warranty in relation to this property. All fixtures and fittings, whether fitted or not are deemed removable by the vendor unless stated otherwise and room sizes are measured between internal wall surfaces, including furnishings.