

**DALEVIEW ROAD, N15**  
**£465,000 LEASEHOLD**

### **DESCRIPTION:**

This charming two-bedroom ground floor Victorian conversion and south-facing back garden, can be found within a residential enclave filled with attractive terraces in South Tottenham, close to Stamford Hill

Harringay | 020 8800 5151 | [harringay@winkworth.co.uk](mailto:harringay@winkworth.co.uk)

**Winkworth**

for every step...

[winkworth.co.uk](http://winkworth.co.uk)

Daleview Road, N15  
Approx. Gross Internal Floor Area 615 sq. ft / 57.14 sq. m

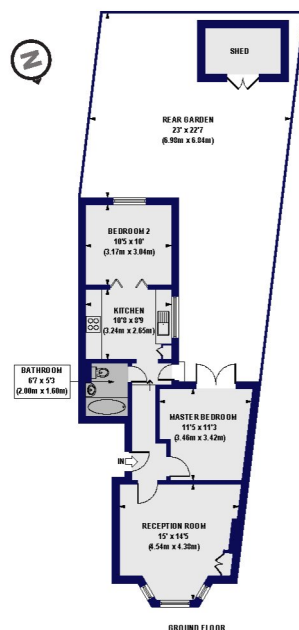

All measurements of walls, doors, windows, fittings and appliances, including gas and electricity, are shown as standard and do not constitute any warranty or representation by the seller, their agent or Winkworth. Any measurements shown must always be confirmed by the seller as to the correctness of the information contained in these plans. These plans are for illustration purposes only and should be used as a guide only for prospective purchasers.

Winkworth

This floorplan is for illustration purposes only and is not to scale. The position and size of doors, windows, appliances and other features are approximate.

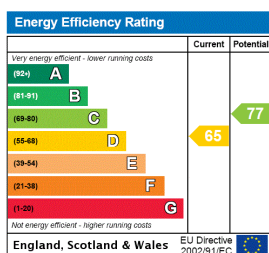

Harringay | 020 8800 5151 | harringay@winkworth.co.uk

Winkworth

for every step...

winkworth.co.uk

winkworth wishes to inform prospective buyers and tenants that these particulars are a guide and act as information only. All our details are given in good faith and believed to be correct at the time of printing but they don't form part of an offer or contract. No winkworth employee has authority to make or give any representation or warranty in relation to this property. All fixtures and fittings, whether fitted or not are deemed removable by the vendor unless stated otherwise and room sizes are measured between internal wall surfaces, including furnishings.