



Sherwood Street, Reading, Berkshire, RG30 1LE

£1,695 per month *Unfurnished*

3 2 1

Newly refurbished three bedroom terrace house in West Reading.

Newly refurbished terrace house in West Reading located close to local amenities and transport links with easy access to Reading town centre. The property comprises two reception rooms, brand new kitchen and shower room, separate cloakroom and three bedrooms. Further benefits include on road residents parking and low maintenance private rear garden. Available 6th March 2026. Unfurnished.

KEY FEATURES

- Three bedroom terrace house
- Refurbished throughout
- Private rear garden
- On road residents parking
- Council tax band B
- Available 6th March 2026
- Unfurnished



Reading

0118 4022 300 | reading@winkworth.co.uk

Winkworth

for every step...





MATERIAL INFO

Deposit: £1,955.77

Holding Deposit: £391.15

Council Tax Band: B

EPC rating: C

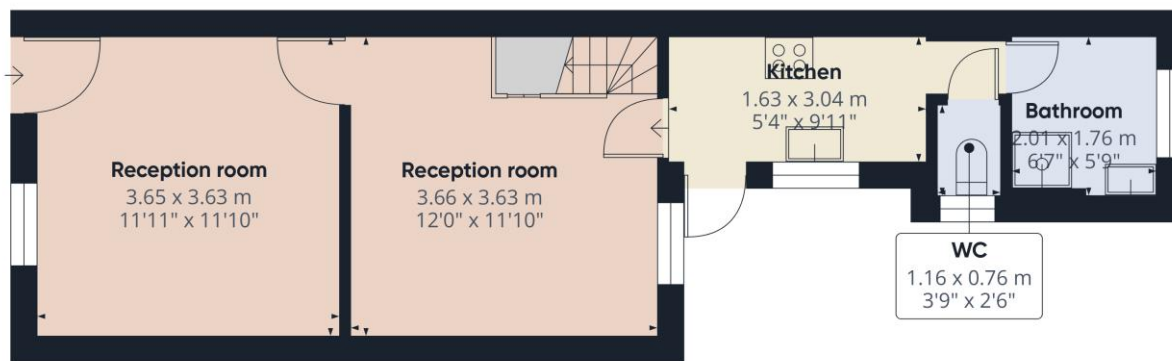

Ground Floor

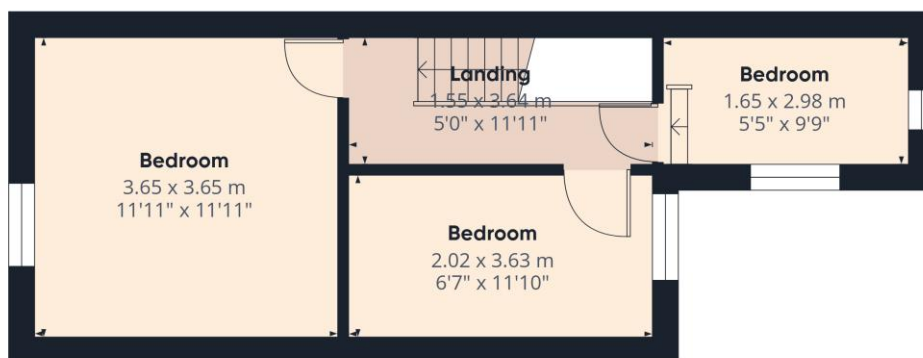
Approximate total area⁽¹⁾65.7 m²
708 ft²

Floor 1

(1) Excluding balconies and terraces

Calculations reference the RICS IPMS 3C standard. Measurements are approximate and not to scale. This floor plan is intended for illustration only.

GIRAFFE360

Score	Energy rating	Current	Potential
92+	A		
81-91	B		
69-80	C		
55-68	D		
39-54	E		
21-38	F		
1-20	G		

For more information, scan the QR code or visit the link below

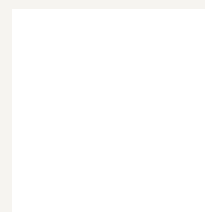
<https://www.winkworth.co.uk/rent/property/REA250527>

Where no figures are shown, we have been unable to ascertain the information. All figures that are shown were correct at the time of printing.

Reading

0118 4022 300 | reading@winkworth.co.uk

Winkworth

for every step...

Winkworth wishes to inform prospective buyers and tenants that these particulars are a guide and act as information only. All our details are given in good faith and believed to be correct at the time of printing but they don't form part of an offer or contract. No Winkworth employee has authority to make or give any representation or warranty in relation to this property. All fixtures and fittings, whether fitted or not are deemed removable by the vendor unless stated otherwise and room sizes are measured between internal wall surfaces, including furnishings.