



New Bright Street, Berkshire, RG1 6QQ
£1,250 per month *Furnished*



Attractive one bedroom first floor apartment located in the popular Holybrook development in the heart of Reading Town Centre, next to the Oracle. The property comprises a spacious open plan living/dining area, modern kitchen, double bedroom with fitted wardrobes, study/small single bedroom and bathroom. Off road parking space included. Available now. Furnished.

KEY FEATURES

- Town Centre Holybrook Development
- One bedroom
- Study room
- Two Parking Spaces
- Available now
- Furnished



Reading

0118 4022 300 | reading@winkworth.co.uk



for every step...





MATERIAL INFO

Deposit: £1,442.31

Holding Deposit: £288.46

Council Tax Band: C

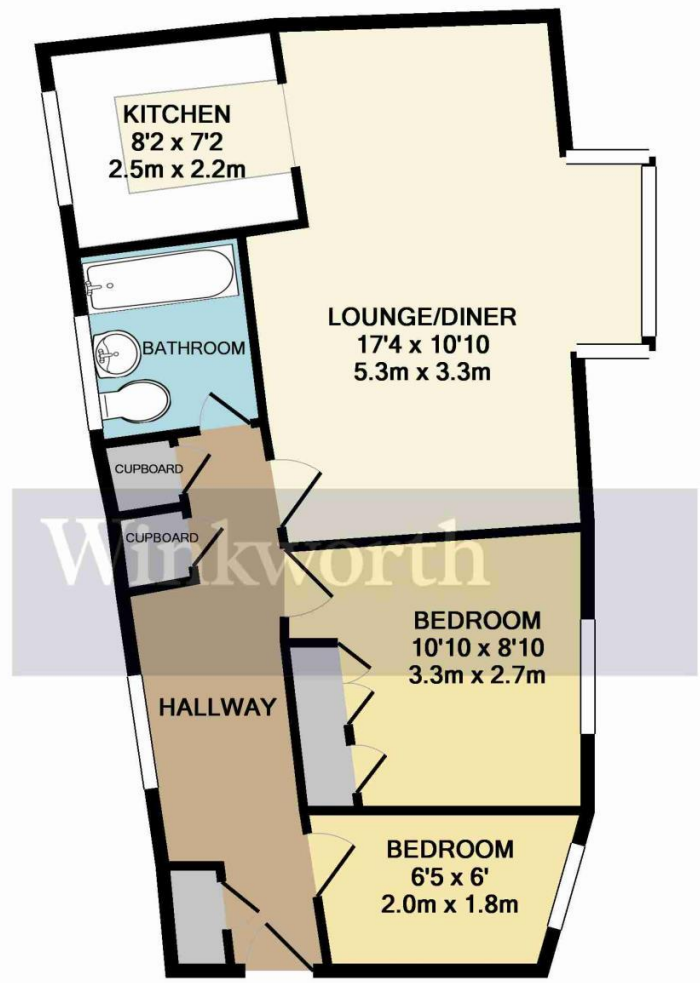

TOTAL APPROX. FLOOR AREA 540 SQ.FT. (50.1 SQ.M.)

Whilst every attempt has been made to ensure the accuracy of the floor plan contained here, measurements of doors, windows, rooms and any other items are approximate and no responsibility is taken for any error, omission, or mis-statement. This plan is for illustrative purposes only and should be used as such by any prospective purchaser. The services, systems and appliances shown have not been tested and no guarantee as to their operability or efficiency can be given
 Made with Metropix ©2015

Score	Energy rating	Current	Potential
92+	A		
81-91	B		
69-80	C	73 C	74 C
55-68	D		
39-54	E		
21-38	F		
1-20	G		

For more information, scan the QR code or visit the link below

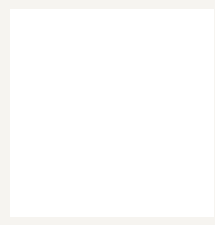

<https://www.winkworth.co.uk/rent/property/REA150270>

Where no figures are shown, we have been unable to ascertain the information. All figures that are shown were correct at the time of printing.

Reading
 0118 4022 300 | reading@winkworth.co.uk



Winkworth wishes to inform prospective buyers and tenants that these particulars are a guide and act as information only. All our details are given in good faith and believed to be correct at the time of printing but they don't form part of an offer or contract. No Winkworth employee has authority to make or give any representation or warranty in relation to this property. All fixtures and fittings, whether fitted or not are deemed removable by the vendor unless stated otherwise and room sizes are measured between internal wall surfaces, including furnishings.