



WESTBOURNE TERRACE, BAYSWATER, W2
£650,000 LEASEHOLD ABOUT 105 YEARS REMAINING

LOCATED IN W2 - HYDE PARK, SET IN AN ATTRACTIVE GRADE II VICTORIAN BUILDING, A BEAUTIFULLY PRESENTED ONE BEDROOM, SECOND AND THIRD FLOOR DUPLEX APARTMENT, WITH A SHARE OF FREEHOLD.

Paddington & Bayswater | 0207 467 5770 | paddington@winkworth.co.uk

Winkworth

for every step...

winkworth.co.uk



DESCRIPTION:

Located within close proximity to Hyde Park and Kensington Gardens; Westbourne Terrace is a most attractive tree lined street, running north from Hyde Park, with Paddington Station (Heathrow Express and the Elizabeth Line), Lancaster Gate (central line) and The A40 close at hand.

This property is offered for sale with no upward chain and un-allocated off street parking via the carriage driveway.



Winkworth

for every step...



Winkworth

for every step...

Westbourne Terrace, W2

Approx. Gross Internal Area *
457 Sq Ft - 42.46 Sq M

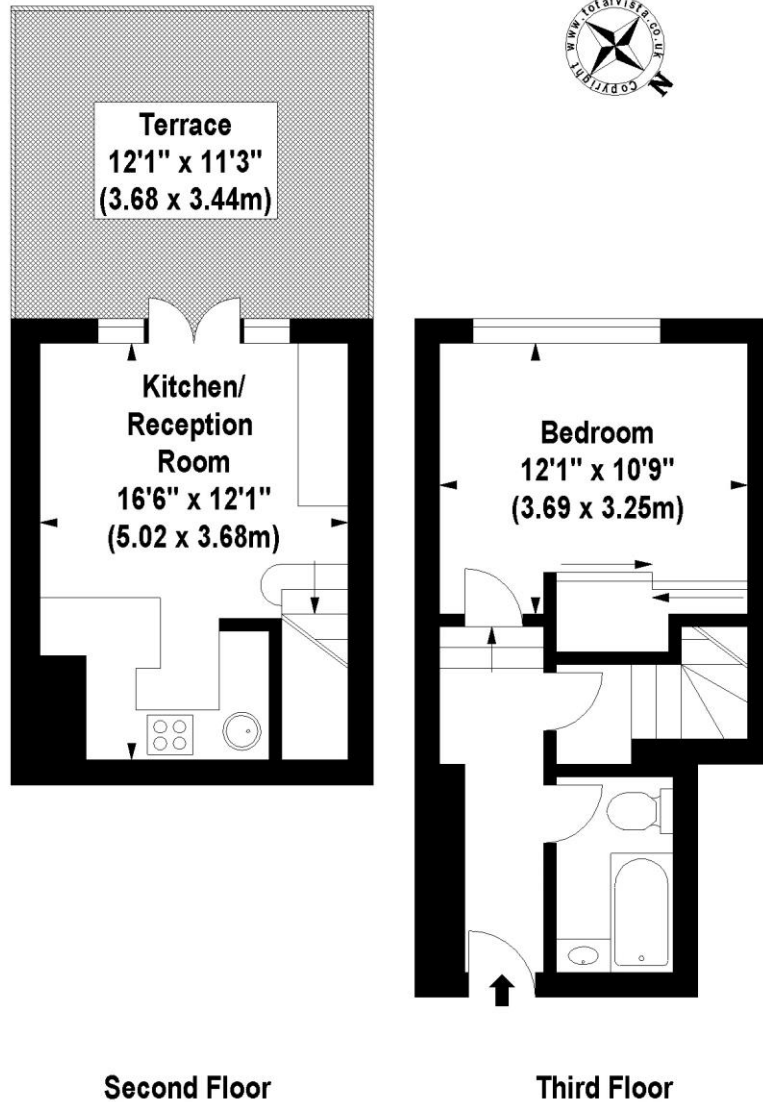

Illustration For Identification Purposes Only. Not To Scale
*Floorplan Drawn According To RICS Guidelines
© www.totalvista.co.uk 2013 (aa)

This floorplan is for illustration purposes only and is not to scale. The position and size of doors, windows, appliances and other features are approximate.

Tenure: Leasehold with Share of Freehold
Term: Expires - 06/11/2129
Service Charge: £2,500 per annum
Ground Rent: Peppercorn
Council Tax Band: D

Where no figures are shown, we have been unable to ascertain the information. All figures that are shown were correct at the time of printing.

Paddington & Bayswater | 0207 467 5770 | paddington@winkworth.co.uk

Winkworth

for every step...

winkworth.co.uk

Winkworth wishes to inform prospective buyers and tenants that these particulars are a guide and act as information only. All our details are given in good faith and believed to be correct at the time of printing but they don't form part of an offer or contract. No Winkworth employee has authority to make or give any representation or warranty in relation to this property. All fixtures and fittings, whether fitted or not are deemed removable by the vendor unless stated otherwise and room sizes are measured between internal wall surfaces, including furnishings.