

Dawson Road, Sleaford, Lincolnshire

This floorplan is for illustration purposes only and is not to scale. The position and size of doors, windows, appliances and other features are approximate.

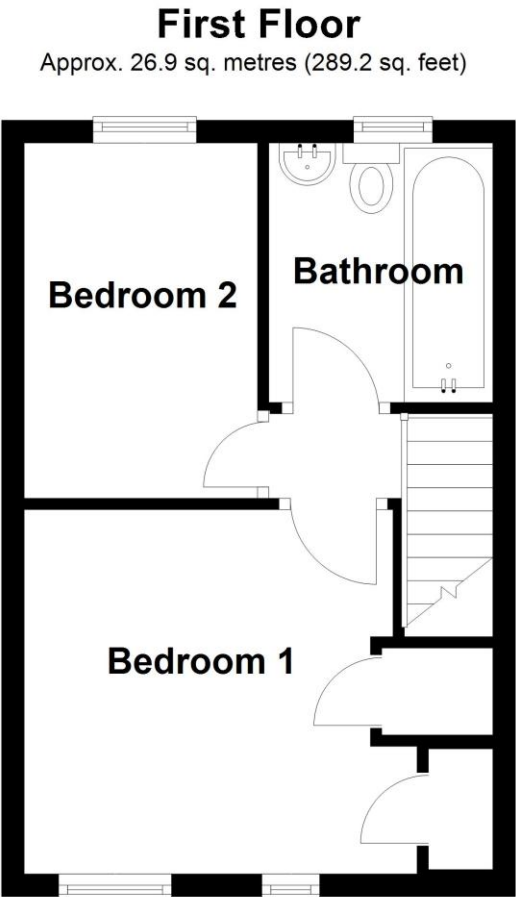

Total area: approx. 51.8 sq. metres (557.3 sq. feet)

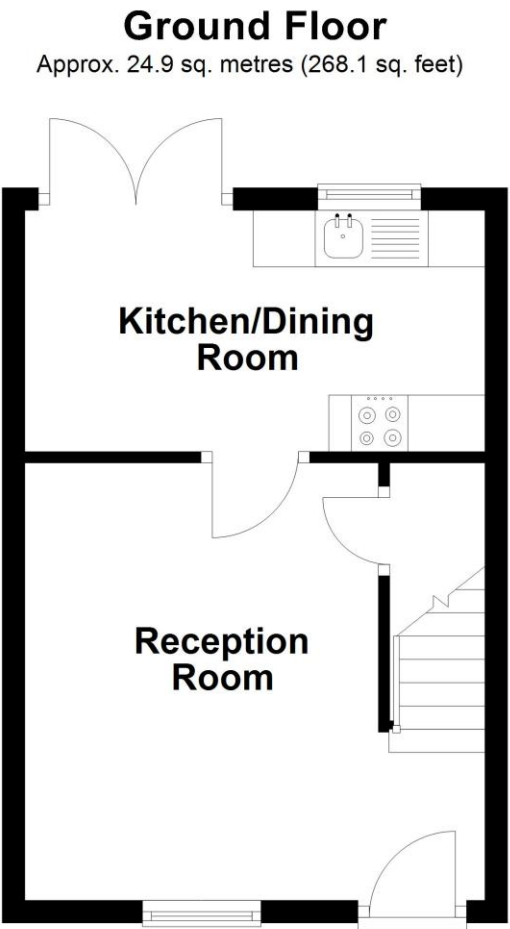

19 Dawson Road, Sleaford, Lincolnshire, NG34 8TR

£150,000 Freehold

Energy Efficiency Rating		
	Current	Potential
Very energy efficient - lower running costs		
(92+)	A	89
(81-91)	B	
(69-80)	C	
(55-68)	D	60
(39-54)	E	
(21-38)	F	
(1-20)	G	
Not energy efficient - higher running costs		
England, Scotland & Wales	EU Directive 2002/91/EC	

NO CHAIN | TWO BEDROOM SEMI DETACHED HOME | MODERN FLOORING & DECOR | KITCHEN/DINER | PARKING FOR THREE CARS | OVERLOOKS PARK TO THE REAR | UPVC DOUBLE GLAZING | GAS CENTRAL HEATING | VIEWING IS ESSENTIAL





NO CHAIN - This two bedroom semi detached home is offered for sale with the benefit of no onward chain. The property boasts a modern decor and flooring and a lovely rear garden with decking area. To the front and side of the property is a gravel driveway offering off street parking for uup to three cars.

The accommodation comprises of Lounge, Kitchen/Diner, Two Bedrooms and a Bathroom.

The property also boasts Gas Central Heating and UPVC Double Glazing.

A viewing is highly advised and would make an ideal purchase for first time buyers and investors alike.



**ACCOMMODATION**

**Lounge** - 13'2" x 12'9" (4.01m x 3.89m)

**Kitchen/Dining Room** - 13'4" x 7' (4.06m x 2.13m)

**Bedroom 1** - 10'5" x 9'9" (3.18m x 2.97m)

**Bedroom 2** - 10'4" x 6'9" (3.15m x 2.06m)

**Bathroom** - 7'4" x 6'5" (2.24m x 1.96m)