



Artesian Road, W2

£595,000 *Share of Freehold*

1  1  1 

A BRIGHT AND CHARMING, FIRST FLOOR ONE BEDROOM APARTMENT IN THIS SOUGHT AFTER NOTTING HILL LOCATION.



Notting Hill Sales

0207 727 3227 | nottinghill@winkworth.co.uk

Winkworth

for every step...



This bright and charming one bedroom apartment forms the first floor of an attractive period building with high ceilings and wood flooring throughout and features lovely open plan living space to the front with floor to ceiling, south facing, sash windows flooding the space with light. Located in such a peaceful and popular spot in the renowned Artesian Village.

Utilities:

Electricity – Mains

Water – Mains

Sewerage – Mains

Heating – Gas

Broadband <https://checker.ofcom.org.uk/en-gb/broadband-coverage>

Mobile Coverage <https://checker.ofcom.org.uk/en-gb/mobile-coverage>

MATERIAL INFO

Tenure: Share of Freehold

Term: 948 year and 6 months

Service Charge: £1,100 per annum

Ground Rent: £20 Annually (subject to increase)

Council Tax Band: C (Westminster)

EPC rating: D



ARTESIAN ROAD, W2

APPROXIMATE GROSS INTERNAL AREA
371 Ft² - 34.48 M²

COMPLIANT WITH RICS CODE OF MEASURING PRACTICE Floorplan is for illustrative purposes only and is not to scale. Every attempt has been made to ensure the accuracy of the floorplan shown, however all measurements, fixtures, fittings and data shown are an approximate interpretation for illustrative purposes only. Liability for errors, omissions or mis-statement through negligence or otherwise is hereby excluded.

Key :
CH - Ceiling Height

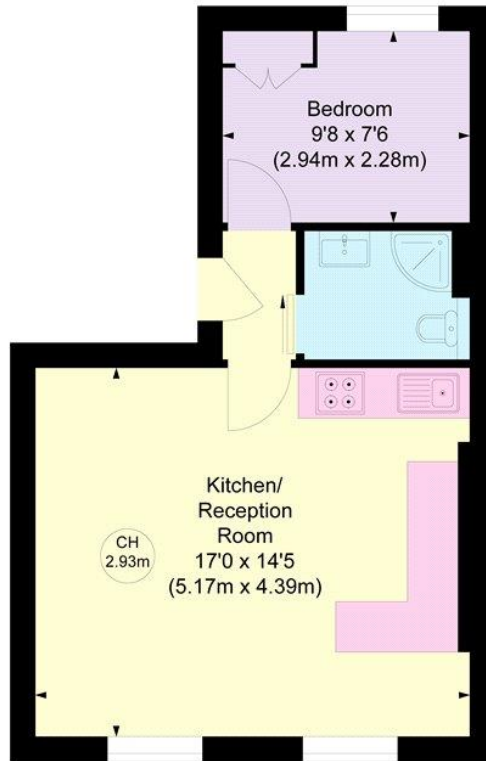

Winkworth

FIRST FLOOR

For more information, scan the QR code or visit the link below

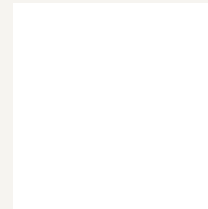
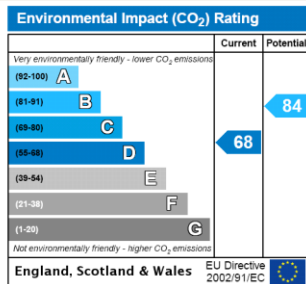
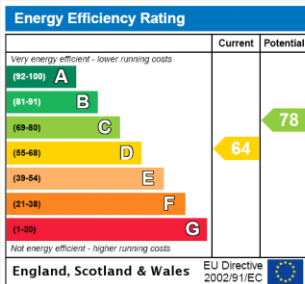

<https://www.winkworth.co.uk/sale/property/NHS250190>

Where no figures are shown, we have been unable to ascertain the information. All figures that are shown were correct at the time of printing.

Notting Hill Sales

0207 727 3227 | nottinghill@winkworth.co.uk

Winkworth

for every step...

Winkworth wishes to inform prospective buyers and tenants that these particulars are a guide and act as information only. All our details are given in good faith and believed to be correct at the time of printing but they don't form part of an offer or contract. No Winkworth employee has authority to make or give any representation or warranty in relation to this property. All fixtures and fittings, whether fitted or not are deemed removable by the vendor unless stated otherwise and room sizes are measured between internal wall surfaces, including furnishings.