



TYLER STREET, GREENWICH, LONDON, SE10  
**£740,000 FREEHOLD**

**WE ARE PLEASED TO OFFER THIS STUNNING AND BEAUTIFULLY PRESENTED TWO BEDROOM VICTORIAN, END OF TERRACE HOUSE, THAT MEASURES CIRCA 851 SQ FT AND IS LOCATED ON THIS QUIET AND PRETTY ROAD IN EAST GREENWICH.**

Greenwich | 02030533033 | greenwich@winkworth.co.uk

**Winkworth**

*winkworth.co.uk*

See things differently



## DESCRIPTION:

We are pleased to offer this stunning and beautifully presented two bedroom Victorian, end of terrace house, that measures circa 851 sq ft and is located on this quiet and pretty road in East Greenwich.

In immaculate order throughout, the property briefly comprises a lovely through reception room with oak flooring and a lovely gas effect fireplace. Downstairs there is a well fitted modern kitchen and storage understairs. Upstairs there are two, bright, double bedrooms and a large and particularly well fitted bathroom, with shower cubicle. There is also a large boarded loft, with pull down ladder, which could certainly be extended into if need be. To the rear is an east facing garden, which is decked and includes a small shed. Added benefits include stunning new sash windows and plantation shutters in the reception room and both bedrooms. There is permit parking to the front, but the property also has access to a secure, unallocated, parking area at the end of the road.

Tyler Street is an incredibly popular road in East Greenwich. It is really well located for quick access to local shops on Trafalgar Road, but also just a short walk to the town centre, which offers a wide variety of shops and restaurants, along with Mainline rail, riverboat service and DLR. The Royal Park, with its Observatory and Maritime Museum, is also a short walk away.

## AT A GLANCE

- two bedroom house
- Victorian end of terrace
- beautiful condition
- 851 sq ft
- new sash windows
- plantation shutters
- oak flooring
- large boarded loft
- large through reception
- east facing garden
- quiet road





### Ground Floor

Approx. 39.5 sq. metres (425.7 sq. feet)

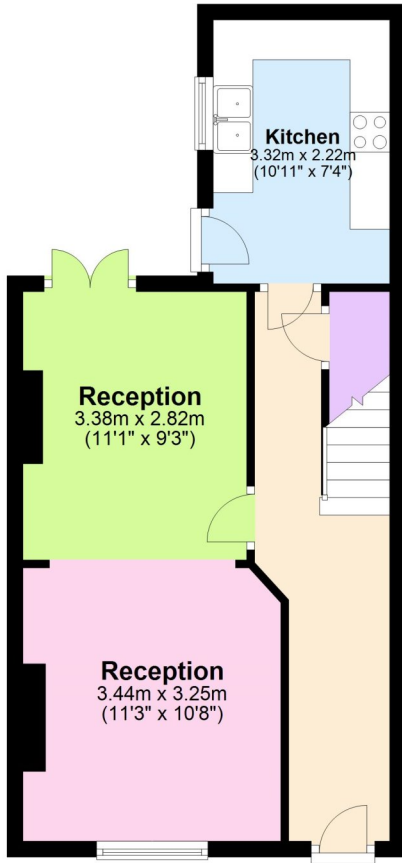

### First Floor

Approx. 39.6 sq. metres (425.8 sq. feet)

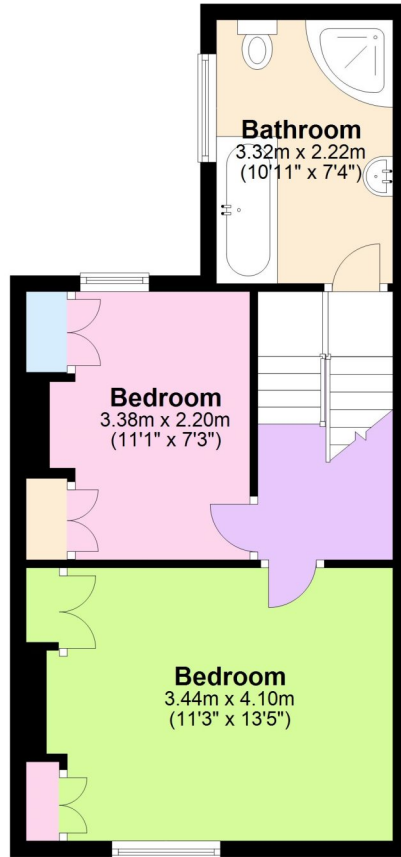

Total area: approx. 79.1 sq. metres (851.5 sq. feet)

This floorplan is for illustration purposes only and is not to scale. The position and size of doors, windows, appliances and other features are approximate.

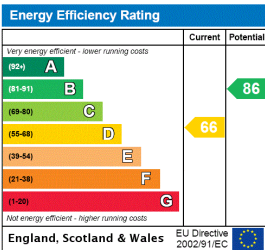

Greenwich | 02030533033 | greenwich@winkworth.co.uk



winkworth.co.uk

See things differently

Winkworth wishes to inform prospective buyers and tenants that these particulars are a guide and act as information only. All our details are given in good faith and believed to be correct at the time of printing but they don't form part of an offer or contract. No Winkworth employee has authority to make or give any representation or warranty in relation to this property. All fixtures and fittings, whether fitted or not are deemed removable by the vendor unless stated otherwise and room sizes are measured between internal wall surfaces, including furnishings.