

PRINCES AVENUE, N13  
**£535,000 FREEHOLD**

**A SPACIOUS FAMILY HOME LOCATED WITHIN EASY REACH OF PUBLIC TRANSPORT LINKS AND SCHOOLS.**

Palmers Green | 020 8920 9900 | [palmersgreen@winkworth.co.uk](mailto:palmersgreen@winkworth.co.uk)

**Winkworth**

for every step...

*[winkworth.co.uk](http://winkworth.co.uk)*





## DESCRIPTION:

Chain-Free. A spacious three bedroom terraced house situated in a popular location, easy reach of Oakthorpe Primary school, as well as bus links to Palmers Green BR station and Wood Green tube (Piccadilly line)

The ground floor benefits from a large reception room, a separate dining room, conservatory and a kitchen. The first floor provides well-proportioned bedrooms and a family bathroom.

The rear garden extends just over 62' in length, whilst at the front of the property is a wide block paved driveway. There is also the potential to extend (subject to any planning consent).

## AT A GLANCE:

- Three Bedroom Terraced House
- Chain-Free
- Close to Bus Links to Palmers Green BR Station and Wood Green Tube
- Easy Reach of Oakthorpe Primary School
- Large Reception Room
- Separate Dining Room
- Conservatory
- 62'2 Long Rear Garden
- Driveway
- Potential to Extend (subject to Planning Consent)









# Princes Avenue, N13

Approx. Gross Internal Floor Area 1124 sq. ft / 104.45 sq. m

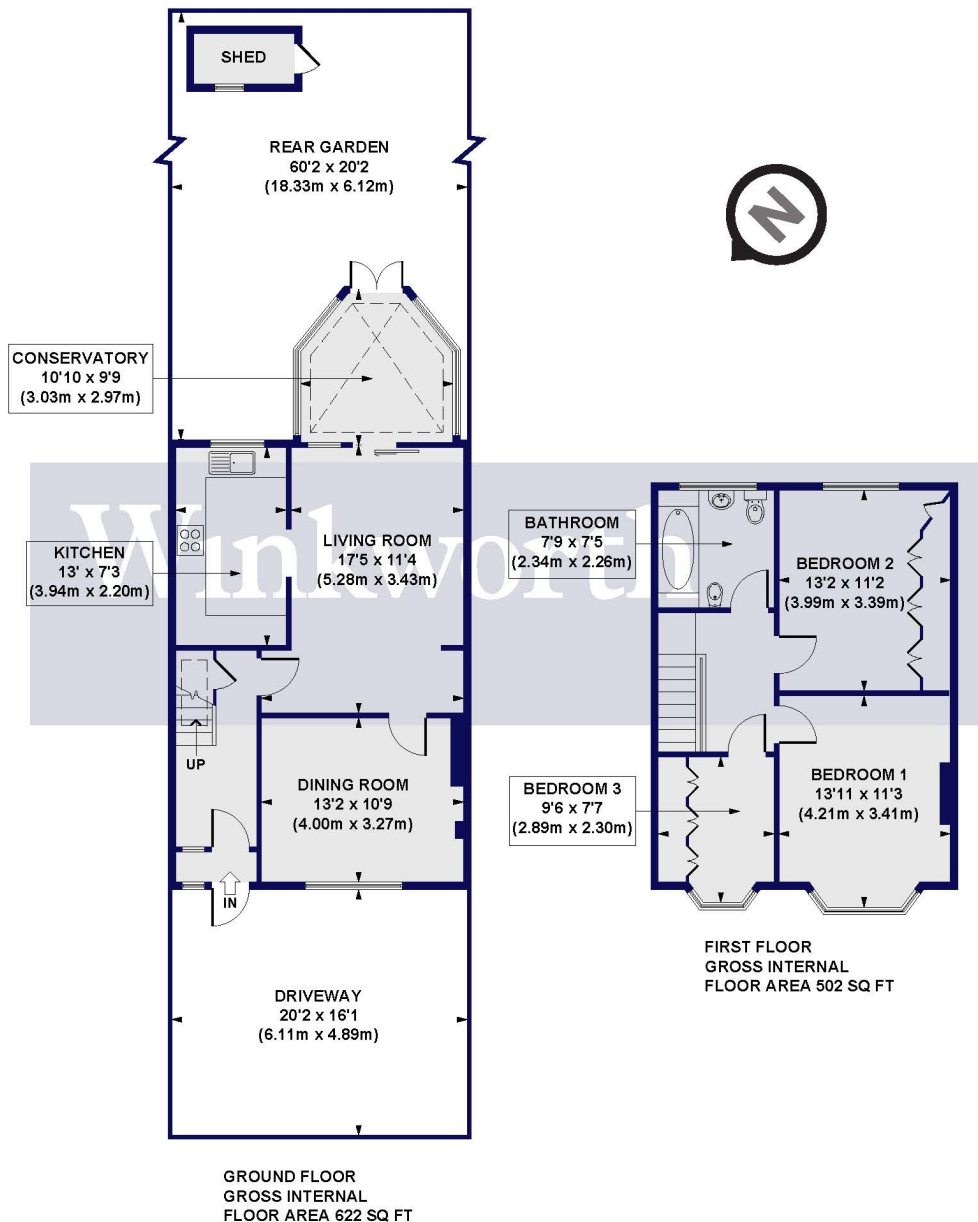

All measurements of walls, doors, windows, fittings and appliances, including their size and location, are shown as standard sizes and do not constitute any warranty or representation by the seller, their agent or CP Creative. Any intending purchaser must satisfy himself by inspection or otherwise as to the correctness of the information contained in these plans.

This floorplan is for illustration purposes only and is not to scale. The position and size of doors, windows, appliances and other features are approximate.

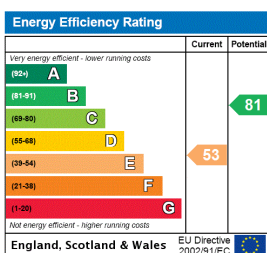

**Winkworth**

Palmers Green | 020 8920 9900 | palmersgreen@winkworth.co.uk

for every step...

[winkworth.co.uk](http://winkworth.co.uk)

Winkworth wishes to inform prospective buyers and tenants that these particulars are a guide and act as information only. All our details are given in good faith and believed to be correct at the time of printing but they don't form part of an offer or contract. No Winkworth employee has authority to make or give any representation or warranty in relation to this property. All fixtures and fittings, whether fitted or not are deemed removable by the vendor unless stated otherwise and room sizes are measured between internal wall surfaces, including furnishings.