



LOWER FLOOR, STANSTEAD ROAD, LONDON, UNITED KINGDOM, SE23
£500,000 LEASEHOLD

VICTORIAN BEAUTY WITH GARDEN, DRIVEWAY & PRIME LOCATION

Forest Hill | | foresthill@winkworth.co.uk



DESCRIPTION:

Stylish and spacious two-bedroom Victorian conversion on Stanstead Road, featuring high ceilings, period details, two double bedrooms, a modern finish throughout, private rear garden, and front driveway.



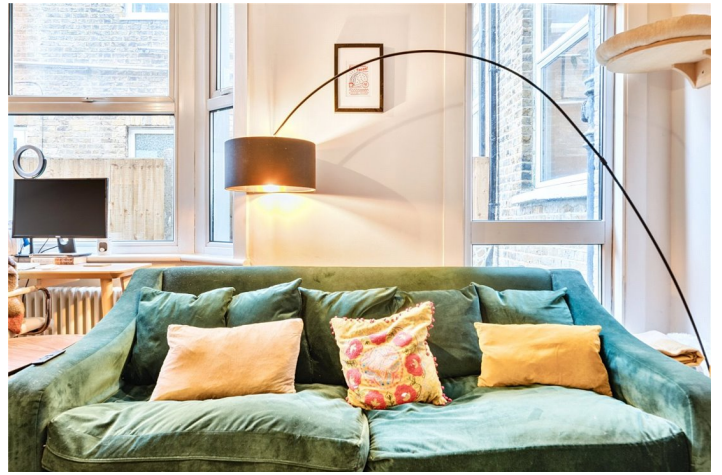

Stanstead Road, London, SE23

Approximate Area = 781 sq ft / 72.5 sq m

For identification only - Not to scale

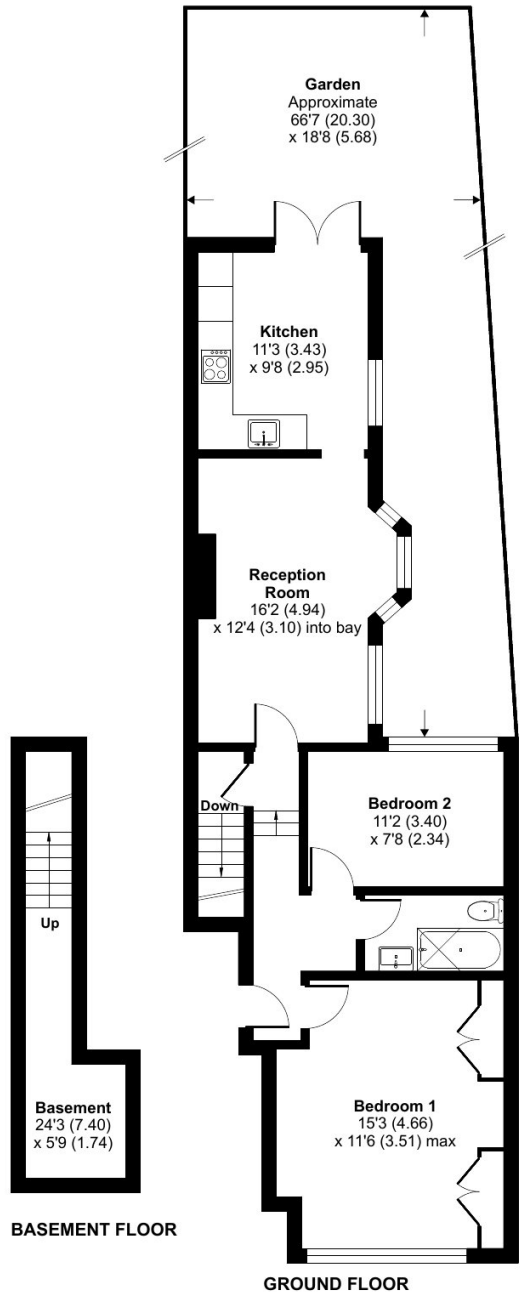

Floor plan produced in accordance with RICS Property Measurement Standards incorporating International Property Measurement Standards (IPMS2 Residential). © nlc/hecorn 2025. Produced for Winkworth Forest Hill and New Cross. REF: 1281310

This floorplan is for illustration purposes only and is not to scale. The position and size of doors, windows, appliances and other features are approximate.

Score	Energy rating	Current	Potential
92+	A		
81-91	B		
69-80	C		
55-68	D	62 D	72 C
39-54	E		
21-38	F		
1-20	G		

Tenure: Leasehold