



53 Fleur-De-Lis, Duttons Road, Romsey, Hampshire, SO51 8LH
£500,000

Winkworth



BEAUTIFUL APARTMENT IN CENTRAL ROMSEY

This is a beautiful two/three-bedroom, two-bathroom luxury retirement apartment on this exciting, highly sought after Pegasus development, in the centre of Romsey. This spacious apartment benefits from being on the top floor with views across Romsey. This spacious apartment provides an exceptional standard of independent living for those considering downsizing from a larger family home.

The 52 apartments, which are known as Fleur-de-Lis, have been built on the former council building on Duttons Road in a quiet residential area. The centre of Romsey, a historic market town is a 5-minute walk which provides an excellent range of leisure facilities and shops plus supermarkets for everyday needs. The town's library, train station and Waitrose are all within a short walk.

The property benefits from daytime Concierge management, 24-hour emergency call system, owners lounge, guest suite, fully landscaped gardens and weekly coffee mornings and other events. On-site Parking is available at a separate cost.

- All Mains Utilities
- Two separate lifts
- No Onward Chain
- Superfast Broadband Available
- Spacious shared facilities
- On-site Life host
- Fully furnished guest suite



Winkworth

Address: 53 Fleur-De-Lis, Duttons Road, Romsey, Hampshire SO51 8LH

Council Tax Band: 'B' Test Valley BC
EPC: B

Tenure: Leasehold

Ground Rent - £650 Per Annum

Service Charge - £2268.91 – Half Yearly

Lease Length – 116 Years

These details are to be confirmed by the vendor's solicitors and must be verified by a buyer's solicitor.



Second Floor
Approx. 53.1 sq. metres (571.2 sq. feet)

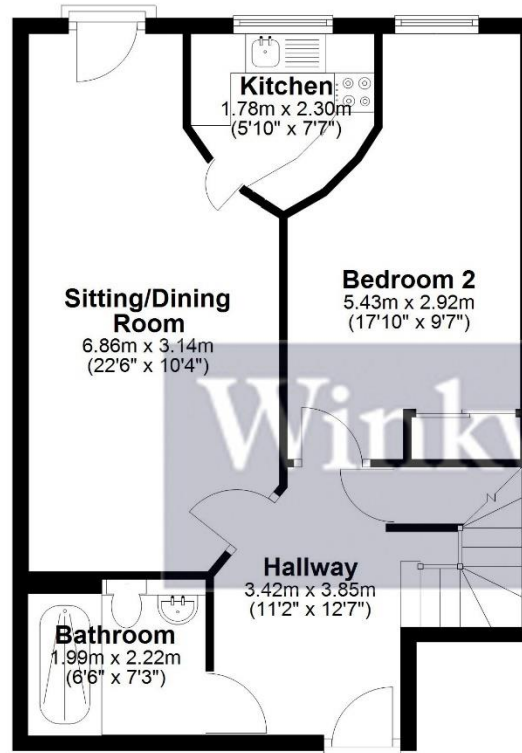

Third Floor
Approx. 54.8 sq. metres (589.8 sq. feet)

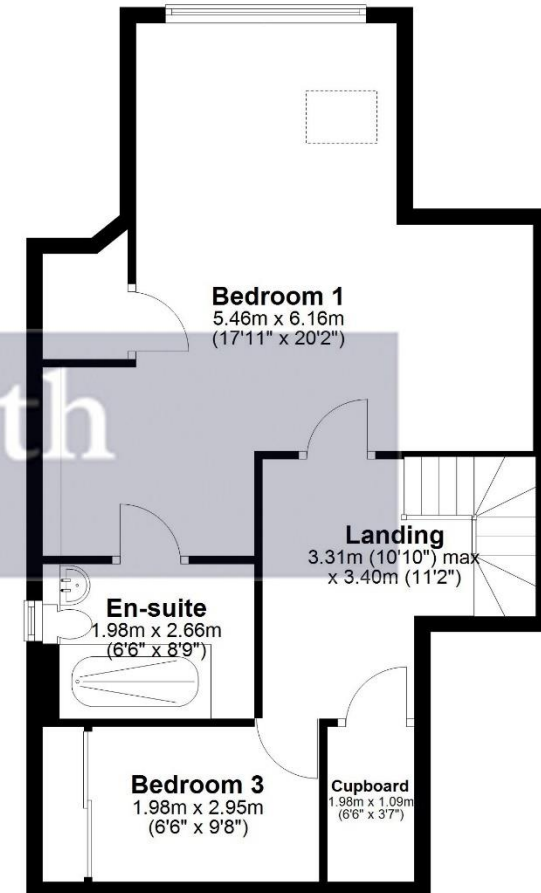

Total area: approx. 107.9 sq. metres (1161.0 sq. feet)

SIZES AND DIMENSIONS ARE APPROXIMATE, ACTUAL MAY VARY
Copywrite Ellie Mathieson Photography
Plan produced using PlanUp.

winkworth.co.uk/romsey

Winkworth Romsey

18 Market Place, Romsey, Hampshire, SO51 8NA
01794 511911 | romsey@winkworth.co.uk

winkworth.co.uk/romsey

Winkworth Winchester

2 Black Swan Buildings, Southgate Street,
Winchester, Hampshire, SO23 9DT
01962 866777 | winchester@winkworth.co.uk

Winkworth Mayfair & Country House Department

11 Berkeley Street, Mayfair, London, W1J 8DS
020 7871 0589 | countryhouse@winkworth.co.uk

Winkworth

See things differently