



MONMOUTH PLACE, W2

£850 PER WEEK (£3,683.33 PCM) FURNISHED / SHORT LET

A FANTASTIC TWO DOUBLE BEDROOM FLAT ON THE FIRST FLOOR OF THIS PERIOD BUILDING WITH PRIVATE ROOF TERRACE IN THE HEART OF NOTTING HILL.

Notting Hill Lettings | 0207 727 3227 | nottinghill@winkworth.co.uk

Winkworth

for every step...

winkworth.co.uk



DESCRIPTION:

Property comprises quiet mews entrance to the back of the building entering the flat on the first floor, open plan living room and fully fitted kitchen with doors out to a private terrace. The two bedrooms are both equal in size with fantastic ceiling height and located at the front of the building with an immaculate shower room. The property is offered furnished for short let and viewings highly recommended. Bills inclusive.

Utilities:

Electricity – Mains

Water – Mains

Sewerage – Mains

Heating – Gas

Broadband <https://checker.ofcom.org.uk/en-gb/broadband-coverage>

Mobile Coverage <https://checker.ofcom.org.uk/en-gb/mobile-coverage>

LOCATION:

Monmouth Place is located just behind Westbourne Grove, off Monmouth Road. The property is set behind secure gates and has the many fashionable boutiques and restaurants of Westbourne Grove literally at its doorstep. Queensway is also just a short walk away.



Monmouth Place, W2

Approximate gross internal area

53.42 sq m / 575 sq ft

Key :
CH - Ceiling Height

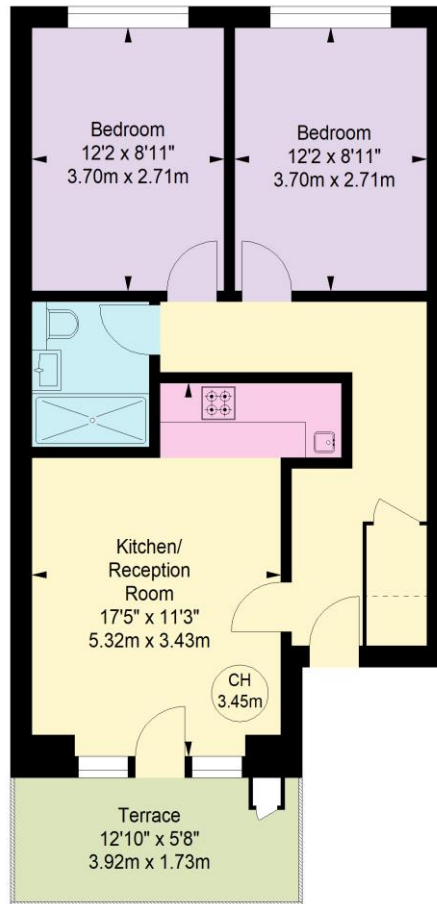

Winkworth

FIRST FLOOR

Not to scale, for guidance only and must not be relied upon as a statement of fact.
All measurements and areas are approximate only

This floorplan is for illustration purposes only and is not to scale. The position and size of doors, windows, appliances and other features are approximate.

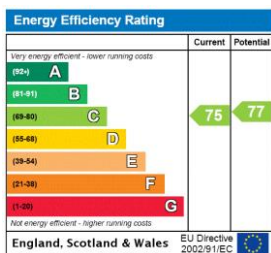

Deposit: £4,250

Holding Deposit: £850

Council Tax Band: D (Westminster)

Where no figures are shown, we have been unable to ascertain the information. All figures that are shown were correct at the time of printing.

Notting Hill Lettings | 0207 727 3227 | nottinghill@winkworth.co.uk

Winkworth

for every step...

winkworth.co.uk

Winkworth wishes to inform prospective buyers and tenants that these particulars are a guide and act as information only. All our details are given in good faith and believed to be correct at the time of printing but they don't form part of an offer or contract. No Winkworth employee has authority to make or give any representation or warranty in relation to this property. All fixtures and fittings, whether fitted or not are deemed removable by the vendor unless stated otherwise and room sizes are measured between internal wall surfaces, including furnishings.