

STREATHAM HILL, SW2
£190,000 LEASEHOLD

CHARMING STUDIO IN A GRADE II LISTED MODERNIST LANDMARK IN STREATHAM HILL

Streatham | 020 8769 6699 | streatham@winkworth.co.uk

Winkworth

for every step...

winkworth.co.uk



DESCRIPTION

Pullman Court is a striking, Grade II listed modernist building on Streatham Hill, well-known for its architectural significance. This first-floor studio apartment offers a bright and efficient living space, perfect for anyone seeking urban simplicity.

The property features a studio room with large windows, a separate kitchen, and a balcony with views of the communal gardens. The building benefits from expansive, well-maintained communal lawns, bike storage, and an active residents' association. There is also a building manager to assist residents.

Transport links are excellent, with Streatham Hill Station (Victoria in 17 minutes) within walking distance, and easy access to Brixton, Tulse Hill, and Clapham. Limited shared parking spaces are available for hire through arrangement with the block management.

Offered without an ongoing chain, this property is ready for a swift and smooth sale.



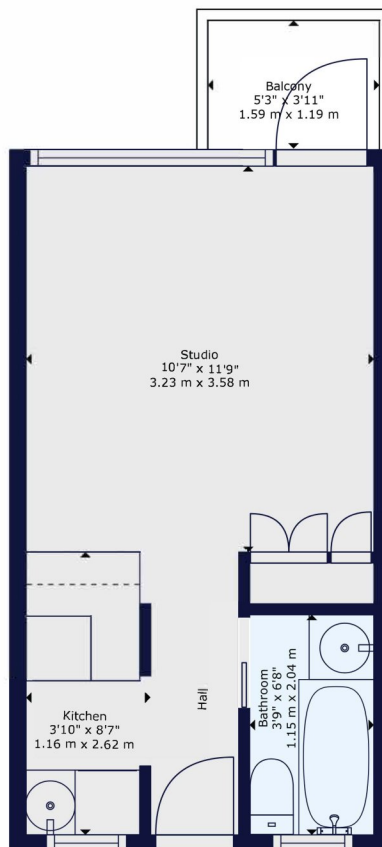

Winkworth

TOTAL: 216 sq. ft, 20 m²
FLOOR 1: 216 sq. ft, 20 m²
EXCLUDED AREAS: BALCONY: 21 sq. ft, 2 m²

All measurements of walls, doors, windows, fittings and appliances, including their size and location, are shown as standard sizes and do not constitute any warranty or representation by the seller, their agent or Winkworth. Any intending purchaser must satisfy himself by inspection or otherwise.



This floorplan is for illustration purposes only and is not to scale. The position and size of doors, windows, appliances and other features are approximate.

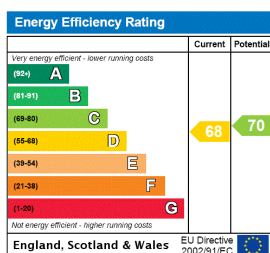

Tenure: Leasehold

Term: 166 year and 8 months

Service Charge: £1200 per annum

Ground Rent: £ 50 Annually (subject to increase)

Council Tax Band: A

Where no figures are shown, we have been unable to ascertain the information. All figures that are shown were correct at the time of printing.

Winkworth

Streatham | 020 8769 6699 | streatham@winkworth.co.uk

for every step...

winkworth.co.uk

Winkworth wishes to inform prospective buyers and tenants that these particulars are a guide and act as information only. All our details are given in good faith and believed to be correct at the time of printing but they don't form part of an offer or contract. No Winkworth employee has authority to make or give any representation or warranty in relation to this property. All fixtures and fittings, whether fitted or not are deemed removable by the vendor unless stated otherwise and room sizes are measured between internal wall surfaces, including furnishings.