



THE ORCHARD, BRAMLING, CANTERBURY, CT3
£950,000 FREEHOLD

Canterbury | 01227 456 645 | canterbury@winkworth.co.uk



for every step...

winkworth.co.uk



DESCRIPTION:

A fantastic modern eco-friendly property which has been lovingly refurbished and extended by the current owners and has a superb finish with a real wow factor. Located in AONB with a plot of just under an acre in the popular hamlet of Bramling



Winkworth

for every step...



Winkworth

for every step...

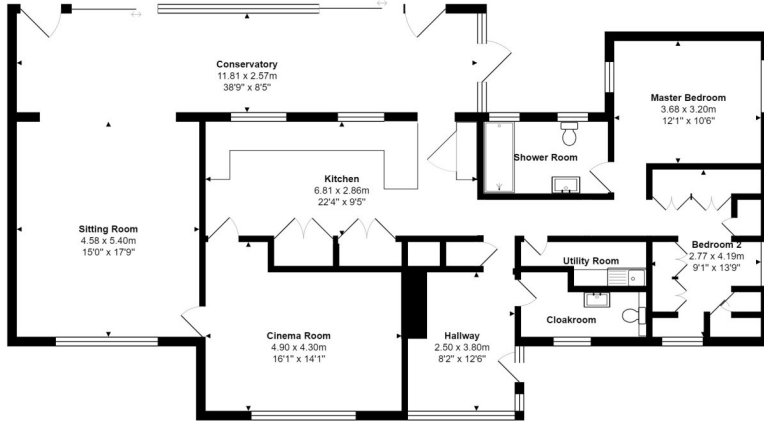
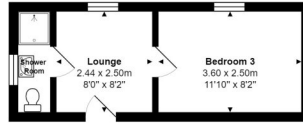
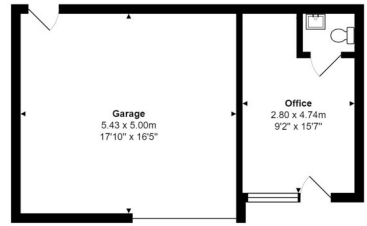

Ground Floor

Total Area: 212.6 m² ... 2289 ft²

Measurements of doors, windows and rooms and any other item are approximate and no responsibility is taken for any error, omission or mis-statement. This plan is for illustrative purpose only.

This floorplan is for illustration purposes only and is not to scale. The position and size of doors, windows, appliances and other features are approximate.

Energy Efficiency Rating		Current	Potential
Very energy efficient - lower running costs			
(92-)	A	104	108
(81-91)	B		
(69-80)	C		
(55-68)	D		
(39-54)	E		
(21-38)	F		
(1-20)	G		
Not energy efficient - higher running costs			
England, Scotland & Wales		EU Directive 2002/91/EC	

Canterbury | 01227 456 645 | canterbury@winkworth.co.uk



for every step...

winkworth.co.uk

Winkworth wishes to inform prospective buyers and tenants that these particulars are a guide and act as information only. All our details are given in good faith and believed to be correct at the time of printing but they don't form part of an offer or contract. No Winkworth employee has authority to make or give any representation or warranty in relation to this property. All fixtures and fittings, whether fitted or not are deemed removable by the vendor unless stated otherwise and room sizes are measured between internal wall surfaces, including furnishings.