



GROVE VALE, EAST DULWICH, SE22
OFFERS IN EXCESS OF £350,000 LEASEHOLD

A GREAT ONE-BEDROOM FLAT, IN AN ENVIABLE LOCATION IN EAST DULWICH.

DESCRIPTION:

A great one-bedroom flat, in an enviable location in East Dulwich. The accommodation consists of one double bedroom, a large open plan kitchen reception with new integrated appliances and modern bathroom. Also benefitting from a large communal roof terrace. The property is in a superb location right in the middle of East Dulwich close to East Dulwich train station with links into central London. Also, easy access into local bars, restaurants and pubs and everything East Dulwich has to offer. Perfect for a first-time buyer or rental investor. This is a must see flat.

AT A GLANCE

- One Bedroom Flat
- Open-plan Kitchen-Reception
- Fully-fitted Kitchen
- Modern Bathroom
- Communal Roof Terrace
- Close to East Dulwich Station

Dulwich | 020 8299 2722 | dulwich@winkworth.co.uk

Winkworth





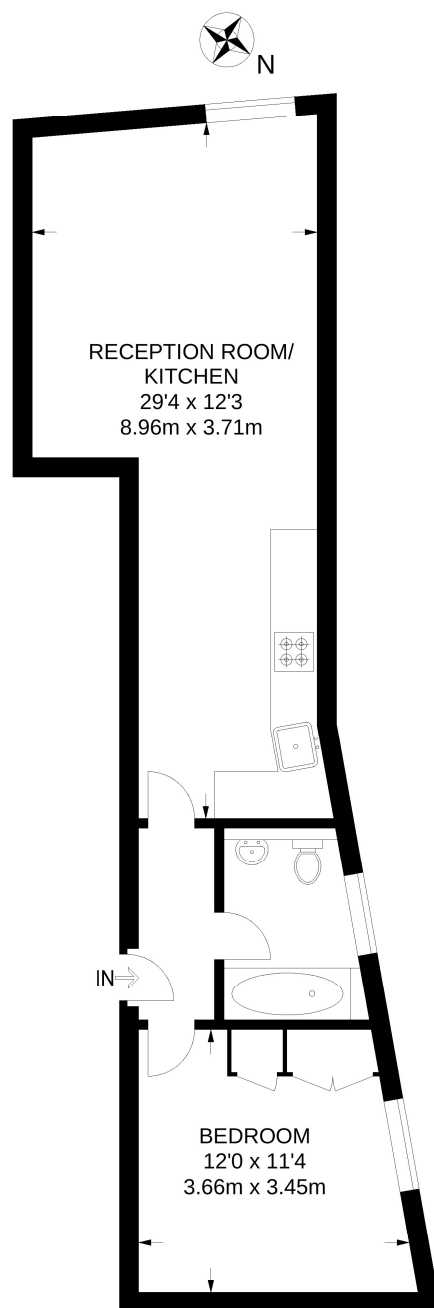

SECOND FLOOR

**APPROXIMATE GROSS INTERNAL AREA
504 SQ FT / 46.8 SQ M**

This floorplan is for illustration purposes only and is not to scale. The position and size of doors, windows, appliances and other features are approximate.

Energy Efficiency Rating	
	Current Potential
Very energy efficient - lower running costs	
(92-100) A	
(81-91) B	
(69-80) C	77 79
(55-68) D	
(39-54) E	
(21-38) F	
(1-20) G	
Not energy efficient - higher running costs	
England, Scotland & Wales EU Directive 2002/91/EC	

Dulwich | 020 8299 2722 | dulwich@winkworth.co.uk

Winkworth

winkworth.co.uk

See things differently

Winkworth wishes to inform prospective buyers and tenants that these particulars are a guide and act as information only. All our details are given in good faith and believed to be correct at the time of printing but they don't form part of an offer or contract. No Winkworth employee has authority to make or give any representation or warranty in relation to this property. All fixtures and fittings, whether fitted or not are deemed removable by the vendor unless stated otherwise and room sizes are measured between internal wall surfaces, including furnishings.