



Winkworth



Winkworth



Winkworth

THE REDDINGS, BOREHAMWOOD, HERTFORDSHIRE, WD6

£355,000 LEASEHOLD

**AN IMMACULATELY PRESENTED TWO BEDROOM
GROUND FLOOR FLAT.**

Borehamwood | 020 8953 8899 | borehamwood@winkworth.co.uk



DESCRIPTION:

Having been subject to an extensive schedule of refurbishment and improvement this two bedroom ground floor purpose built flat is immaculately presented throughout.

Benefitting from a southerly facing balcony and covered parking space the flat is located in a quiet sought after turning a short distance from Borehamwood town centre and Thameslink station and would be ideal for a first time buyer or downsizer.

AT A GLANCE

- 2 Bedrooms
- Southerly Facing Balcony
- Communal Gardens
- Car Port
- 959 Year Lease
- Double Glazed
- Gas Central Heating





Winkworth



Winkworth



Winkworth



Winkworth



Winkworth

Approximate Gross Internal Area = 57.6 sq m / 620.5 sq ft

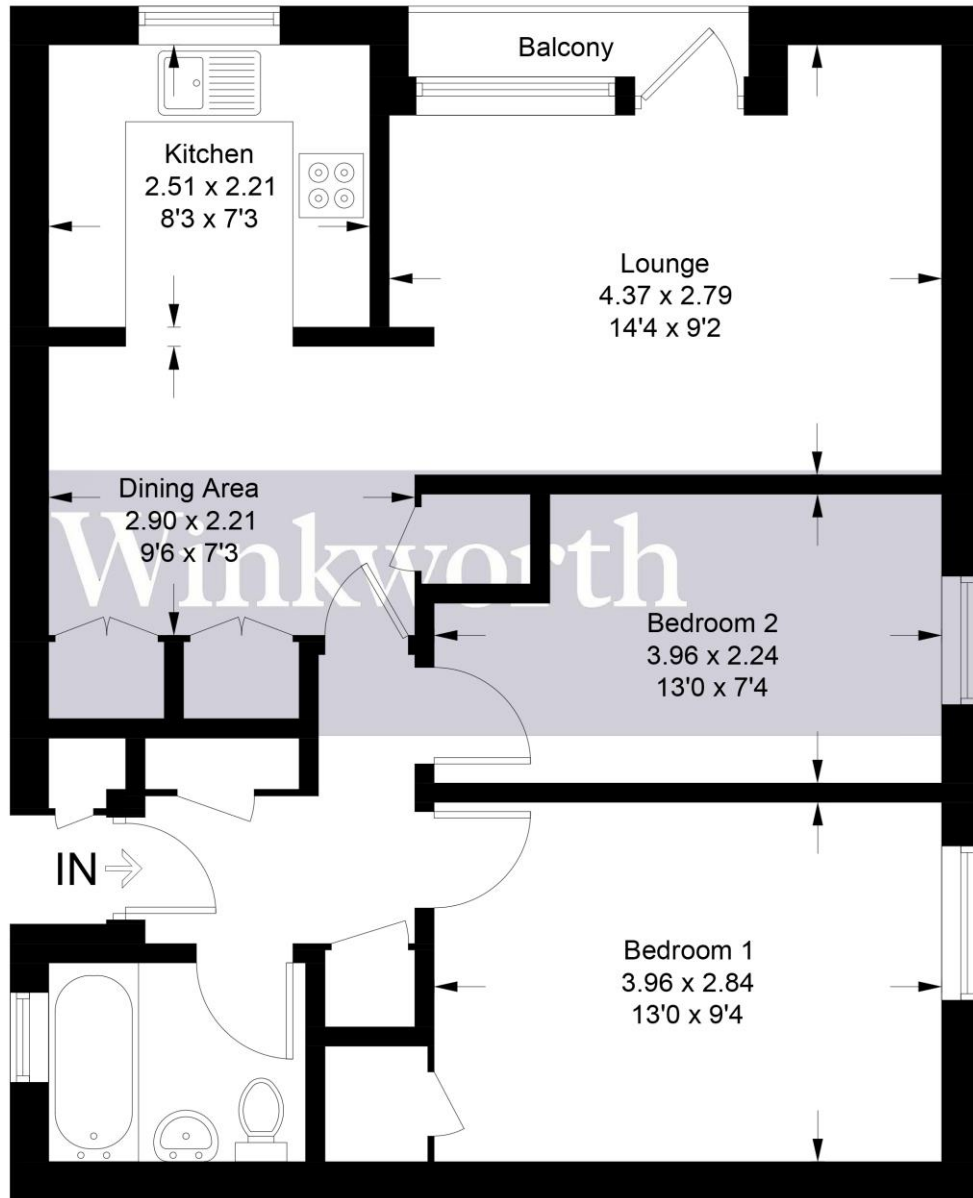

First Floor

Illustration for identification purposes only, measurements are approximate, not to scale. Winkworth © 2024 (ID1056331)

This floorplan is for illustration purposes only and is not to scale. The position and size of doors, windows, appliances and other features are approximate.

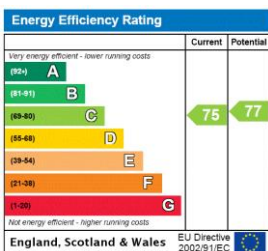

Tenure: Leasehold

Term: 957 year and 4 months

Service Charge: £1380 per annum

Ground Rent: £ 0 Annually (subject to increase)

Council Tax Band:

Where no figures are shown, we have been unable to ascertain the information. All figures that are shown were correct at the time of printing.