



**WESTGROVE LANE, GREENWICH, LONDON, SE10**  
**GUIDE PRICE £650,000-£675,000 LEASEHOLD**

**RARE TO THE MARKET IS THIS FULLY REFURBISHED LOWER GROUND FLOOR GARDEN FLAT, THAT MEASURES CIRCA 817 SQ FT AND IS PART OF THIS STUNNING GRADE II HOUSE, THAT SITS PERFECTLY JUST MOMENTS FROM THE OPEN HEATH AND ROYAL PARK.**

Greenwich | 02030533033 | greenwich@winkworth.co.uk

**Winkworth**

*winkworth.co.uk*

See things differently





## DESCRIPTION:

Guide Price £650,000-675,000. Rare to the market is this fully refurbished lower ground floor garden flat, that measures circa 817 sq ft and is part of this stunning Grade II house, that sits perfectly just moments from the open heath and Royal Park.

In very good order throughout the property comprising a 24ft reception room which then leads onto a good sized private garden. There is a newly fitted kitchen just off the entrance hallway and two double bedrooms, plus a newly fitted family bathroom. The front bedroom also leads onto a smaller front private patio area. Currently vacant, there is no chain.

Westgrove Lane is without doubt one of the best locations in Greenwich, and arguably the whole of the southeast. A private road, It sits just on the cusp of Greenwich and Blackheath, just seconds from the heath and park, but also just a short walk to the town centre, which offers a fantastic array of shops and restaurants, along with mainline rail, DLR and riverboat service.

## AT A GLANCE

- two bedroom garden flat
- grade II listed building
- lower ground floor
- recently refurbished
- new kitchen and bathroom
- circa 817 sq ft
- large private patiod garden
- borders of Blackheath and Greenwich
- near perfect location
- moments from The Point

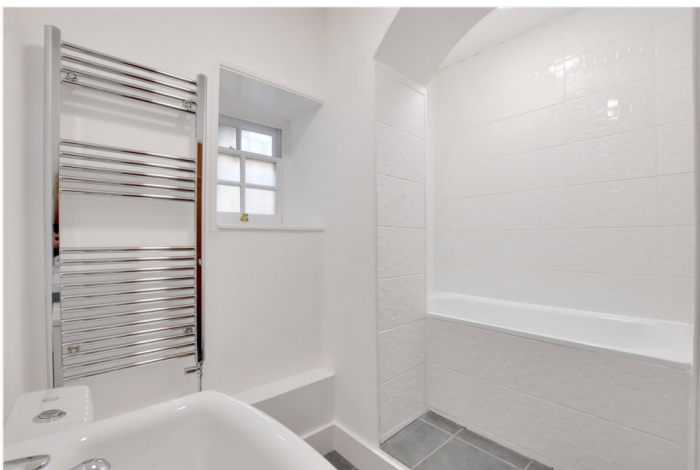





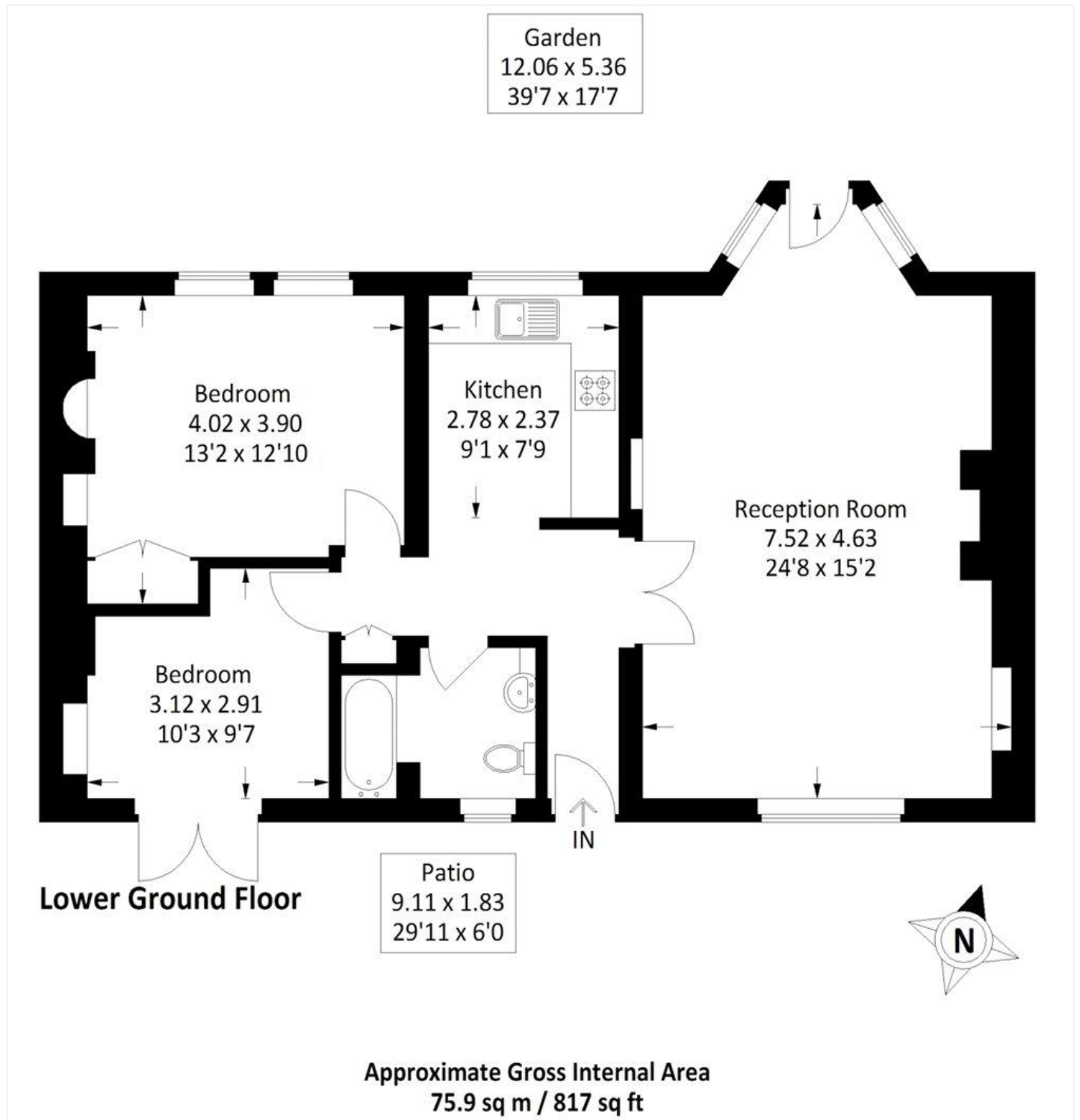

This floorplan is for illustration purposes only and is not to scale. The position and size of doors, windows, appliances and other features are approximate.

Greenwich | 02030533033 | greenwich@winkworth.co.uk



winkworth.co.uk

See things differently

Winkworth wishes to inform prospective buyers and tenants that these particulars are a guide and act as information only. All our details are given in good faith and believed to be correct at the time of printing but they don't form part of an offer or contract. No Winkworth employee has authority to make or give any representation or warranty in relation to this property. All fixtures and fittings, whether fitted or not are deemed removable by the vendor unless stated otherwise and room sizes are measured between internal wall surfaces, including furnishings.