



Pembridge Gardens, W2

£4,000,000 *Share of Freehold*



AN EXQUISITELY PRESENTED COLLECTION OF FIVE, THREE-BEDROOM, APARTMENTS SPANNING THE WIDTH OF THIS IMPOSING DETACHED VILLA, IN THIS INCREDIBLY CONVENIENT NOTTING HILL LOCATION.



Notting Hill Sales

0207 727 3227 | nottinghill@winkworth.co.uk

Winkworth

for every step...



Having undergone a painstaking and extensive refurbishment this wonderful period building comes to the market combining, period charm but an entirely new finish of fixtures and fittings throughout. Particular features include; Ted Todd parquet flooring throughout, under-floor heating and air conditioning to (Second and Third floor flats), replaced double-glazed timber sash windows and bespoke joinery throughout. Each bathroom has been designed for pure luxury. The in-frame kitchens fitted with Devol brassware, Miele appliances and Italian marble worktops.

Flat 5 situated on the first floor and benefits from direct lift access and also benefits from a demised 500 sq.ft terrace.

Pembridge Gardens is a highly sought-after and imposing residential street, holding an ideal position running north from Pembridge Villas, between the many transport links of Notting Hill Gate and the boutiques and restaurants of Westbourne Grove.





MATERIAL INFO

Tenure: Share of Freehold
Service Charge: £0 per annum
Ground Rent: £ 0 Annually (subject to increase)
Council Tax Band: G (RBKC)
EPC rating: To be confirmed

Approx. Gross Internal Area 1575 Sq Ft - 146.32 Sq M

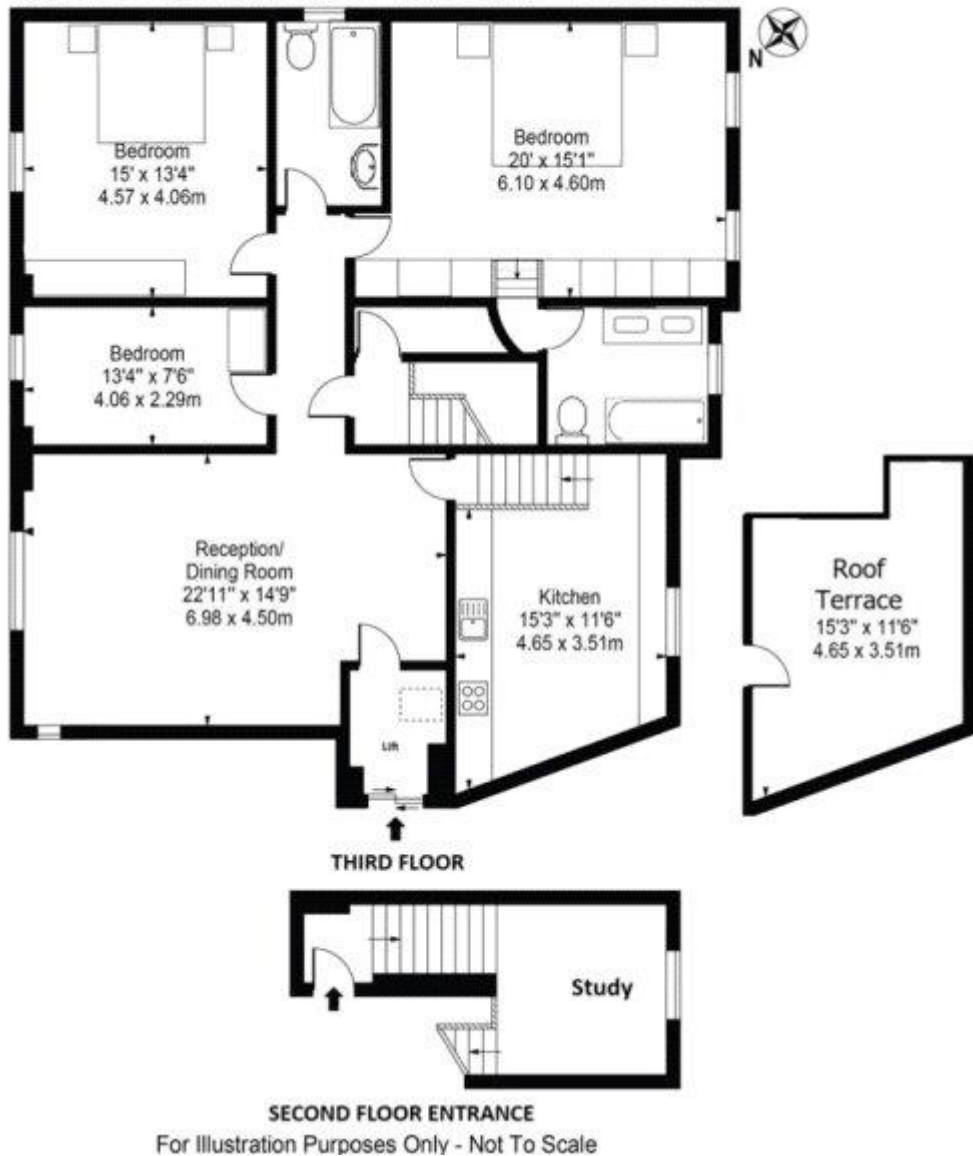

For more information, scan the QR code or visit the link below

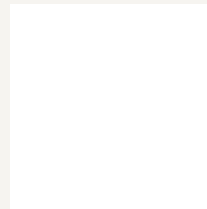

<https://www.winkworth.co.uk/sale/property/NHS250023>

Where no figures are shown, we have been unable to ascertain the information. All figures that are shown were correct at the time of printing.

Notting Hill Sales

0207 727 3227 | nottinghill@winkworth.co.uk

Winkworth

for every step...

Winkworth wishes to inform prospective buyers and tenants that these particulars are a guide and act as information only. All our details are given in good faith and believed to be correct at the time of printing but they don't form part of an offer or contract. No Winkworth employee has authority to make or give any representation or warranty in relation to this property. All fixtures and fittings, whether fitted or not are deemed removable by the vendor unless stated otherwise and room sizes are measured between internal wall surfaces, including furnishings.