



MERTON ROAD, LONDON, SW18
£1,650 PER MONTH UNFURNISHED

A charming one bedroom flat with a south west facing patio on Merton Road in Southfields

SUMMARY:

This well-presented property extends to approximately 500 sq ft. Towards the front is a generous double bedroom with a built-in wardrobe and bright bay window. At the rear is a cosy reception room with a kitchen/dining area and floor to ceiling sliding doors which open onto a sunny private patio with astroturf. There is also a bathroom with bath and shower over. Merton Road is well located just moments from the green open space of King George's Park. Southfields Underground Station (District Line) and Earlsfield Station (mainline into Waterloo via Clapham Junction) offer excellent transport links. There are also several good pubs, shops and restaurants nearby.

Southfields | 020 8877 1000

241 Wimbledon Park Road, Southfields, London, SW18 5RJ

Tenant Fees Apply: Details of fees for tenant referencing, tenancy agreement admin fees and renewal fees are available on the Winkworth website and the link can be found with the displayed rent for the property. Tenants should ensure they are fully conversant with these upfront fees and other costs that are involved at the outset of the tenancy before making an offer to rent and your local Winkworth office will provide written details upon request.

winkworth.co.uk

Winkworth

for every step...





ACCOMMODATION

Long Let, 1 Bedrooms, 1 Reception Rooms, 1 Bathrooms, Flat/Apartment, Basement, Patio, Residents Parking, Unfurnished, 496 Approx Sq Ft

Merton Road, SW18
Approx. Gross Internal Floor Area 496 sq. ft / 46.12 sq. m

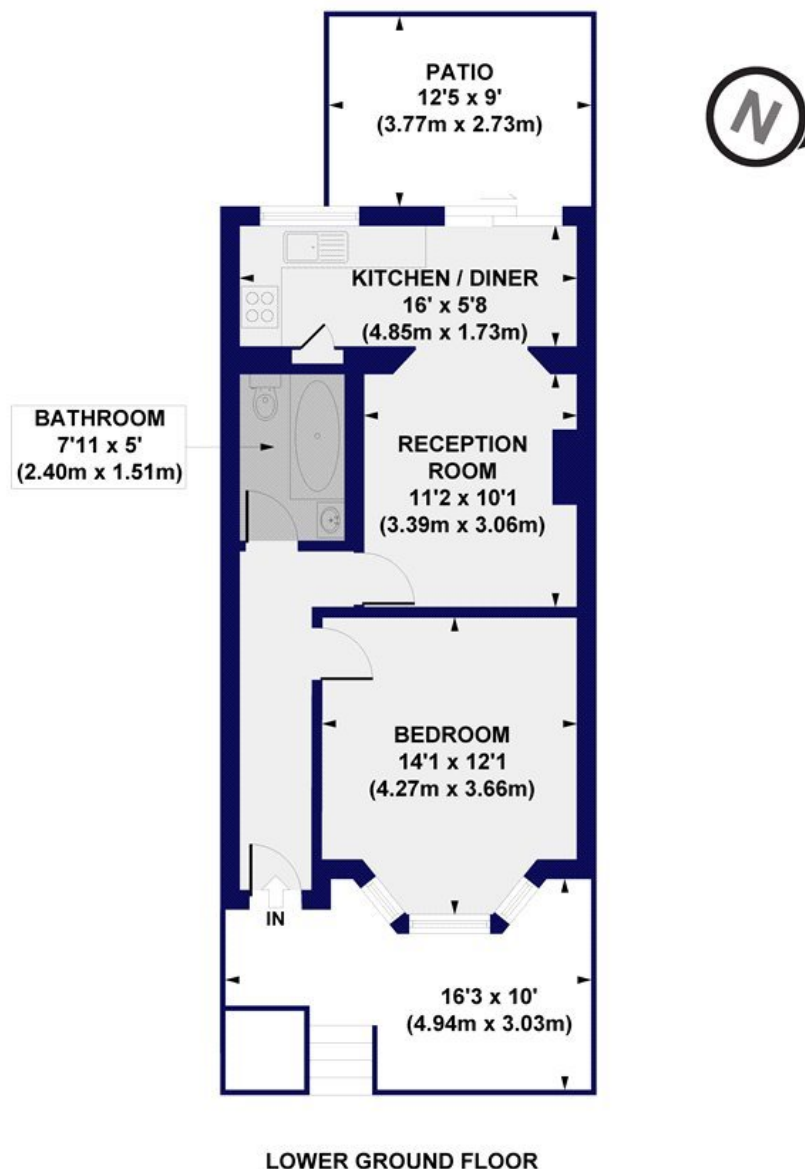

All measurements of walls, doors, windows, fittings and appliances, including their size and location, are shown as standard sizes and do not constitute any warranty or representation by the seller, their agent or CP Creative. Any intending purchaser must satisfy himself by inspection or otherwise as to the correctness of the information contained in these plans. This plan is for illustrative purposes only and should be used as such by any prospective purchasers.

Winkworth

This floorplan is for illustration purposes only and is not to scale. The position and size of doors, windows, appliances and other features are approximate.

Deposit: 5 weeks rent

Council Tax Band: C

Where no figures are shown, we have been unable to ascertain the information. All figures that are shown were correct at the time of printing.

Southfields | 020 8877 1000 | southfields@winkworth.co.uk
241 Wimbledon Park Road, Southfields, London, SW18 5RJ

Winkworth

for every step...

winkworth.co.uk

Winkworth wishes to inform prospective buyers and tenants that these particulars are a guide and act as information only. All our details are given in good faith and believed to be correct at the time of printing but they don't form part of an offer or contract. No Winkworth employee has authority to make or give any representation or warranty in relation to this property. All fixtures and fittings, whether fitted or not are deemed removable by the vendor unless stated otherwise and room sizes are measured between internal wall surfaces, including furnishings.