



# Malta Close

Popley Basingstoke RG24 9PD

## Description

This three bedroom terraced house offers plenty of space and benefits from a south facing rear garden.

It has an enclosed entrance porch at the front and this has a very handy walk-in storage cupboard. There are two reception rooms – a living and dining room with the kitchen to the front.

Completing the ground floor is the cloakroom and a deep under stairs storage cupboard.

The first floor has three bedrooms (two doubles and a single) and a bathroom.

Heading outside there is an open plan lawn at the front and an enclosed south facing garden with a timber shed at the rear.

There are non allocated parking spaces at the end of the terrace.



**Winkworth**

# Accommodation

- Porch
- Hallway
- Cloakroom
- Living room
- Dining room
- Kitchen
- Three bedrooms
- Bathroom
- Gardens
- Non allocated parking spaces

Under the Property Misdescriptions Act 1991, these Particulars are a guide and act as information only. All details are given in good faith and are believed to be correct at time of printing. Winkworth give no representation as to their accuracy and potential purchasers or tenants must satisfy themselves by inspection or otherwise as to their correctness. No employee of Winkworth has authority to make or give any representation or warranty in relation to this property.

Energy Efficiency Rating		Current	Potential
Very energy efficient - lower running costs			
(92-100)	A		84
(81-91)	B		
(69-80)	C		
(55-68)	D	57	
(39-54)	E		
(21-38)	F		
(1-20)	G		
Not energy efficient - higher running costs			
England, Scotland & Wales		EU Directive 2002/91/EC	

GROUND FLOOR  
478 sq.ft. (44.4 sq.m.) approx.

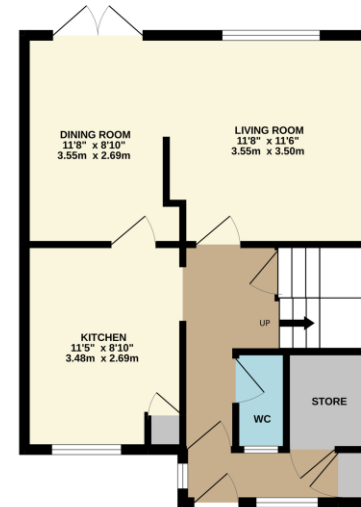

1ST FLOOR  
447 sq.ft. (41.5 sq.m.) approx.

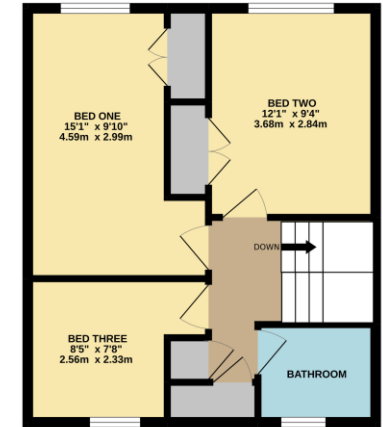

TOTAL FLOOR AREA - 926 sq.ft. (86.0 sq.m.) approx.  
Whilst every attempt has been made to ensure the accuracy of the floorplan contained here, measurements of doors, windows, rooms and any other items are approximate and no responsibility is taken for any error, omission or mis-statement. This plan is for illustrative purposes only and should be used as such by any prospective purchaser. The services, systems and appliances shown have not been tested and no guarantee as to their operability or efficiency can be given.  
Made with Metropix C5022



## Basingstoke Office

10B Church Street, Basingstoke, Hampshire, RG21 7QE  
01256 811730 | basingstoke@winkworth.co.uk  
[winkworth.co.uk/Basingstoke](http://winkworth.co.uk/Basingstoke)



See things differently.