



PRINCES AVENUE, LONDON, N3
£320,000 LEASEHOLD

**A ONE BEDROOM FLAT SET IN A PERIOD
STYLE BUILDING ON A PRIME N3 LOCATION**

Finchley | 020 8349 3388 | finchley@winkworth.co.uk



Winkworth

DESCRIPTION:

Set in a prime location off Ballards Lane within close proximity to Victoria Park, shops, local amenities and transport links, including Finchley Central underground, we are delighted to offer to the market a one bedroom flat set in a period building. The property comprises of a double bedroom, reception room, kitchen, shower room and separate wc. The flat is set on the first floor and requires updating throughout but has the potential to be made into a lovely property and would be ideal for a first time buyer or buy to let investment.

Offered on a chain free basis.

COUNCIL TAX:

Band C - £1511.99 per annum

AT A GLANCE

- Prime location
- Set in a period building
- One bedroom
- Reception Room
- First Floor
- Shower room
- Long lease
- Chain free





Princes Avenue, N3
Approx. Gross Internal Floor Area 463 sq. ft / 42.99 sq. m

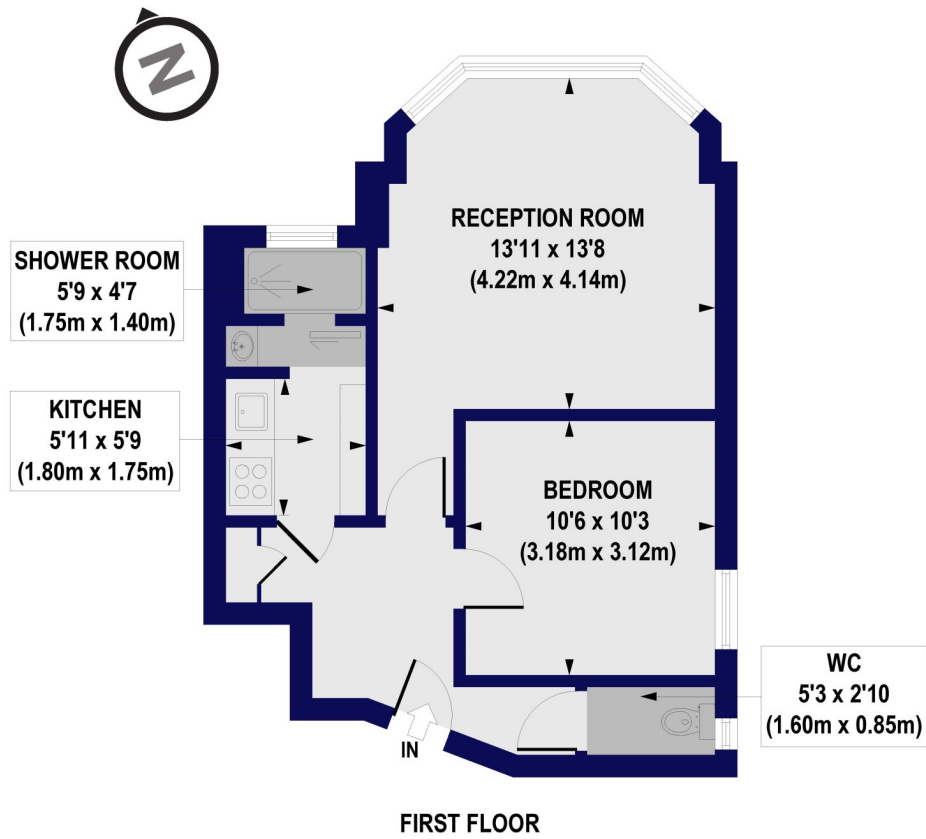

All measurements of walls, doors, windows, fittings and appliances, including their size and location, are shown as standard sizes and do not constitute any warranty or representation by the seller, their agent or CP Creative. Any intending purchaser must satisfy himself by inspection or otherwise as to the correctness of the information contained in these plans. This plan is for illustrative purposes only and should be used as such by any prospective purchasers.

Winkworth

