



**ATRIUM APARTMENTS, LONDON, W10**  
**£1,795 PER MONTH FURNISHED**

**A FANTASTIC MODERN ONE BEDROOM FLAT  
IN THIS WONDERFUL NEW BUILD BUILDING  
WITH PORTER**

North Kensington | 020 7792 5000 | northkensington@winkworth.co.uk

**Winkworth**

for every step...

*winkworth.co.uk*



### DESCRIPTION:

A stylish one bedroom apartment which forms part of a modern development in Ladbroke Grove.

The 398 sq. ft. apartment includes a fully integrated kitchen, bespoke made wardrobes and access to a private garden. Additional benefits include a parking space, concierge and large communal gardens.

The development is located close the trendy Golborne Road and Portobello Road and within walking distance of Ladbroke Grove Underground Station (Hammersmith & City & Circle lines). EPC Rating B

### AT A GLANCE

- MODERN
- PRIVATE GARDEN
- PATIO
- PARKING
- STUNNING DEVELOPMENT







## WEST ROW, W10

Approx. Gross Internal Floor Area

**398 Sq. ft/36.98 Sq. m**

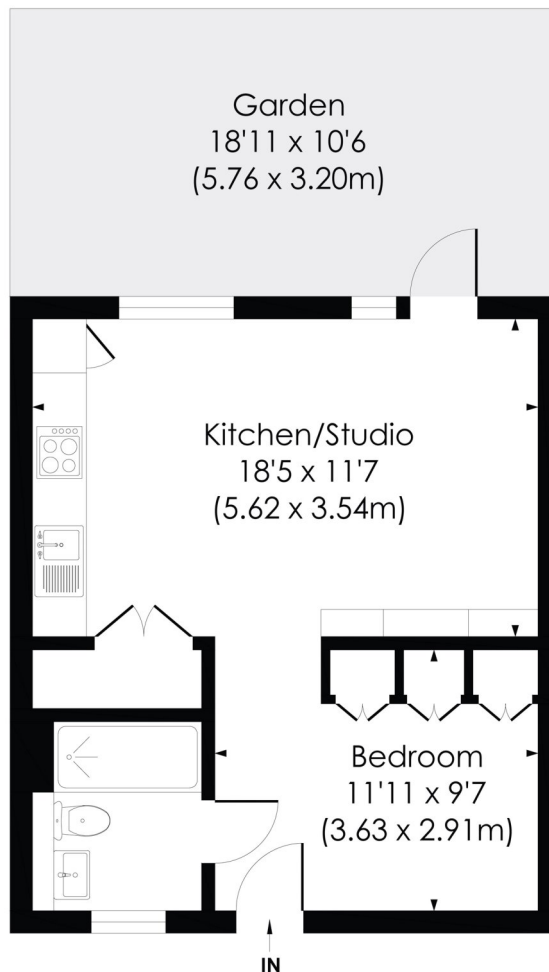
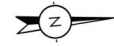

GROUND FLOOR

© Pixangle Property Marketing Ltd. info@pixangle.com Tel: 0208 870 2118

pixangle  
PROPERTY MARKETING

This floor plan has been prepared for the purpose of illustration only in accordance with the latest RICS code of measuring practice and is not to scale. All measurements and areas are approximate and whilst every effort has been made to ensure the accuracy of the plan contained here, no responsibility is taken for any error, omission or misstatement.

This floorplan is for illustration purposes only and is not to scale. The position and size of doors, windows, appliances and other features are approximate.

Energy Efficiency Rating		
	Current	Potential
Very energy efficient - lower running costs		
(92+) <b>A</b>		
(81-91) <b>B</b>		
(69-80) <b>C</b>	81	81
(55-68) <b>D</b>		
(39-54) <b>E</b>		
(21-38) <b>F</b>		
(1-20) <b>G</b>		
Not energy efficient - higher running costs		
England, Scotland & Wales	EU Directive 2002/91/EC	

North Kensington | 020 7792 5000 | northkensington@winkworth.co.uk

# Winkworth

for every step...

winkworth.co.uk

Winkworth wishes to inform prospective buyers and tenants that these particulars are a guide and act as information only. All our details are given in good faith and believed to be correct at the time of printing but they don't form part of an offer or contract. No Winkworth employee has authority to make or give any representation or warranty in relation to this property. All fixtures and fittings, whether fitted or not are deemed removable by the vendor unless stated otherwise and room sizes are measured between internal wall surfaces, including furnishings.