



LOOP COURT, GREENWICH, LONDON, SE10
£365,000 LEASEHOLD

WE ARE DELIGHTED TO OFFER THIS FANTASTIC ONE-BEDROOM APARTMENT THAT MEASURES CIRCA 532 SQUARE FOOT, AND IS FOUND ON THE 3RD FLOOR, JUST MOMENTS FROM GREENWICH PARK AND THE RIVER. EWS1 COMPLIANT!

Greenwich | 02030533033 | greenwich@winkworth.co.uk

Winkworth

DESCRIPTION:

We are delighted to offer this fantastic one-bedroom apartment that measures circa 532 square foot, and is found on the 3rd floor, just moments from Greenwich Park and the River. EWS1 COMPLIANT!

In stunning order throughout, the property comprises a welcoming hallway that leads to a smartly laid out open plan 18ft Kitchen that is fully integrated, with Amtico flooring leading to the spacious Living area. There is a large 11ft covered balcony which is accessible from both living room and bedroom. The master bedroom has built in wardrobe storage. From the hallway there is also a well fitted Bathroom and ample storage. Added features include 24 hour concierge, gymnasium onsite and beautiful communal gardens. There is also underfloor heating and an air ventilation system.

Enderby Wharf is one of Greenwich’s premier new riverside developments, and is well located, moments from the river walk, the peninsula, O2, Jubilee Line and mainline rail at Maze Hill. Greenwich town centre and the Royal Park is also a short walk away and offers an excellent array of shops and restaurants.

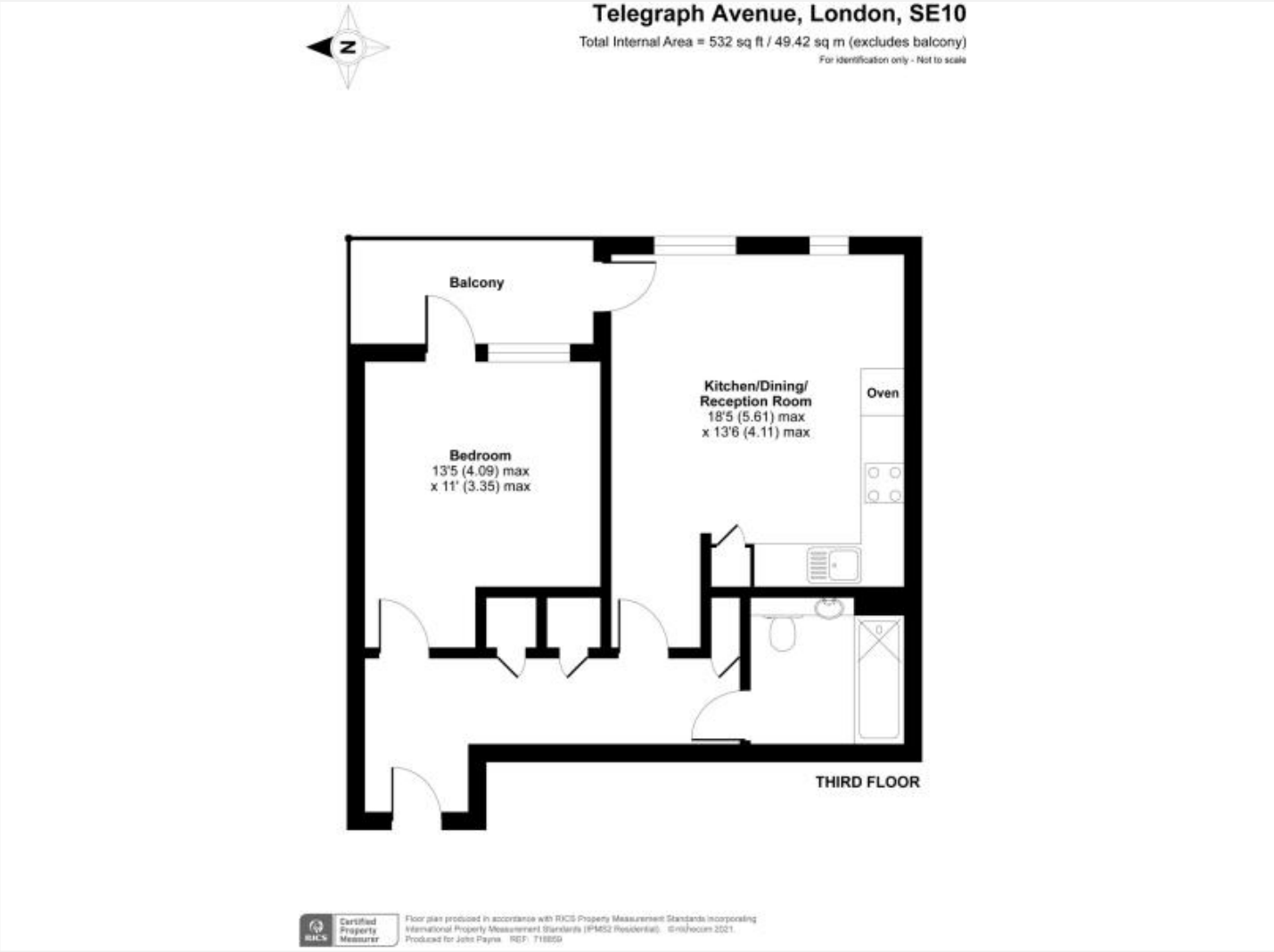

This floorplan is for illustration purposes only and is not to scale. The position and size of doors, windows, appliances and other features are approximate.

