



# Churchill Place

Basingstoke RG21 7ES

## Description

This one bedroom duplex style apartment is set on the 13<sup>th</sup> floor of this centrally located apartment block, with far reaching views out over the town to the countryside beyond.

It is furnished and on the lower level has a stylish kitchen area with integrated appliances including an inset hob, built-in oven, dishwasher, washer/drier and fridge/freezer. There is also a contemporary styled shower room with a large shower cubicle.

The upper level has a double sized bedroom with storage space.

The property does not have any parking.



**Winkworth**

## Accommodation

Entrance hall  
Kitchen/living room  
Shower room  
Double bedroom  
Storage space  
Furnished

All details are given in good faith and are believed to be correct at time of printing. Winkworth give no representation as to their accuracy and potential purchasers or tenants must satisfy themselves by inspection or otherwise as to their correctness. No employee of Winkworth has authority to make or give any representation or warranty in relation to this property.

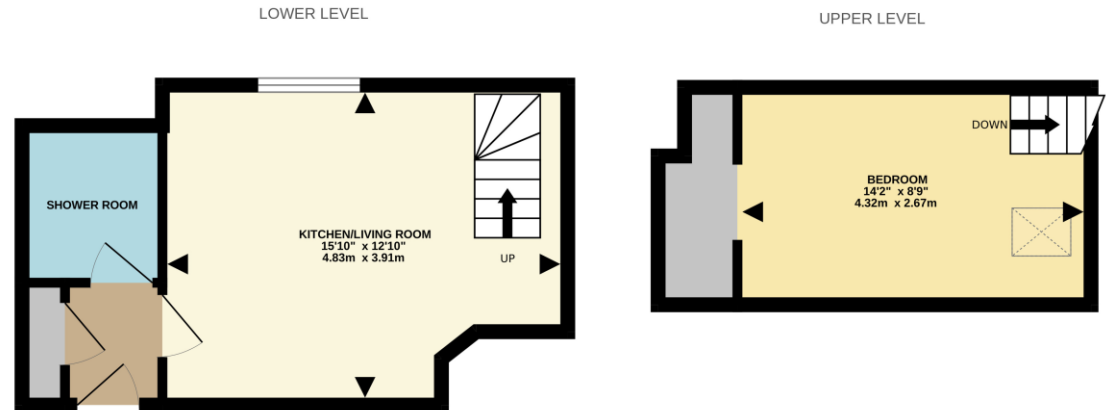

Score	Energy rating	Current	Potential
92+	A		
81-91	B		
69-80	C		
55-68	D	64 D	64 D
39-54	E		
21-38	F		
1-20	G		

Whilst every attempt has been made to ensure the accuracy of the floorplan contained here, measurements of doors, windows, rooms and any other items are approximate and no responsibility is taken for any error, omission or mis-statement. This plan is for illustrative purposes only and should be used as such by any prospective purchaser. The services, systems and appliances shown have not been tested and no guarantee as to their operability or efficiency can be given.  
Made with Metropix ©2025



## Basingstoke Office

10B Church Street, Basingstoke, Hampshire, RG21 7QE  
01256 811730 | basingstoke@winkworth.co.uk

[winkworth.co.uk/Basingstoke](https://www.winkworth.co.uk/Basingstoke)

# Winkworth

See things differently.