



FISHERS LANE, W4  
**£365,000 LEASEHOLD**

## A ONE BEDROOM RETIREMENT APARTMENT IN EXCELLENT CONDITION

Chiswick | 020 8994 7096 | [chiswick@winkworth.co.uk](mailto:chiswick@winkworth.co.uk)

**Winkworth**

for every step...

[winkworth.co.uk](http://winkworth.co.uk)



### **DESCRIPTION:**

A first floor retirement apartment nestled within the much sought after Homecross House just moments from Chiswick High Road.

### **ACCOMMODATION**

Central Chiswick  
Retirement Apartment  
Very well presented  
One Double Bedroom  
On Site Porter  
Lift Serviced



# Homecross House

Approximate Gross Internal Area = 44.4 sq m / 477 sq ft

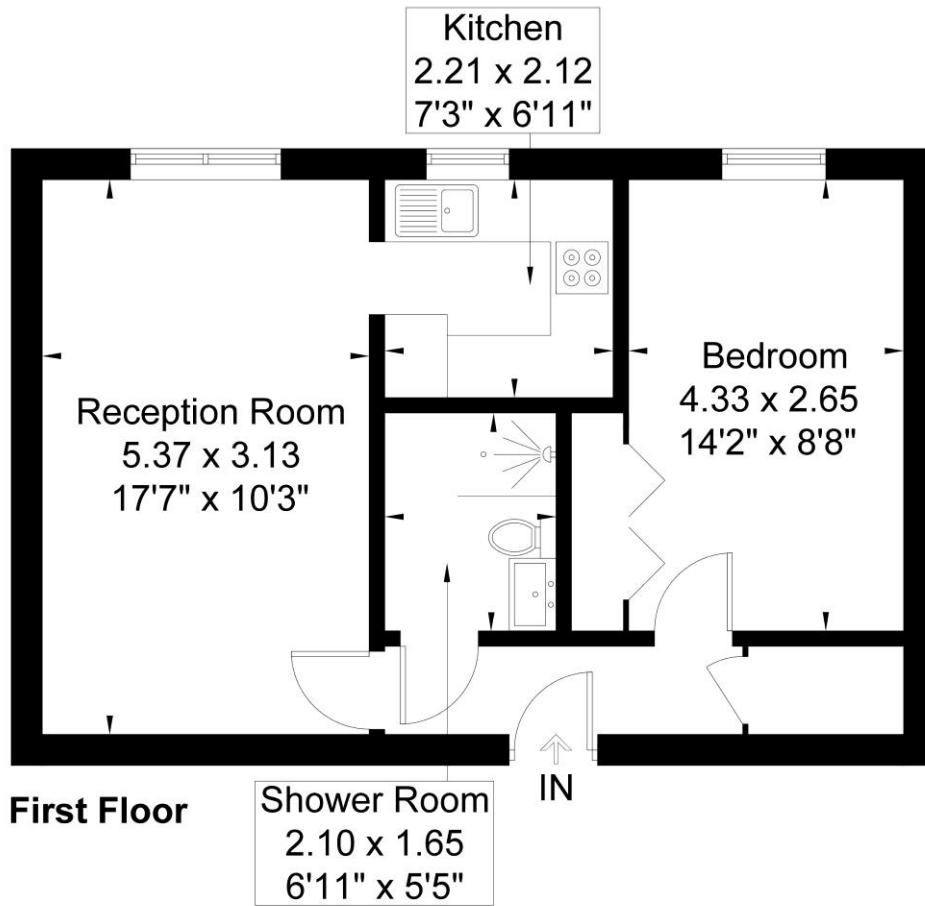

Although every attempt has been made to ensure accuracy, all measurements are approximate.  
The floorplan is for illustrative purposes only and not to scale.  
© www.perspective.co.uk

This floorplan is for illustration purposes only and is not to scale. The position and size of doors, windows, appliances and other features are approximate.

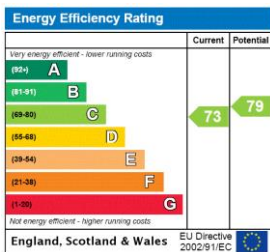

Chiswick | 020 8994 7096 | chiswick@winkworth.co.uk



for every step...

winkworth.co.uk

Winkworth wishes to inform prospective buyers and tenants that these particulars are a guide and act as information only. All our details are given in good faith and believed to be correct at the time of printing but they don't form part of an offer or contract. No Winkworth employee has authority to make or give any representation or warranty in relation to this property. All fixtures and fittings, whether fitted or not are deemed removable by the vendor unless stated otherwise and room sizes are measured between internal wall surfaces, including furnishings.